

20421 c:\20421\active\20424910\drawing_exhibt_files\44910c-ex7023.dwg PLOTTED: 2/5/2019 11:36 AM BY: ltc, Vicky

PREPARED FOR OWNER/APPLICANT:

SIGNAL LANDMARK

27271 LAS RAMBLAS, SUITE 100
MISSION VIEJO, CA 92691

CONTACT: ED MOUNTFORD

PREPARED BY:

 **Stantec**
38 TECHNOLOGY DRIVE, SUITE 100
IRVINE, CA 92618
949.923.6000 stantec.com

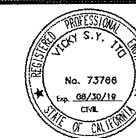

VICKY S.Y. ITO R.C.E. 73766 (EXP. 06/30/19)

WINDWARD
TENTATIVE TRACT MAP 18060
ARCHAEOLOGICAL GRADING

PLAN

DATE: 2/04/19
PROJECT NO.
2042449110
SHEET 1
OF 3

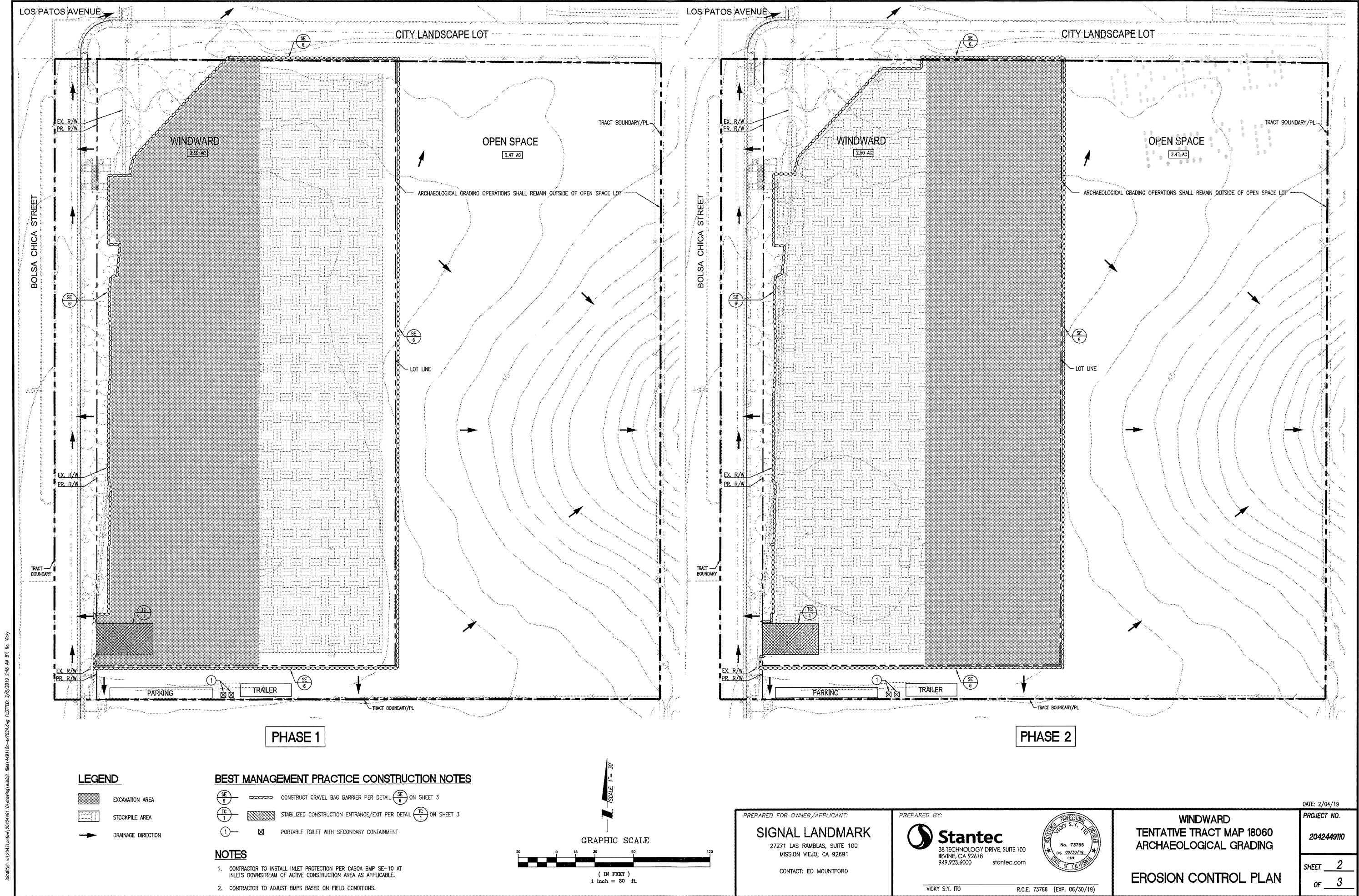

NPDES GENERAL NOTES :

1. SEDIMENT FROM AREAS DISTURBED BY CONSTRUCTION SHALL BE RETAINED ON SITE USING INDUSTRY ACCEPTED BEST MANGEMENT PRACTICES (BMPs). THESE BMPs SHALL BE INSTALLED PRIOR TO ANY CONSTRUCTION ACTIVITY SUCH AS GRADING THAT MAY CAUSE SOIL DISTURBANCE. THESE BMPs ARE TO BE MAINTAINED YEAR-ROUND OR UNTIL ALL LOOSE SEDIMENT HAS BEEN STABILIZED.
2. STOCKPILES OF SOIL SHALL BE PROPERLY CONTAINED TO MINIMIZE SEDIMENT TRANSPORT FROM THE SITE TO STREETS, DRAINAGE FACILITIES AND ADJACENT PROPERTIES VIA RUNOFF, VEHICLE TRACKING, OR WIND. STOCKPILED MATERIAL SHALL BE NO MORE THAN 8 FEET IN HEIGHT AND SHALL BE COMPLETELY COVERED WITH A SECURE IMPERMEABLE COVER AT THE END OF EACH WORK DAY. ALL STOCKPILES SHALL BE LOCATED AWAY FROM ANY STORM DRAIN INLETS AND AWAY FROM ANY STORM WATER CONVEYANCE STRUCTURES. AT NO TIME SHALL ANY RAW MATERIAL BE STAGED OR STOCKPILED ON CITY STREETS, SIDEWALKS, AND/OR GUTTERS WITHOUT A VALID OBSTRUCTION PERMIT.
3. APPROPRIATE BMPs FOR CONSTRUCTION-RELATED MATERIALS, WASTES, SPILLS OR RESIDUES SHALL BE IMPLEMENTED TO MINIMIZE TRANSPORT FROM THE SITE TO STREETS, DRAINAGE FACILITIES, AND ADJOINING PROPERTY BY WIND OR RUNOFF
4. RUNOFF FROM EQUIPMENT AND VEHICLE WASHING SHALL BE CONTAINED ON THE CONSTRUCTION SITE AND SHALL NOT BE DISCHARGED TO RECEIVING WATERS OR TO THE STORM DRAIN SYSTEM.
5. CONCRETE WASH OUT WATER SHALL BE CONTAINED IN A WATER-TIGHT DEVICE TO PREVENT CEMENT DEPOSITION ONTO THE GROUND AND RUNOFF INTO STREETS, DRAINAGE FACILITIES, AND RECEIVING WATERS.
6. ALL CONSTRUCTION CONTRACTOR AND SUBCONTRACTOR PERSONNEL ARE TO BE MADE AWARE OF THE REQUIRED BMPs AND GOOD HOUSEKEEPING MEASURES FOR THE PROJECT SITE AND ANY ASSOCIATED CONSTRUCTION STAGING AREAS.
7. AT THE END OF EACH WORK DAY, ALL CONSTRUCTION DEBRIS AND WASTE MATERIALS SHALL BE COLLECTED AND PROPERLY DISPOSED IN COVERED TRASH OR RECYCLE BINS.
8. CONSTRUCTION SITES SHALL BE MAINTAINED IN SUCH A CONDITION THAT STORMWATER DOES NOT CARRY WASTES OR POLLUTANTS OFF THE SITE. DISCHARGES OF MATERIALS OTHER THAN STORMWATER (NON-STORMWATER DISCHARGES) ARE PROHIBITED EXCEPT AS AUTHORIZED BY AN INDIVIDUAL NPDES PERMIT OR THE STATEWIDE GENERAL CONSTRUCTION STORMWATER PERMIT.
9. ALL UNPAVED CONSTRUCTION ENTRANCES AND EXITS SHALL BE PROTECTED USING AN EFFECTIVE COMBINATION OF TRACKING CONTROL BMPs TO MINIMIZE AND/OR ELIMINATE OFF-SITE TRACKING OF SEDIMENT. THESE BMPs SHALL BE MAINTAINED AND INSPECTED DAILY.
10. ALL TEMPORARY PORTABLE RESTROOMS MUST HAVE A CATCHMENT PAN AND MUST BE LOCATED AT LEAST 50 FEET AWAY FROM ANY STORM DRAIN INLETS.
11. POLLUTANTS ARE ANY SUBSTANCES INTRODUCED INTO THE ENVIRONMENT THAT ADVERSELY AFFECTS THE USEFULNESS OF A RESOURCE. POTENTIAL POLLUTANTS INCLUDE, BUT ARE NOT LIMITED TO: SEDIMENT; SOLID OR LIQUID CHEMICALS SUCH AS: PAINTS, STAINS, SEALANTS, SOLVENTS, DETERGENTS, GLUES, LIME, PESTICIDE, HERBICIDE, FERTILIZERS, WOOD PRESERVATIVES AND ASBESTOS FIBERS, PAINT FLAKES OR STUCCO FRAGMENTS; FUELS, OILS, LUBRICANTS, AND HYDRAULIC, RADIATOR OR BATTERY FLUIDS; CONCRETE, AND RELATED CUTTING OR CURING RESIDUES; FLOATABLE WASTES; WASTES FROM ENGINE/EQUIPMENT STEAM CLEANING OR CHEMICAL DEGREASING; WASTES FROM STREET CLEANING; AND SUPER-CHLORINATED POTABLE WATER FROM LINE FLUSHINGS AND TESTING.
12. DURING CONSTRUCTION, DISPOSAL OF SUCH MATERIALS SHOULD OCCUR IN A SPECIFIED AND CONTROLLED MANNER. A DESIGNATED TEMPORARY AREA ON-SITE SHALL BE PHYSICALLY SEPARATED FROM POTENTIAL STORMWATER RUNOFF, WITH ULTIMATE DISPOSAL IN ACCORDANCE WITH LOCAL, STATE AND FEDERAL REQUIREMENTS.
13. DISCHARGING CONTAMINATED GROUNDWATER, PRODUCED BY DEWATERING GROUNDWATER THAT HAS INFILTRATED INTO THE CONSTRUCTION SITE IS PROHIBITED. DISCHARGING OF CONTAMINATED SOILS VIA SURFACE EROSION IS ALSO PROHIBITED. DISCHARGING NON-CONTAMINATED GROUNDWATER PRODUCED BY DEWATERING ACTIVITIES REQUIRES A NATIONAL POLLUTANTS DISCHARGE ELIMINATION SYSTEM (NPDES) PERMIT FROM THE RESPECTIVE STATE REGIONAL WATER QUALITY CONTROL BOARD.
14. DISCHARGES OF STORM WATER FROM CONSTRUCTION SITES SHALL NOT BE LADEN WITH SEDIMENT. ALL STORM WATER DISCHARGES MUST BE RELATIVELY FREE OF SEDIMENT.

NOTICE: ALL CONTRACTORS AND CONSTRUCTION PERSONNEL SHALL MEET THE REGULATORY CONSTRUCTION REQUIREMENTS ON THE PROJECT SITE IN COMPLIANCE WITH THE CITY'S GRADING AND EXCAVATION CODE (MUNI CODE 17.05).

NOTES :

1. IN THE CASE OF EMERGENCY, CALL _____ (TBD) _____ AT WORK PHONE # (XXX) XXX-XXXX OR CELL PHONE # (XXX) XXX-XXXX.
2. SEDIMENT FROM AREAS DISTURBED BY CONSTRUCTION SHALL BE RETAINED ON-SITE USING STRUCTURAL CONTROLS TO THE MAXIMUM EXTENT PRACTICABLE.
3. ALL CONSTRUCTION CONTRACTOR AND SUBCONTRACTOR PERSONNEL ARE TO BE MADE AWARE OF THE REQUIRED BEST MANAGEMENT PRACTICES AND GOOD HOUSEKEEPING MEASURES FOR THE PROJECT SITE AND ANY ASSOCIATED CONSTRUCTION STAGING AREAS.
4. GRADED AREAS ON THE PERMITTED AREA PERIMETER MUST DRAIN AWAY FROM THE FACE OF SLOPES AT THE CONCLUSION OF EACH WORKING DAY. DRAINAGE IS TO BE DIRECTED TOWARD DESILTING FACILITIES.
5. THE PERMITTEE AND CONTRACTOR SHALL BE RESPONSIBLE AND SHALL TAKE NECESSARY PRECAUTIONS TO PREVENT PUBLIC TRESPASS ONTO AREAS WHERE IMPOUNDED WATER CREATES A HAZARDOUS CONDITION.
6. THE PERMITTEE AND CONTRACTOR SHALL INSPECT THE EROSION CONTROL WORK AND INSURE THAT THE WORK IS IN ACCORDANCE WITH THE APPROVED PLANS.
7. THE PERMITTEE SHALL NOTIFY ALL GENERAL CONTRACTORS, SUBCONTRACTORS, MATERIAL SUPPLIERS, LESSEES, AND PROPERTY OWNERS: THAT DUMPING OF CHEMICALS INTO THE STORM DRAIN SYSTEM OR THE WATERSHED IS PROHIBITED.
8. EQUIPMENT AND WORKERS FOR EMERGENCY WORK SHALL BE MADE AVAILABLE AT ALL TIMES DURING THE RAINY SEASON. NECESSARY MATERIALS SHALL BE AVAILABLE ON-SITE AND STOCKPILED AT CONVENIENT LOCATIONS TO FACILITATE RAPID CONSTRUCTION OF TEMPORARY DEVICES WHEN RAIN IS IMMINENT.
9. ALL REMOVABLE EROSION PROTECTIVE DEVICES SHALL BE IN PLACE AT THE END OF EACH WORKING DAY WHEN THE 5-DAY RAIN PROBABILITY FORECAST EXCEEDS 40%.
10. APPROPRIATE BMPs FOR CONSTRUCTION-RELATED MATERIALS, WASTES, SPILS OR RESIDUES SHALL BE IMPLEMENTED AND RETAINED ON-SITE TO MINIMIZE TRANSPORT FROM THE SITE TO STREETS, DRAINAGE FACILITIES, OR ADJOINING PROPERTY BY WIND OR RUNOFF.

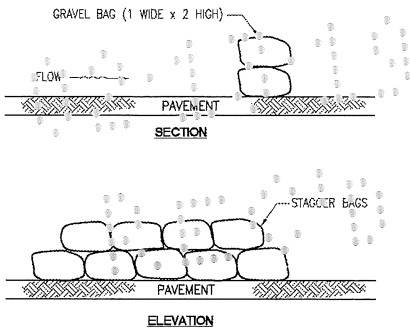

GRAVEL BAGS BARRIER SE 6
NOT TO SCALE

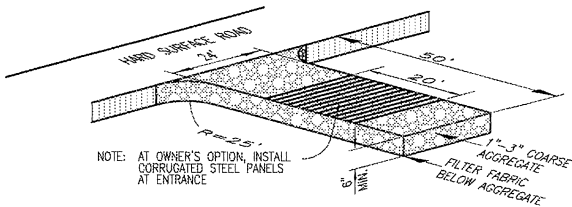

- NOTES:
1. THE ENTRANCE SHALL BE MAINTAINED IN A CONDITION THAT WILL PREVENT TRACKING OR FLOWING OF SEDIMENT ONTO PUBLIC RIGHT-OF-WAYS. THIS MAY REQUIRE TOP DRESSING, REPAIR AND/OR CLEANOUT OF ANY MEASURES USED TO TRAP SEDIMENT.
 2. WHEN NECESSARY, WHEELS SHALL BE CLEANED PRIOR TO ENTRANCE ONTO PUBLIC RIGHT-OF-WAY.
 3. WHEN WASHING IS REQUIRED, IT SHALL BE DONE ON AN AREA STABILIZED WITH CRUSHED STONE THAT DRAINS INTO AN APPROVED SEDIMENT TRAP OR SEDIMENT BASIN.

STABILIZED CONSTRUCTION ENTRANCE/EXIT TC 1
NOT TO SCALE

D:\drawing - 1\2042\active\2042449110.dwg (drawing) embul_5.mn 149110c--x7025.dwg PLOTTED: 2/4/2019 11:08 AM BY: DLS Vicky

PREPARED FOR OWNER/APPLICANT:

SIGNAL LANDMARK

27271 LAS RAMBLAS, SUITE 100
MISSION VIEJO, CA 92691

CONTACT: ED MOUNTFORD

PREPARED BY:



Stantec
38 TECHNOLOGY DRIVE, SUITE 100
IRVINE, CA 92618
949.923.6000 stantec.com



VICKY S.Y. ITO

R.C.E. 73766 (EXP. 06/30/19)

**WINDWARD
TENTATIVE TRACT MAP 18060
ARCHAEOLOGICAL GRADING**

EROSION CONTROL DETAILS

DATE: 2/04/19

PROJECT NO.

2042449110

SHEET

3

OF

3