

SCOPE OF WORK:

- 1
- INCREASE HEIGHT OF EXISTING 3'-6" TALL WALL TO ADDITIONAL 5" TALL STUCCO WALL AND 20" TALL GLASS RAILING FOR HOMEOWNER PRIVACY CONCERN

HOMEOWNER INFORMATION

HOMEOWNER INFORMATION:
NAME: LISA BUCKINGHAM
ADDRESS: 618 HUNTINGTON STREET
HUNTINGTON BEACH, CA
PHONE #: 714-924-5673



REVISIONS

Drawn By:
HDZ LANDSCAPE
1888 W. 6TH STREET SUITE F
CORONA, CA 92882
(714)808-3414
Description:
SITE PLAN

618 HUNTINGTON STREET
HUNTINGTON BEACH

SCALE: 1/4" = 1'-0"
DATE: 1/4/2024
PROJECT #:2024-003
SHEET #:

S-1

1 SECTION A-A
FRONT OF HOUSE - ORIGINAL
SCALE: 1/4" = 1'-0"

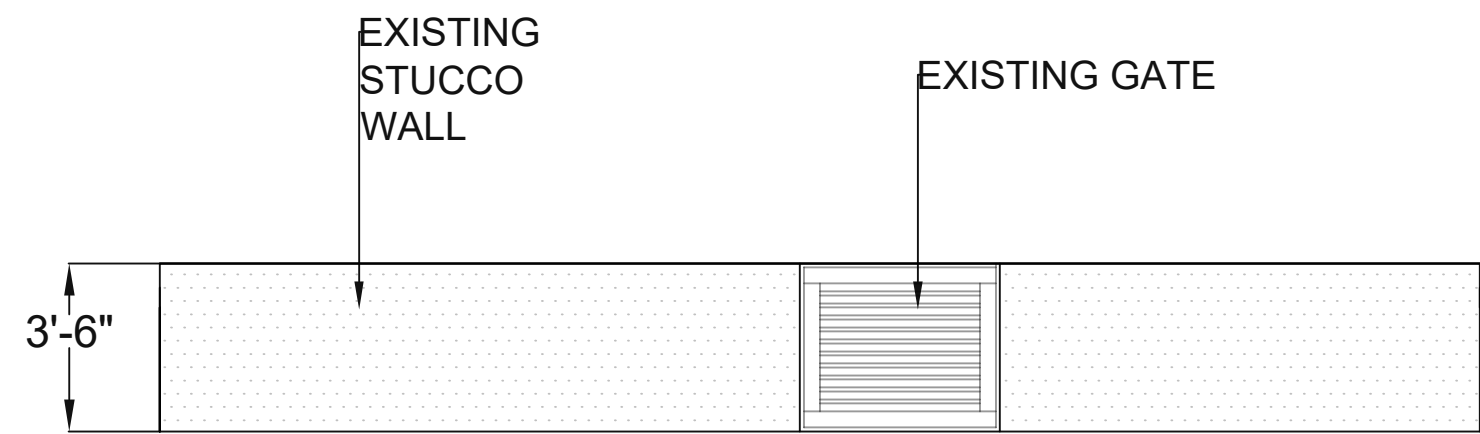

2 SECTION A-A
FRONT OF HOUSE - MODIFIED
SCALE: 1/4" = 1'-0"

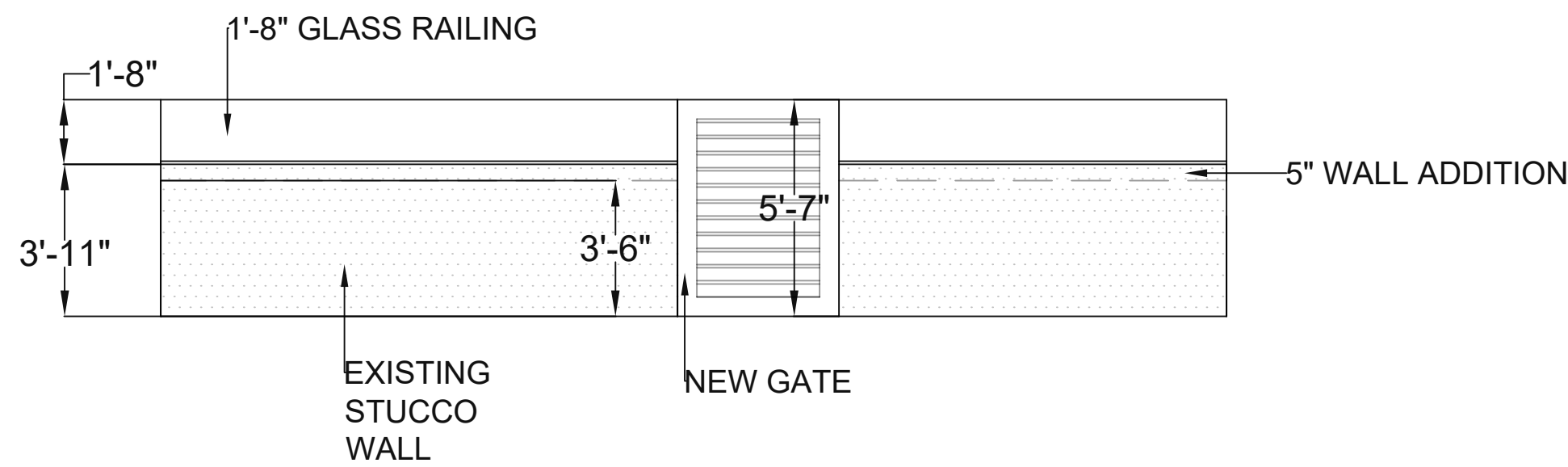

3 SECTION B-B
SIDE OF HOUSE - ORIGINAL
SCALE: 1/4" = 1'-0"

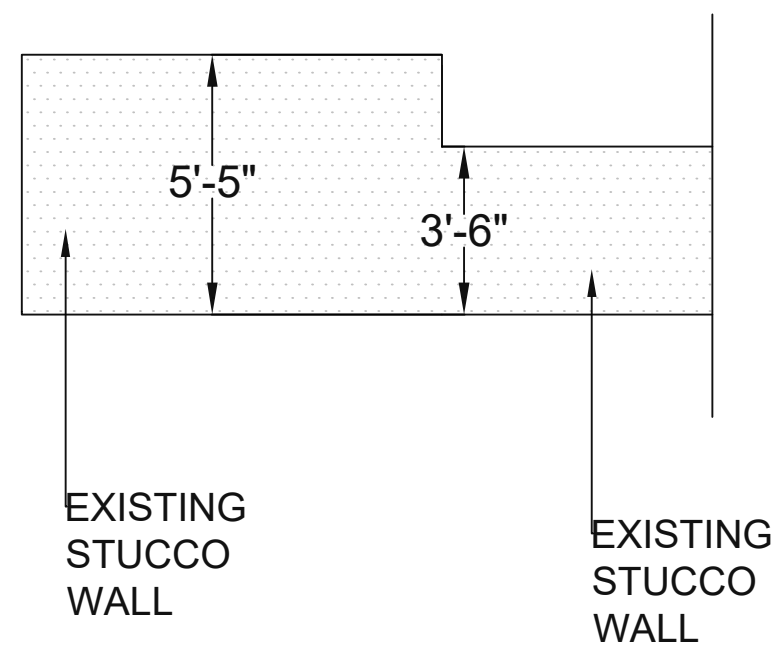

4 SECTION B-B
SIDE OF HOUSE - MODIFIED
SCALE: 1/4" = 1'-0"

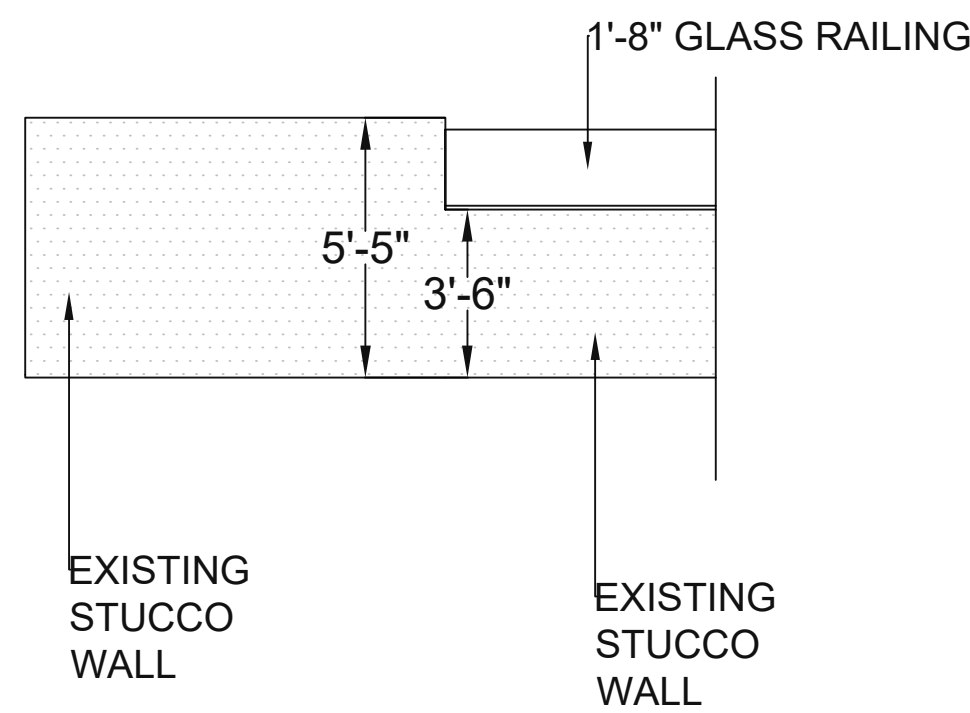

5 SECTION C-C
SIDE OF HOUSE - ORIGINAL
SCALE: 1/4" = 1'-0"

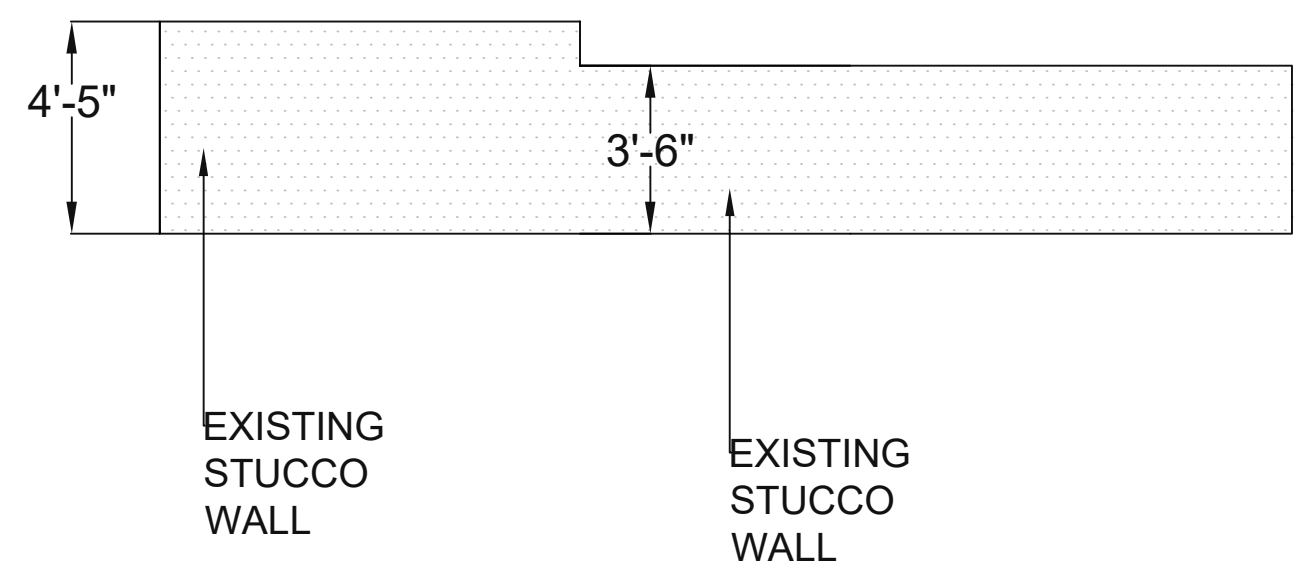

6 SECTION C-C
SIDE OF HOUSE - MODIFIED
SCALE: 1/4" = 1'-0"

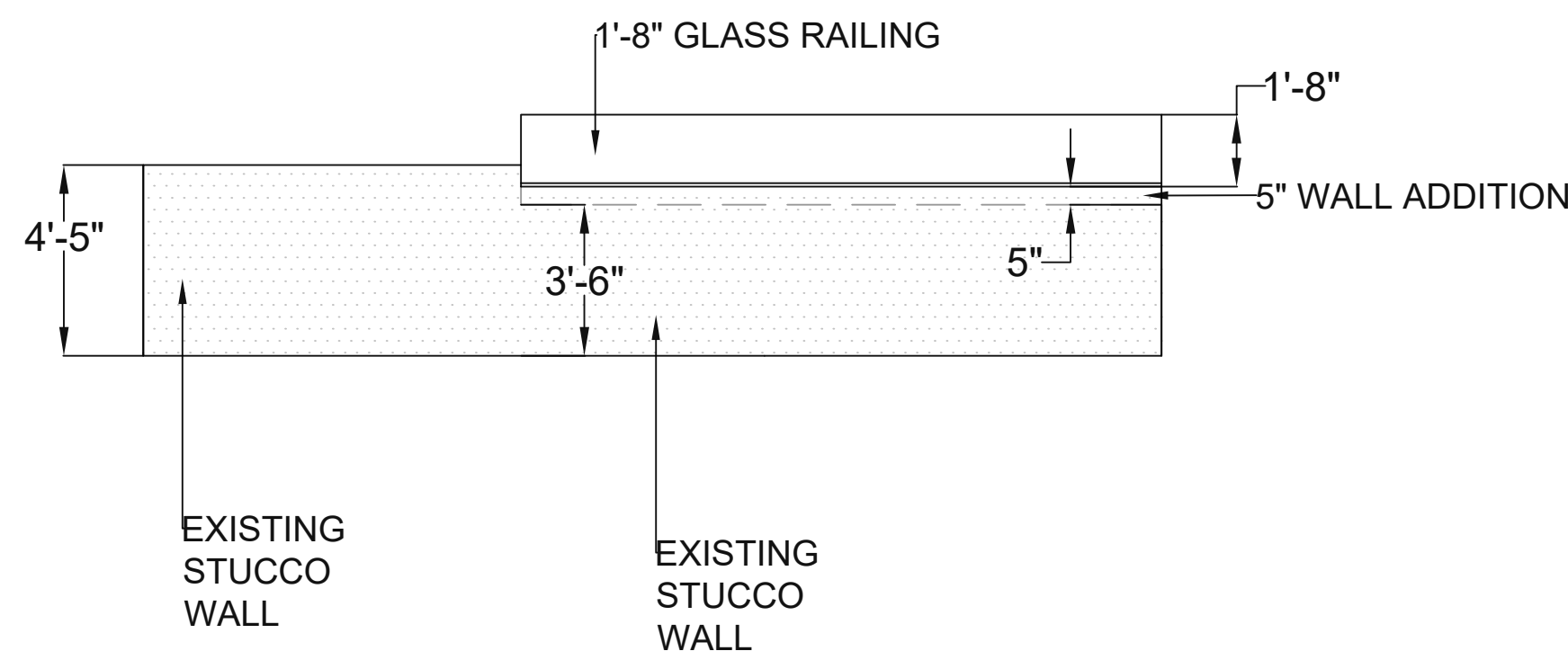

REVISIONS

Drawn By:
HDZ LANDSCAPE
1888 W. 6TH STREET SUITE F
CORONA, CA 92882
(714)808-3414
Description:
SECTION VIEW

618 HUNTINGTON STREET
HUNTINGTON BEACH

SCALE: 1/4" = 1'-0"
DATE: 1/4/2024
PROJECT #:2024-003
SHEET #:

S-2

[illegible][illegible]

L PX-2019-005

1. IF EXISTING LAWN IS REPLACED, REPLACE WITH 'HYBRID BURMUDA' SOD TIFGREEN, FROM SOUTHLAND FARMS, (800)488-3585.
2. ALL SHRUB PLANTING AREAS SHALL RECEIVE A 2" THICK LAYER OF MULCH OR SHREDDED WALK-ON-BARK. COLOR OF BARK SHALL BE BROWN WITH A DIAMETER OF $\frac{1}{2}$ "- $\frac{3}{4}$ ".
3. ALL SOIL SHALL BE ROTOTILLED TO A DEPTH OF 6" AND AMENDED PER 1000 SQ. FT. AS FOLLOWS:
 - a. IN BULK: 3 CUBIC YARDS KELLOGG 'NITROMULCH SOIL AMENDMENT' OR EQUAL
 - b. IN BAGS: 3 CUBIC YARDS KELLOGG 'GROMULCH' OR EQUAL
 - c. COMMERCIAL GRANULAR FERTILIZER PER MANUFACTURER'S RECOMMENDATIONS
4. ALL SHRUBS SHALL BE BACKFILLED PER STANDARD PLAN 714 'TREE PLANTING & STAKING', NOTE #4, THIS SHEET.
5. THE LANDSCAPE CONTRACTOR SHALL PROVIDE A 60 DAY MAINTENANCE PERIOD AND GUARANTEE TREES FOR 1 YEAR. ALL PLANT MATERIAL SHALL BE REPLACED BY CONTRACTOR DURING THIS PERIOD IF DEAD OR DYING.
6. LANDSCAPE INSPECTIONS ARE REQUIRED. NOTIFY THE CITY OF HUNTINGTON BEACH BUILDING DEPARTMENT 48 HOURS IN ADVANCE OF ANY WORK BEING DONE. CALL 714-536-5241.
7. INSTALLATION OF REQUIRED LANDSCAPE & IRRIGATION SYSTEMS SHALL BE COMPLETED PRIOR TO FINAL INSPECTION: WITHIN 12 MONTHS.
8. OWNER SHALL DRAIN ALL WATER FROM LOT PER CITY OF HUNTINGTON BEACH REGULATIONS.
9. LINEAR ROOT BARRIERS SHALL BE INSTALLED PER STANDARD PLAN 718 THIS SHEET.
10. PARKWAY TREES, LOCATED IN THE PLANTER AREA BETWEEN THE STREET CURB AND THE CITY SIDEWALK, REQUIRE AN ENOROCROACHMENT PERMIT. OBTAIN THIS PERMIT AT THE PUBLIC WORKS ENGINEERING COUNTER, CITY HALL, 2000 MAIN STREET.

DIGALERT
DIAL TOLL FREE
811
AT LEAST TWO DAYS
BEFORE YOU DIG
UNDERGROUND SERVICE ALERT OF SOUTHERN CALIFORNIA

REVISIONS	
DATE	△

CT:
HARRY MONCK
714-390-6829

PROJECT:
2 SINGLE-FAMILY RESIDENCES
18 & 620 HUNTINGTON STREET
HUNTINGTON BEACH, CALIF.



SHEET TITLE:
LANDSCAPE PLAN

RICHARD M. GARCIA
LANDSCAPE ARCHITECTURE
1918 KEMPER AVE., SANTA ANA CA 92705
PHONE/ FAX : 714-538-6000 EMAIL: rmglanarch@sbcglobal.net
CALIFORNIA LANDSCAPE ARCHITECT NO. 1873

DRAWN	R. GARCIA
DATE	4-14-19
SCALE	1" = 10' - 0"
JOB NO.	
SHEET	L-1
1	OF 1

PLANNING DEPT # LPX 2019-005 BUILDING PERMIT # C2018-005876 (618 Huntington St.) C2018-005874 (620 Huntington St.)