

PROFESSIONAL SERVICES CONTRACT BETWEEN
THE CITY OF HUNTINGTON BEACH AND
RJM DESIGN GROUP, INC.
FOR
ON-CALL ARCHITECTURAL ENGINEERING, LANDSCAPE
ARCHITECTURAL ENGINEERING AND PROFESSIONAL
CONSULTING SERVICES

THIS AGREEMENT ("Agreement") is made and entered into by and between the City of Huntington Beach, a municipal corporation of the State of California, hereinafter referred to as "CITY," and RJM DESIGN GROUP, INC., a California Corporation hereinafter referred to as "CONSULTANT."

WHEREAS, CITY desires to engage the services of a consultant to provide on-call architectural engineering, landscape architectural engineering and professional consulting services; and

Pursuant to documentation on file in the office of the City Clerk, the provisions of the Huntington Beach Municipal Code, Chapter 3.03, relating to procurement of professional service contracts have been complied with; and

CONSULTANT has been selected to perform these services,

NOW, THEREFORE, it is agreed by CITY and CONSULTANT as follows:

1. SCOPE OF SERVICES

CONSULTANT shall provide all services as described in **Exhibit "A,"** which is attached hereto and incorporated into this Agreement by this reference. These services shall sometimes hereinafter be referred to as the "PROJECT."

CONSULTANT hereby designates Zachary Mueting who shall represent it and be its sole contact and agent in all consultations with CITY during the performance of this Agreement.

2. CITY STAFF ASSISTANCE

CITY shall assign a staff coordinator to work directly with CONSULTANT in the performance of this Agreement.

3. TERM; TIME OF PERFORMANCE

Time is of the essence of this Agreement. The services of CONSULTANT are to commence on _____, 20____ (the "Commencement Date"). This Agreement shall automatically terminate three (3) years from the Commencement Date, unless extended or sooner terminated as provided herein. All tasks specified in **Exhibit "A"** shall be completed no later than three (3) years from the Commencement Date. The time for performance of the tasks identified in **Exhibit "A"** are generally to be shown in **Exhibit "A."** This schedule may be amended to benefit the PROJECT if mutually agreed to in writing by CITY and CONSULTANT.

In the event the Commencement Date precedes the Effective Date, CONSULTANT shall be bound by all terms and conditions as provided herein.

4. COMPENSATION

In consideration of the performance of the services described herein, CITY agrees to pay CONSULTANT on a time and materials basis at the rates specified in **Exhibit "B,"** which is attached hereto and incorporated by reference into this Agreement, a fee, including all costs and expenses, not to exceed One Million Dollars (\$1,000,000.00).

5. EXTRA WORK

In the event CITY requires additional services not included in **Exhibit "A"** or changes in the scope of services described in **Exhibit "A,"** CONSULTANT will undertake such work only after receiving written authorization from CITY. Additional compensation for such extra work shall be allowed only if the prior written approval of CITY is obtained.

6. METHOD OF PAYMENT

CONSULTANT shall be paid pursuant to the terms of **Exhibit "B."**

7. DISPOSITION OF PLANS, ESTIMATES AND OTHER DOCUMENTS

CONSULTANT agrees that title to all materials prepared hereunder, including, without limitation, all original drawings, designs, reports, both field and office notices, calculations, computer code, language, data or programs, maps, memoranda, letters and other documents, shall belong to CITY, and CONSULTANT shall turn these materials over to CITY upon expiration or termination of this Agreement or upon PROJECT completion, whichever shall occur first. These materials may be used by CITY as it sees fit, provided that any such use not within the purposes intended, by the Agreement shall be at City's sole risk.

8. HOLD HARMLESS

A. CONSULTANT hereby agrees to protect, defend, indemnify and hold harmless CITY, its officers, elected or appointed officials, employees, agents and volunteers from and against any and all claims, damages, losses, expenses, judgments, demands and defense costs (including, without limitation, costs and fees of litigation of every nature or liability of any kind or nature) arising out of or in connection with CONSULTANT's (or CONSULTANT's subcontractors, if any) negligent (or alleged negligent) performance of this Agreement or its failure to comply with any of its obligations contained in this Agreement by CONSULTANT, its officers, agents or employees except such loss or damage which was caused by the sole negligence or willful misconduct of CITY. CONSULTANT will conduct all defense at its sole cost and expense and CITY shall approve selection of CONSULTANT's counsel. This indemnity shall apply to all claims and liability regardless of whether any insurance policies are applicable. The policy limits do not act as limitation upon the amount of indemnification to be provided by CONSULTANT.

B. To the extent that CONSULTANT performs “Design Professional Services” within the meaning of Civil Code Section 2782.8, then the following Hold Harmless provision applies in place of subsection A above:

“CONSULTANT hereby agrees to protect, defend, indemnify and hold harmless CITY and its officers, elected or appointed officials, employees, agents and volunteers, from and against any and all claims, damages, losses, expenses, demands and defense costs (including, without limitation, costs and fees of litigation of every nature or liability of any kind or nature) to the extent that the claims against CONSULTANT arise out of, pertain to, or relate to the negligence, recklessness, or willful misconduct of CONSULTANT. In no event shall the cost to defend charged to CONSULTANT exceed CONSULTANT’s proportionate percentage of fault. However, notwithstanding the previous sentence, in the event one or more other defendants to the claims and/or litigation is unable to pay its share of defense costs due to bankruptcy or dissolution of the business, CONSULTANT shall meet and confer with CITY and other defendants regarding unpaid defense costs. The duty to indemnify, including the duty and the cost to defend, is limited as provided in California Civil Code Section 2782.8.

C. Regardless of whether subparagraph A or B applies, CITY shall be reimbursed by CONSULTANT for all costs and attorney’s fees incurred by CITY in enforcing this obligation. This indemnity shall apply to all claims and liability regardless of whether any insurance policies are applicable. The policy limits do not act as a limitation upon the amount of indemnification to be provided by CONSULTANT.

9. PROFESSIONAL LIABILITY INSURANCE

CONSULTANT shall obtain and furnish to CITY a professional liability insurance policy covering the work performed by it hereunder. This policy shall provide coverage for CONSULTANT’s professional liability in an amount not less than One Million Dollars

(\$1,000,000.00) per occurrence and in the aggregate. The above-mentioned insurance shall not contain a self-insured retention without the express written consent of CITY; however an insurance policy "deductible" of Ten Thousand Dollars (\$10,000.00) or less is permitted. A claims-made policy shall be acceptable if the policy further provides that:

- A. The policy retroactive date coincides with or precedes the initiation of the scope of work (including subsequent policies purchased as renewals or replacements).
- B. CONSULTANT shall notify CITY of circumstances or incidents that might give rise to future claims.

CONSULTANT will make every effort to maintain similar insurance during the required extended period of coverage following PROJECT completion. If insurance is terminated for any reason, CONSULTANT agrees to purchase an extended reporting provision of at least two (2) years to report claims arising from work performed in connection with this Agreement.

If CONSULTANT fails or refuses to produce or maintain the insurance required by this section or fails or refuses to furnish the CITY with required proof that insurance has been procured and is in force and paid for, the CITY shall have the right, at the CITY's election, to forthwith terminate this Agreement. Such termination shall not effect Consultant's right to be paid for its time and materials expended prior to notification of termination. CONSULTANT waives the right to receive compensation and agrees to indemnify the CITY for any work performed prior to approval of insurance by the CITY.

10. CERTIFICATE OF INSURANCE

Prior to commencing performance of the work hereunder, CONSULTANT shall furnish to CITY a certificate of insurance subject to approval of the City Attorney evidencing the foregoing insurance coverage as required by this Agreement; the certificate shall:

- A. provide the name and policy number of each carrier and policy;
- B. state that the policy is currently in force; and
- C. shall promise that such policy shall not be suspended, voided or canceled by either party, reduced in coverage or in limits except after thirty (30) days' prior written notice; however, ten (10) days' prior written notice in the event of cancellation for nonpayment of premium.

CONSULTANT shall maintain the foregoing insurance coverage in force until the work under this Agreement is fully completed and accepted by CITY.

The requirement for carrying the foregoing insurance coverage shall not derogate from CONSULTANT's defense, hold harmless and indemnification obligations as set forth in this Agreement. CITY or its representative shall at all times have the right to demand the original or a copy of the policy of insurance. CONSULTANT shall pay, in a prompt and timely manner, the premiums on the insurance hereinabove required.

11. INDEPENDENT CONTRACTOR

CONSULTANT is, and shall be, acting at all times in the performance of this Agreement as an independent contractor herein and not as an employee of CITY. CONSULTANT shall secure at its own cost and expense, and be responsible for any and all payment of all taxes, social security, state disability insurance compensation, unemployment compensation and other payroll deductions for CONSULTANT and its officers, agents and employees and all business licenses, if any, in connection with the PROJECT and/or the services to be performed hereunder.

12. TERMINATION OF AGREEMENT

All work required hereunder shall be performed in a good and workmanlike manner. CITY may terminate CONSULTANT's services hereunder at any time with or without cause, and whether or not the PROJECT is fully complete. Any termination of this Agreement by CITY shall

be made in writing, notice of which shall be delivered to CONSULTANT as provided herein. In the event of termination, all finished and unfinished documents, exhibits, report, and evidence shall, at the option of CITY, become its property and shall be promptly delivered to it by CONSULTANT.

13. ASSIGNMENT AND DELEGATION

This Agreement is a personal service contract and the work hereunder shall not be assigned, delegated or subcontracted by CONSULTANT to any other person or entity without the prior express written consent of CITY. If an assignment, delegation or subcontract is approved, all approved assignees, delegates and subconsultants must satisfy the insurance requirements as set forth in Sections 9 and 10 hereinabove.

14. COPYRIGHTS/PATENTS

CITY shall own all rights to any patent or copyright on any work, item or material produced as a result of this Agreement.

15. CITY EMPLOYEES AND OFFICIALS

CONSULTANT shall employ no CITY official nor any regular CITY employee in the work performed pursuant to this Agreement. No officer or employee of CITY shall have any financial interest in this Agreement in violation of the applicable provisions of the California Government Code.

16. NOTICES

Any notices, certificates, or other communications hereunder shall be given either by personal delivery to CONSULTANT's agent (as designated in Section 1 hereinabove) or to CITY as the situation shall warrant, or by enclosing the same in a sealed envelope, postage prepaid, and depositing the same in the United States Postal Service, to the addresses specified below. CITY and CONSULTANT may designate different addresses to which subsequent notices, certificates or

other communications will be sent by notifying the other party via personal delivery, a reputable overnight carrier or U. S. certified mail-return receipt requested:

TO CITY:

City of Huntington Beach
ATTN: Dir. Comm. & Library Services
2000 Main Street
Huntington Beach, CA 92648

TO CONSULTANT:

RRM DESIGN GROUP
ATTN: Mike Sherrod
32332 Camino Capistrano, Suite 205
San Juan Capistrano, CA 93401

17. CONSENT

When CITY's consent/approval is required under this Agreement, its consent/approval for one transaction or event shall not be deemed to be a consent/approval to any subsequent occurrence of the same or any other transaction or event.

18. MODIFICATION

No waiver or modification of any language in this Agreement shall be valid unless in writing and duly executed by both parties.

19. SECTION HEADINGS

The titles, captions, section, paragraph and subject headings, and descriptive phrases at the beginning of the various sections in this Agreement are merely descriptive and are included solely for convenience of reference only and are not representative of matters included or excluded from such provisions, and do not interpret, define, limit or describe, or construe the intent of the parties or affect the construction or interpretation of any provision of this Agreement.

20. INTERPRETATION OF THIS AGREEMENT

The language of all parts of this Agreement shall in all cases be construed as a whole, according to its fair meaning, and not strictly for or against any of the parties. If any provision of this Agreement is held by an arbitrator or court of competent jurisdiction to be unenforceable, void, illegal or invalid, such holding shall not invalidate or affect the remaining

covenants and provisions of this Agreement. No covenant or provision shall be deemed dependent upon any other unless so expressly provided here. As used in this Agreement, the masculine or neuter gender and singular or plural number shall be deemed to include the other whenever the context so indicates or requires. Nothing contained herein shall be construed so as to require the commission of any act contrary to law, and wherever there is any conflict between any provision contained herein and any present or future statute, law, ordinance or regulation contrary to which the parties have no right to contract, then the latter shall prevail, and the provision of this Agreement which is hereby affected shall be curtailed and limited only to the extent necessary to bring it within the requirements of the law.

21. DUPLICATE ORIGINAL

The original of this Agreement and one or more copies hereto have been prepared and signed in counterparts as duplicate originals, each of which so executed shall, irrespective of the date of its execution and delivery, be deemed an original. Each duplicate original shall be deemed an original instrument as against any party who has signed it.

22. IMMIGRATION

CONSULTANT shall be responsible for full compliance with the immigration and naturalization laws of the United States and shall, in particular, comply with the provisions of the United States Code regarding employment verification.

23. LEGAL SERVICES SUBCONTRACTING PROHIBITED

CONSULTANT and CITY agree that CITY is not liable for payment of any subcontractor work involving legal services, and that such legal services are expressly outside the scope of services contemplated hereunder. CONSULTANT understands that pursuant to *Huntington Beach City Charter* Section 309, the City Attorney is the exclusive legal counsel for

CITY; and CITY shall not be liable for payment of any legal services expenses incurred by CONSULTANT.

24. ATTORNEY'S FEES

In the event suit is brought by either party to construe, interpret and/or enforce the terms and/or provisions of this Agreement or to secure the performance hereof, each party shall bear its own attorney's fees, such that the prevailing party shall not be entitled to recover its attorney's fees from the nonprevailing party.

25. SURVIVAL

Terms and conditions of this Agreement, which by their sense and context survive the expiration or termination of this Agreement, shall so survive.

26. GOVERNING LAW

This Agreement shall be governed and construed in accordance with the laws of the State of California.

27. SIGNATORIES

Each undersigned represents and warrants that its signature hereinbelow has the power, authority and right to bind their respective parties to each of the terms of this Agreement, and shall indemnify CITY fully for any injuries or damages to CITY in the event that such authority or power is not, in fact, held by the signatory or is withdrawn.

28. ENTIRETY

The parties acknowledge and agree that they are entering into this Agreement freely and voluntarily following extensive arm's length negotiation, and that each has had the opportunity to consult with legal counsel prior to executing this Agreement. The parties also acknowledge and agree that no representations, inducements, promises, agreements or warranties, oral or otherwise, have been made by that party or anyone acting on that party's behalf, which are not embodied in this

Agreement, and that that party has not executed this Agreement in reliance on any representation, inducement, promise, agreement, warranty, fact or circumstance not expressly set forth in this Agreement. This Agreement, and the attached exhibits, contain the entire agreement between the parties respecting the subject matter of this Agreement, and supersede all prior understandings and agreements whether oral or in writing between the parties respecting the subject matter hereof.

29. EFFECTIVE DATE

This Agreement shall be effective on the date of its approval by the City Council.

This Agreement shall expire when terminated as provided herein.

IN WITNESS WHEREOF, the parties hereto have caused this Agreement to be executed by and through their authorized officers.

CONSULTANT,
RJM DESIGN GROUP, INC.

By: _____



print name

ITS: (circle one) Chairman/President/Vice President

AND

By: _____



print name

ITS: (circle one) Secretary/Chief Financial Officer/Asst.
Secretary - Treasurer

CITY OF HUNTINGTON BEACH, a
municipal corporation of the State of
California

Mayor

City Clerk

INITIATED AND APPROVED:

Director of Community & Library Services

REVIEWED AND APPROVED:

City Manager

APPROVED AS TO FORM:



City Attorney

Agreement, and that that party has not executed this Agreement in reliance on any representation, inducement, promise, agreement, warranty, fact or circumstance not expressly set forth in this Agreement. This Agreement, and the attached exhibits, contain the entire agreement between the parties respecting the subject matter of this Agreement, and supersede all prior understandings and agreements whether oral or in writing between the parties respecting the subject matter hereof.

29. EFFECTIVE DATE

This Agreement shall be effective on the date of its approval by the City Council.

This Agreement shall expire when terminated as provided herein.

IN WITNESS WHEREOF, the parties hereto have caused this Agreement to be executed by and through their authorized officers.

CONSULTANT,
RJM DESIGN GROUP, INC.

CITY OF HUNTINGTON BEACH, a
municipal corporation of the State of
California

By: _____

print name

ITS: (circle one) Chairman/President/Vice President

Mayor

AND

City Clerk

By: _____

print name

ITS: (circle one) Secretary/Chief Financial Officer/Asst.
Secretary - Treasurer

INITIATED AND APPROVED:



Director of Community & Library Services

REVIEWED AND APPROVED:

City Manager

APPROVED AS TO FORM:



City Attorney

EXHIBIT "A"

A. STATEMENT OF WORK: (Narrative of work to be performed)

Consultant to provide on-call architectural engineering, landscape architectural engineering and professional consulting services

B. CONSULTANT'S DUTIES AND RESPONSIBILITIES:

SEE ATTACHED EXHIBIT A

C. CITY'S DUTIES AND RESPONSIBILITIES:

D. WORK PROGRAM/PROJECT SCHEDULE:



RJMDESI-01

MCCOWANA

CERTIFICATE OF LIABILITY INSURANCE

DATE (MM/DD/YYYY)

9/11/2024

THIS CERTIFICATE IS ISSUED AS A MATTER OF INFORMATION ONLY AND CONFERS NO RIGHTS UPON THE CERTIFICATE HOLDER. THIS CERTIFICATE DOES NOT AFFIRMATIVELY OR NEGATIVELY AMEND, EXTEND OR ALTER THE COVERAGE AFFORDED BY THE POLICIES BELOW. THIS CERTIFICATE OF INSURANCE DOES NOT CONSTITUTE A CONTRACT BETWEEN THE ISSUING INSURER(S), AUTHORIZED REPRESENTATIVE OR PRODUCER, AND THE CERTIFICATE HOLDER.

IMPORTANT: If the certificate holder is an ADDITIONAL INSURED, the policy(ies) must have ADDITIONAL INSURED provisions or be endorsed. If SUBROGATION IS WAIVED, subject to the terms and conditions of the policy, certain policies may require an endorsement. A statement on this certificate does not confer rights to the certificate holder in lieu of such endorsement(s).

PRODUCER License # 0E67708

IOA Insurance Services
3636 Nobel Drive
Suite 410
San Diego, CA 92122

CONTACT Ali Smith

PHONE (A/C, H, Ext): (619) 788-6795 60206

FAX (A/C, H, Ext): (619) 674-6208

E-MAIL ADDRESS: Ali.Smith@ioaisa.com

INSURER(S) AFFORDING COVERAGE

NAIC #

INSURER A: RLI Insurance Company

13056

INSURER B: Arch Insurance Company

11150

INSURER C:

INSURER D:

INSURER E:

INSURER F:

INSURED

RJM Design Group, Inc.
31591 Camino Capistrano
San Juan Capistrano, CA 92675

COVERAGES

CERTIFICATE NUMBER:

REVISION NUMBER:

THIS IS TO CERTIFY THAT THE POLICIES OF INSURANCE LISTED BELOW HAVE BEEN ISSUED TO THE INSURED NAMED ABOVE FOR THE POLICY PERIOD INDICATED. NOTWITHSTANDING ANY REQUIREMENT, TERM OR CONDITION OF ANY CONTRACT OR OTHER DOCUMENT WITH RESPECT TO WHICH THIS CERTIFICATE MAY BE ISSUED OR MAY PERTAIN, THE INSURANCE AFFORDED BY THE POLICIES DESCRIBED HEREIN IS SUBJECT TO ALL THE TERMS, EXCLUSIONS AND CONDITIONS OF SUCH POLICIES. LIMITS SHOWN MAY HAVE BEEN REDUCED BY PAID CLAIMS.

INSR LTR	TYPE OF INSURANCE	ADDITIONAL SUBROGATION	POLICY NUMBER	POLICY EFF (MM/DD/YYYY)	POLICY EXP (MM/DD/YYYY)	LIMITS
A	<input checked="" type="checkbox"/> COMMERCIAL GENERAL LIABILITY <input type="checkbox"/> CLAIMS-MADE <input checked="" type="checkbox"/> OCCUR <input checked="" type="checkbox"/> Cont Liab/Sov of Int	X	PSB0007263	9/30/2024	9/30/2025	EACH OCCURRENCE \$ 2,000,000 DAMAGE TO RENTED PREMISES (Ea occurrence) \$ 1,000,000 MED EXP (Any one person) \$ 10,000 PERSONAL & ADV INJURY \$ 2,000,000 GENERAL AGGREGATE \$ 4,000,000 PRODUCTS - COMP/OP AGG \$ 4,000,000 Ded \$ 0
A	AUTOMOBILE LIABILITY <input type="checkbox"/> ANY AUTO OWNED AUTOS ONLY <input checked="" type="checkbox"/> HIRED AUTOS ONLY <input checked="" type="checkbox"/> No Co. Owned Autos		PSA0002412	9/30/2024	9/30/2025	COMBINED SINGLE LIMIT (Ea accident) \$ 1,000,000 BODILY INJURY (Per person) \$ BODILY INJURY (Per accident) \$ PROPERTY DAMAGE (Per accident) \$
A	<input checked="" type="checkbox"/> UMBRELLA LIAB <input type="checkbox"/> EXCESS LIAB	<input checked="" type="checkbox"/> OCCUR <input type="checkbox"/> CLAIMS-MADE	PSE0003628	9/30/2024	9/30/2025	EACH OCCURRENCE \$ 1,000,000 AGGREGATE \$ 1,000,000 Ded \$
A	WORKERS COMPENSATION AND EMPLOYERS' LIABILITY ANY PROPRIETOR/PARTNER/EXECUTIVE OFFICER/ MEMBER EXCLUDED? (Mandatory in HI) <input type="checkbox"/> Y/N	X	PSW0004066	9/30/2024	9/30/2025	<input checked="" type="checkbox"/> PER STATUTE <input type="checkbox"/> OTH-ER E.L. EACH ACCIDENT \$ 1,000,000 E.L. DISEASE - EA EMPLOYEE \$ 1,000,000 E.L. DISEASE - POLICY LIMIT \$ 1,000,000
B	Prof Liab/Clims Made		PAAEP0031107	10/1/2024	10/1/2025	Per Claim 2,000,000
B	Ded.: \$25K Per Claim		PAAEP0031107	10/1/2024	10/1/2025	Aggregate 2,000,000

DESCRIPTION OF OPERATIONS / LOCATIONS / VEHICLES (ACORD 101, Additional Remarks Schedule, may be attached if more space is required)
Re: All Operations

City of Huntington Beach, its elected or appointed officials, officers and employees are Additional Insureds with respect to General Liability per the attached endorsements as required by written contract. Waiver of Subrogation applies to Workers' Compensation.

30 Days Notice of Cancellation with 10 Days Notice for Non-Payment of Premium in accordance with the policy provisions.

By:

MICHAEL E. GATES

CITY ATTORNEY

CERTIFICATE HOLDER

City of Huntington Beach
Attn: Risk Management
2000 Main Street
Huntington Beach, CA 92648

CANCELLATION

SHOULD ANY OF THE ABOVE DESCRIBED OPERATIONS BE CANCELLED BEFORE THE EXPIRATION DATE THEREOF, NOTICE WILL BE DELIVERED IN ACCORDANCE WITH THE POLICY PROVISIONS.

AUTHORIZED REPRESENTATIVE

ACORD 25 (2016/03)

© 1998-2015 ACORD CORPORATION. All rights reserved.

The ACORD name and logo are registered marks of ACORD

Named Insured: RJM Design Group, Inc.
Policy Number: PSW0004066

WORKERS COMPENSATION AND EMPLOYERS LIABILITY INSURANCE POLICY

WG 04 03 06
(Ed. 4-84)

WAIVER OF OUR RIGHT TO RECOVER FROM OTHERS ENDORSEMENT-CALIFORNIA

We have the right to recover our payments from anyone liable for an injury covered by this policy. We will not enforce our right against the person or organization named in the Schedule. (This agreement applies only to the extent that you perform work under a written contract that requires you to obtain this agreement from us.)

You must maintain payroll records accurately segregating the remuneration of your employees while engaged in the work described in the Schedule.

The additional premium for this endorsement shall be _____% of the California workers' compensation premium otherwise due on such remuneration.

Schedule

Person or Organization

All persons or organizations that are party to a contract that requires you to obtain this agreement, provided you executed the contract before the loss.

Job Description

Jobs performed for any person or organization that you have agreed with in a written contract to provide this agreement.

THIS ENDORSEMENT CHANGES THE POLICY, PLEASE READ IT CAREFULLY.

**RLIPack® FOR PROFESSIONALS
BLANKET ADDITIONAL INSURED ENDORSEMENT**

This endorsement modifies insurance provided under the following:

BUSINESSOWNERS COVERAGE FORM - SECTION II -- LIABILITY

1. C. WHO IS AN INSURED is amended to include as an additional insured any person or organization that you agree in a contract or agreement requiring insurance to include as an additional insured on this policy, but only with respect to liability for "bodily injury", "property damage" or "personal and advertising injury" caused in whole or in part by you or those acting on your behalf:

- a. In the performance of your ongoing operations;
- b. In connection with premises owned by or rented to you; or
- c. In connection with "your work" and included within the "product-completed operations hazard".

2. The insurance provided to the additional insured by this endorsement is limited as follows:

- a. This insurance does not apply on any basis to any person or organization for which coverage as an additional insured specifically is added by another endorsement to this policy.
- b. This insurance does not apply to the rendering of or failure to render any "professional services".
- c. This endorsement does not increase any of the limits of insurance stated in D. Liability And Medical Expenses Limits of Insurance.

3. The following is added to SECTION III H.2. Other Insurance -- COMMON POLICY CONDITIONS (BUT APPLICABLE ONLY TO SECTION II -- LIABILITY)

However, if you specifically agree in a contract or agreement that the insurance provided to an

additional insured under this policy must apply on a primary basis, or a primary and non-contributory basis, this insurance is primary to other insurance that is available to such additional insured which covers such additional insured as a named insured, and we will not share with that other insurance, provided that:

- a. The "bodily injury" or "property damage" for which coverage is sought occurs after you have entered into that contract or agreement; or
- b. The "personal and advertising injury" for which coverage is sought arises out of an offense committed after you have entered into that contract or agreement.

4. The following is added to SECTION III K. 2. Transfer of Rights of Recovery Against Others to Us -- COMMON POLICY CONDITIONS (BUT APPLICABLE TO ONLY TO SECTION II -- LIABILITY)

We waive any rights of recovery we may have against any person or organization because of payments we make for "bodily injury", "property damage" or "personal and advertising injury" arising out of "your work" performed by you, or on your behalf, under a contract or agreement with that person or organization. We waive these rights only where you have agreed to do so as part of a contract or agreement with such person or organization entered into by you before the "bodily injury" or "property damage" occurs, or the "personal and advertising injury" offense is committed.

ALL OTHER TERMS AND CONDITIONS OF THIS POLICY REMAIN UNCHANGED.

EXHIBIT A

On-Call Architectural Engineering, Landscape Architectural Engineering, and Professional Consulting Services

City of Huntington Beach



Proposal

April 29, 2025



Table of Contents



Murdy Park, Huntington Beach (RJM Project)

Cover Letter | 1

Vendor Application Form | 2

Background and Project Summary Section | 4

Methodology Section | 5

Staffing | 11

Qualifications | 16

References | 23

Clarifications, Exceptions, or Deviations | 25

Fee Proposal | *See Separate Document Submission*

Cover Letter

31591 Camino Capistrano
San Juan Capistrano, CA 92675
www.RJMdesigngroup.com
(949) 493-2600 *phone*
(949) 493-2690 *fax*



April 29, 2025

City of Huntington Beach
Community & Library Services Department
2000 Main St. No. 5
Huntington Beach, CA 92648

Re: RFQ: On-Call Architectural Engineering, Landscape Architectural Engineering, and Professional Consulting Services

Dear Selection Committee and Department:

RJM Design Group, Inc. is pleased to submit our proposal for **On-Call Landscape Architecture Engineering Services** for the **City of Huntington Beach**. We are very excited about the opportunity to continue providing our services to the City and its residents.

RJM Design Group is a multi-disciplinary landscape architectural design and planning firm with extensive experience providing On-Call / As-Needed Professional Consulting and Design Services to numerous municipal clients. Specific to the City of Huntington Beach and this RFP, we present this proposal for the Landscape Architecture Engineering category. We will be responsible for providing various landscape planning, design and engineering services as outlined in the RFP. Our Scope of Work included herein defines our approach and methodology to delivering these on-call / as-needed landscape architectural engineering services.

RJM Design Group is proud to celebrate our 38th year in business. The key to our stability and success is our many clients with whom we have developed strong relationships with. We are committed to working closely with City staff to ensure the project development processes run smoothly and efficiently. Our goal is to work with the City to improve the quality of life for its residential and business communities.

Thank you for the opportunity to present our team and methodology for your consideration. If you have any questions or comments after reviewing this proposal, please feel free to contact me directly by phone at (949) 493-2600 or email at zach@rjmdesigngroup.com.

Sincerely,
RJM Design Group

A handwritten signature in blue ink, appearing to read "Zachary Mueting", is written over a faint circular background.

Zachary Mueting, LLA
Principal
zach@rjmdesigngroup.com

REQUEST FOR PROPOSAL
VENDOR APPLICATION FORM

TYPE OF APPLICANT: ☐ NEW ☒ CURRENT VENDOR

Legal Contractual Name of Corporation: RJM Design Group, Inc.

Contact Person for Agreement: Zachary Muetting

Corporate Mailing Address: 31591 Camino Capistrano

City, State and Zip Code: San Juan Capistrano, CA 92675

E-Mail Address: zach@rjmdesigngroup.com

Phone: 949 493-2600 Fax: N/A

Contact Person for Proposals: Amanda Gorman

Title: Marketing E-Mail Address: amanda@rjmdesigngroup.com

Business Telephone: 949 493-2600 Business Fax: N/A

Year Business was Established: 1987

Is your business: (check one)

☐ NON PROFIT CORPORATION ☒ FOR PROFIT CORPORATION

Is your business: (check one)

<input checked="" type="checkbox"/> CORPORATION	<input type="checkbox"/> LIMITED LIABILITY PARTNERSHIP
<input type="checkbox"/> INDIVIDUAL	<input type="checkbox"/> SOLE PROPRIETORSHIP
<input type="checkbox"/> PARTNERSHIP	<input type="checkbox"/> UNINCORPORATED ASSOCIATION

Names & Titles of Corporate Board Members

(Also list Names & Titles of persons with written authorization/resolution to sign contracts)

Names	Title	Phone
Larry Ryan	President	949 493-2600
Zachary Mueting	Secretary	949 493-2600
Anita Weaver	CFO	949 493-2600

Federal Tax Identification Number: 33-0254945

City of Huntington Beach Business License Number: N/A
(If none, you must obtain a Huntington Beach Business License upon award of contract.)

City of Huntington Beach Business License Expiration Date: N/A

Background and Project Summary Section

RJM Design Group offers landscape architectural and design services, specializing in parks and recreation and other public facilities. At RJM, we are nearing our 38th year of professional experience in working with counties, cities, and other public sectors. RJM's mission is to assist communities in the planning and design of environments that enhance the quality of life for all. Our goal is to implement the vision of the clients and the communities we serve by designing creative, functional, and fun Community Inspired Spaces.

The key to our stability and success are our many clients with whom we have developed long-term relationships. Throughout the years, we have had the good fortune to be selected as a pre-qualified On-Call Consultant to numerous counties, cities, and agencies. These include the cities of Mission Viejo (29 years), Long Beach (28 years), Chino (28 years), Chino Hills (23 years), Aliso Viejo (20 years), Santa Ana (16 years), Huntington Beach (15 years), San Dimas (15 years), County of Orange (15 years), San Juan Capistrano (14 years), County of Los Angeles (14 years), Whittier (11 years), Newport Beach (9 years) and various additional Clients.

Through this experience we strive to:

- Work closely with our client to develop a clear understanding of project goals.
- Provide adequate staffing to provide service to clients on a short notice.
- Develop a comprehensive scope and fee summary with the necessary specialty consultants.
- Develop a project schedule that identifies all important project milestones (plan submittals, review periods, public presentations, other agency interactions/review, approvals, etc.).
- Exceed your expectations in providing comprehensive and well-coordinated design services.



RJM Staff | RJM Office

Methodology Section

Project Approach Summary Table		
Phase	Approach	Deliverables
Kick-Off	<ul style="list-style-type: none"> Kick-Off meeting with City On-site review 	Request for Information Project Schedule
Preliminary Design	<ul style="list-style-type: none"> Obtain survey Overlay project base with existing utilities Prepare Schematic Design Plans Prepare for and facilitate a Community workshop Meet with City Project Manager for review 	Schematic Design Plans Statement of Probable Construction Costs City's Project Manager comments
Design Development	<ul style="list-style-type: none"> Prepare refined Schematic Design Plans Prepare product cut sheets and color samples Meet with City Project Manager for review 	Refined consensus plan color graphics, refined preliminary construction cost estimate Product cut sheets and color samples
Construction Documents	<ul style="list-style-type: none"> Prepare drawings and specifications based on approved Design Development Documents, setting forth in detail the landscape requirements for the project Prepare final Statement of Probable Construction Costs Develop and prepare technical specifications 	Construction Drawings Statement of Probable Construction Costs Technical Specifications
Agency Approval	<ul style="list-style-type: none"> Submit plans, specifications and cost estimate to the City for plan check, review and final approval Submit project documentation to the affected agencies, as well as City department (as required) Revise plans and specifications in response to City and other agency comments, resubmit for review and approval 	Final approved plans, specifications and cost estimate
Bidding	<ul style="list-style-type: none"> Assist the City with questions, clarifications, or conflicts that arise during the Bidding Phase 	Addenda as a result of bid clarifications
Construction Administration	<ul style="list-style-type: none"> Conduct pre-construction conference Review submittals and shop drawings Conduct job site meetings Prepare final punch list 	Request for information, change order requests and other related communications Final walk-through and punch list
Close-Out	<ul style="list-style-type: none"> Conduct final job site meeting and review of the entire facility Conduct a second walk-through when all punch list items have been corrected, at which time a Final Notice of Completion shall be filed by the City. Prepare As-built record drawings 	As-built record drawings

Methodology Section (continued)

LANDSCAPE ARCHITECTURE SERVICES

The following Draft Scope of Services outlines the various tasks associated with the preparation of improvement plans for a variety of community projects. We have included an optional service that outlines a public workshop process that we have utilized successfully for numerous community projects. Tasks and methodology below are based upon our experience with similar projects. Our proposed scope of work is general in nature to give you some idea of the design process we envision. This is a "Draft" approach that is subject to review and refinement per City comments and direction. In collaboration with City staff, our Design Team shall review, elaborate upon, and clarify the overall objectives for the development of your project.

PHASE 1.0 – PRELIMINARY DESIGN

1. Project Familiarization (research, site reconnaissance, opportunities and constraints)
2. Prepare a Draft Scope of Work and anticipated Schedule
3. Meet with City and Design Team to review scope of work and refine as necessary
4. "Taking Part" Community Workshop (Optional Service)—can be provided in a "virtual" format
5. Commence preparation of Preliminary Design (including plans and cost estimate)
6. Meet to review Preliminary Plans/Cost Estimate and revise as necessary per City comments
7. Prepare for and attend community/public presentation as desired by City
8. Refine Preliminary plans based on public comments and City direction
9. Prepare for and attend public review meeting to obtain City approval

PHASE 2.0 – DESIGN DEVELOPMENT

1. Based upon approved Preliminary Plan, prepare Design Development Plans indicating the proposed site components. Provide plan enlargements and catalog cut sheets to clearly define all site elements.
2. City to review and approve Design Development Plans, plan enlargements, and catalog cut sheets, to evaluate project goals, budget, and long term maintenance considerations.
3. Based on the nature and complexity of the project, we shall assist the City in securing the services of a Construction Management firm with the desired level of expertise in the specific type of project.

PHASE 3.0 – CONSTRUCTION DOCUMENTS

This phase of a project consists of the preparation of the construction documents to include final drawings, specifications, calculations, and final cost estimates based upon the approved Preliminary Design Plans. Construction drawings will be submitted at 90% complete for review, revised, and finally 100% complete construction drawings will be submitted for city review and approval.

1. Landscape Design/Documentation

Services during the Construction Documents Phase consist of preparation of drawings and specifications based on approved Design Development Documents, Setting forth in detail the landscape requirements for the project including:

- a. Site construction/layout plans
- b. Planting plans
- c. Irrigation plans
- d. Details

Methodology Section (continued)

2. Civil Design/Documentation (if needed)

Services during the Construction Documents Phase consist of preparation of final civil engineering calculations, drawings and specifications based on approved Design Development Documents, setting forth in detail the civil construction requirements for the project.

- a. Prepare precise grading/site plan.
- b. Prepare on-site area drain plans.
- c. Prepare quantity and cost estimate for items shown on grading/site plan.
- d. Review and edit project specifications for site development and site utility construction items.

3. Electrical Design/Documentation (if needed)

Final drawings and specifications shall be completed at the Contract Documents Phase. All power, lighting and control schemes, complete with diagrams and details shall be finalized.

4. Statement of Probable Construction Cost
5. Submit plans to the City at 90% completeness for review
6. Meet with City to review plan check comments
7. Revise plans per plan check comments
8. Provide approved and digitally signed PDF plans and specifications to the City for public notice and formal bidding.

PHASE 4.0 - BIDDING AND NEGOTIATION

Following the City's approval of the Construction Documents and of the most recent Statement of Probable Construction Cost, we shall provide those services necessary to assist the City in obtaining bids or negotiated proposals and in awarding and preparing contracts for construction.

PHASE 5.0 - CONSTRUCTION SERVICES

The Construction Contract Administration Phase shall provide those services necessary for the administration of the construction contract.

1. Office construction administration

Services consist of:

- a. Review and approval of submittals
- b. Review and response to RFI's with supplemental drawings, specifications and interpretations in response to requests for information by Contractor.

2. Construction field observation: Services consist of visits to the project site at intervals appropriate to the stage of construction or as otherwise agreed in writing to become generally familiar with the progress and quality of the work and to determine in general if the work is proceeding in accordance with the Contract Documents, and preparing related reports and communications. (Number of site visits to be determined based on scope of construction and construction period).

Methodology Section (continued)

QUALITY ASSURANCE

The success of RJM Design Group can best be measured by our numerous long-term relationships with our valued clients. In order to foster these relationships, our goal is to produce a high-quality product in the most effective manner possible by utilizing our proven QA/QC procedures.

Our Quality Assurance Program is process-oriented and begins with experienced staff along with our firm's commitment to ongoing education. Our experience is based on hundreds of successful projects and gratified clients. Our staff is encouraged to continually pursue expanding their current knowledge base in order to allow us to be at the forefront of our industry. Continuing education is pursued in the following areas:

- AIA** – American Institute of Architects
- ISA CA** – International Society of Arborists, Certified Arborists
- ASLA** – American Society of Landscape Architects
- CPSI** – Certified Playground Safety Inspector
- LEED** – Sustainable Practices
- PSMJ** – Project Management
- QSP & QSD** – Qualified SWPPP Practitioner and Developer
- STMA** – Sports Turf Managers Association

In addition to our well-educated and seasoned professionals is our thorough understanding of the project development process. This allows us to share information with our consultant team and clients so that our projects evolve in a proactive and well-orchestrated manner. Communication among staff, team members and client include the following project parameters:

Project Goals – clearly identified.

Program Needs – confirmed with the client.

Schedule – a project schedule is established at the onset which outlines the process evolution, major milestones, submittal dates, reviews, approvals, bid, construction, project opening, one-year follow up/review.

Budget – understanding the budget is critical to a project's success. The project budget is clarified (client staff, consultant fees, entitlement costs, construction costs, etc.) versus construction budget.

Construction Estimates – RJM maintains an extensive library of unit costs that are acquired through our numerous public bids, as well as from specialty consultants and independent cost estimators. This allows our preliminary opinion of probable construction costs to accurately reflect the anticipated contractors' bids.

Our office environment is an open studio that allows for continual sharing of ideas and collaboration between our experienced principals, project managers, and staff members. We believe that this interaction promotes effective communication that is vitally important to the success of every project. Team meetings are scheduled at regular intervals to ensure that accurate communication on key project aspects is shared and understood.

Noteworthy to RJM and unique when compared to other firms, is that the same design team, individual staff members responsible for all preliminary design phases, will continue on and retain responsibility for the preparation of the final construction documents. We believe that this approach allows for a more consistent and accurate method of ensuring that all of those special details discussed in the design phase are carried throughout the final construction document process. This method is fundamental for maintaining quality assurance, limiting change orders, and effectively controlling construction costs.

The continual monitoring of project evolution provides the ability to confirm that appropriate progress is being made on an ongoing basis. This review is instrumental in confirming that project goals, program needs, schedules and budgets are as intended and that unforeseen changes, "curve balls", do not occur inappropriately.

Methodology Section (continued)

QUALITY CONTROL PLAN

Our open office "bullpen" setting is especially conducive to regular milestone reviews and monitoring of a project. This review plays a central role in our quality control effort. The importance of plan review, checking, and cross-checking cannot be overemphasized, given the complexity and time constraints under which construction documents are often produced. Our review benchmarks include:

- Documents are comprehensively checked at key milestones and regular intervals.
- One person checks all important dimensions, gradients and utility infrastructure.
- The person responsible for the drawings reviews the specifications, and the specifier reviews the drawings.
- Regular consultant team meetings are held to review the documents produced by each for coordination (utility, civil, electrical, etc.)
- The Principal Landscape Architect will be ultimately responsible for all work produced under his or her direction. A constant review process is implemented in all phases of the work.

The Client is involved in reviewing plans at regular intervals and approving the construction documents before they are issued for bid.

Another integral component in our quality control process is the utilization of our "RJM lessons learned checklist." This checklist contains the learning experiences that we have encountered over 37 years of project development. It is a useful tool that allows us to systematically review our work and that of our consultant team to ensure that we are applying the collaborative experience learned to the benefit of our projects.

In addition to our in-house quality control efforts, we are also continually learning and applying the ongoing "lessons learned" from our outside plan check services provided to multiple agencies. This methodical approach to outside projects gives us the unique advantage of reviewing our own plans and specifications with an impartiality that allows for a fresh and unbiased evaluation.

COMMUNICATIONS APPROACH

An assigned Project Manager from RJM Design Group for the specific project will be the main point of contact with the City for the life of the project. RJM Design group will act as the project lead and main coordinator for all project deliverables. All communications from sub consultants will be conducted through RJM Design Group.

1. Consultants can participate in online virtual meetings via Zoom, Microsoft Teams, or other video conferencing applications. Meetings to be held at regular intervals during the early phases of the project and continue on an as-needed basis thereafter to assess progress and provide direction throughout the performance of the services and preparation of the project deliverables.
2. RJM will prepare all meeting agendas for identified scheduled meetings with the City and provide a summary of key issues with action items (meeting notes) discussed at each meeting.

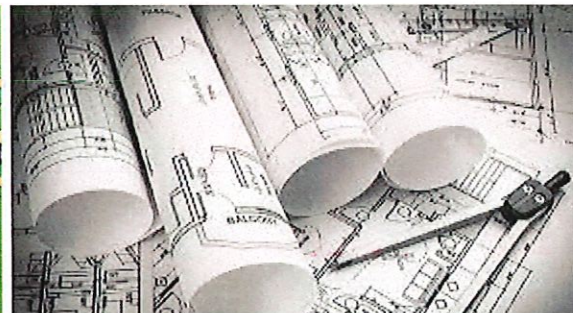

Methodology Section (continued)

Evidence of Insurability / Business License

- a. RJM Design Group, Inc. certifies that we will provide the City's required insurance coverage per Exhibit-2 INS-A.
- b. RJM Design Group, Inc. acknowledges that, if awarded the contract, the proposer has ten (10) calendar days to produce the required insurances, including a certified endorsement naming the City as additionally insured.
- c. RJM Design Group, Inc. acknowledges that, if awarded the contract, the proposer must provide a copy of current business license or other applicable licenses.

Company Overview & Disclosure

- a. No contributions were made by RJM Design Group, Inc. to any City of Huntington Beach elected officials by the owners of the company.
- b. RJM Design Group, Inc. has been in business for 38 years. There are no prior business names. Combined amongst all of RJM Design Group, Inc.'s team members, we have over 40 years of experience in providing the proposed, equivalent, or related services.
- c. RJM Design Group, Inc. has not been subject to any litigation, current or within the last 5 years, involving the company or any principal officers thereof in connection with any contract. RJM Design Group, Inc. nor the principals associated with our company are under investigation, being sued, suing, or affiliated in any lawsuit or alternative dispute resolution with any governmental agency.



City of Huntington Beach

RJM Design Group, Inc.

Will Provide:

Professional Landscape Architectural Services,
Project Management, Project
Coordination & Administration

Principal In Charge:

Zachary Mueeting

Project Landscape Architect / Project Manager:

Eric Chastain
Andrew Steen

Sub-Consultants:

Civil Engineering
Tom Carcelli - CivTec

Electrical Engineering
Bill Zavrsnick - FBA Engineering

Irrigation
Chris Curry - Glasir Design

RJM Design Group is able to provide
additional subconsultant services including:
*Architecture, Aquatic Design, Environmental
Analysis, Structural Engineering,
Geotechnical Services, Skatepark Design.*

Staffing (continued)



Zachary Mueting , LLA
Principal-in-Charge

RJM Design Group, Inc.

Zachary Mueting is a visionary landscape architect and urban designer with over a decade of experience creating sustainable and engaging outdoor spaces. His portfolio includes diverse projects, from public parks and recreational facilities to urban landscapes, all designed to foster community connection and environmental stewardship. With a passion for blending innovation and aesthetics, Zachary's work emphasizes collaboration and a deep understanding of community needs, resulting in spaces that inspire and endure. Zachary's exceptional technical design skills and ability to lead project teams have been integral to his success in delivering complex, high-impact projects. He combines advanced proficiency in design software and sustainable practices with strategic project management, ensuring that each initiative is executed efficiently and to the highest standards. His leadership style fosters collaboration and innovation among team members, empowering them to achieve shared goals and exceed client expectations.

Licenses

- Landscape Architect / CA 5731

Education

- Masters Degree, Landscape Architecture, California Polytechnic State University, Pomona
- Bachelor of Science, Information Technology, Colorado Technical University
- Bachelor of Science, Information Systems Management, Colorado Technical University

On-Call Services

- On-Call Design Services, City of Aliso Viejo, CA
- On-Call Design Services, City of Chino Hills, CA
- On-Call Design Services, City of Fresno, CA
- On-Call Design Services, City of Huntington Beach, CA
- On-Call Design Services, City of Laguna Niguel, CA
- On-Call Design Services, City of Lake Elsinore, CA
- On-Call Design Services, City of Lake Forest, CA
- On-Call Design Services, City of Long Beach, CA
- On-Call Design Services, City of Los Angeles, CA
- On-Call Design Services, City of Mission Viejo, CA
- On-Call Design Services, City of Newport Beach, CA
- On-Call Design Services, City of Ontario, CA
- On-Call Design Services, City of Sacramento, CA
- On-Call Design Services, City of San Juan Capistrano, CA
- On-Call Design Services, City of Santa Ana, CA
- On-Call Design Services, City of South El Monte, CA
- On-Call Design Services, City of West Sacramento, CA
- On-Call Design Services, County of Los Angeles, LA County Development Authority, Los Angeles, CA
- On-Call Design Services, County of Orange, Orange County Public Works, Orange County, CA
- On-Call Design Services, County of San Bernardino, Special Districts Department, CA
- On-Call Design Services, Los Angeles Community College District (LACCD), Los Angeles, CA



Eric Chastain LLA, LEED AP
(BD+C)

Principal Project Manager

RJM Design Group, Inc.

Eric Chastain is a highly accomplished Principal Project Manager with a deep expertise in project management, construction, and design. Recognized as the "go-to guy" for delivering successful projects, Eric is known for his ability to navigate complex challenges, streamline processes, and ensure seamless project execution from inception to completion. His leadership and problem-solving skills make him an invaluable asset to any design and construction team.

With extensive experience in aquatics and sports facility design, Eric has played a key role in the planning and development of high-performance recreational and athletic spaces. His expertise spans all phases of the design process, including program development, site analysis, conceptual design, construction documentation, and construction observation. His hands-on approach ensures that each project is executed with precision, functionality, and long-term sustainability in mind.

Licenses

- Landscape Architect / CA 3411
- LEED Accredited Professional

Education

- Bachelor of Science, Landscape Architecture, California Polytechnic State University, Pomona, CA
- Minor in Irrigation Design, California Polytechnic State University, Pomona, CA

On-Call Design Services

- On-Call Design Services, City of Aliso Viejo, CA
- On-Call Design Services, City of Bell Gardens, CA
- On-Call Design Services, City of Chino Hills, CA
- On-Call Design Services, City of Dana Point, CA
- On-Call Design Services, City of Eastvale, CA
- On-Call Design Services, City of Laguna Niguel, CA
- On-Call Design Services, City of Lake Forest, CA
- On-Call Design Services, City of Long Beach, CA
- On-Call Design Services, City of Los Angeles, CA
- On-Call Design Services, City of Mission Viejo, CA
- On-Call Design Services, City of Newport Beach, CA
- On-Call Design Services, City of Perris, CA
- On-Call Design Services, City of Riverside, CA
- On-Call Design Services, City of San Juan Capistrano, CA
- On-Call Design Services, City of Santa Ana, CA
- On-Call Design Services, County of Los Angeles, LA County Development Authority (LACDA), Los Angeles, CA
- On-Call Design Services, Orange County Public Works, Orange County, CA

Staffing (continued)



Andrew Steen, LLA
Associate Landscape Architect
RJM Design Group, Inc.

Andy Steen has been a dedicated member of RJM Design Group since 2014, bringing over 20 years of experience as a licensed Landscape Architect and certified arborist. With a strong background in landscape materials, construction, and detailing, Andy has developed a unique approach to blending traditional techniques

with innovative, modern design ideas. His expertise spans across a wide range of projects, with a particular focus on imaginative and exciting playground design, where his design solutions emphasize both functionality and aesthetic appeal. Known for his exceptional project management skills, Andy ensures projects are completed on time and within budget while maintaining the highest quality standards. His extensive knowledge of plant species and horticulture further enriches his designs, allowing him to create sustainable, thriving landscapes. Andy's depth of experience and commitment to excellence make him an invaluable asset to any project.

Licenses

- Landscape Architect / CA 5858
- Certified Arborist WE-9969A
- Tree Risk Assessment Qualification
- FAA 107 Licensed Remote Drone Pilot

Education

- Bachelor of Science, Environmental Planning and Design, Landscape Architecture, Rutgers University, State University of New Jersey

On-Call Experience

- On-Call Design Services, City of Signal Hill, CA
- On-Call Plan Check Services, City of Aliso Viejo, CA
- On-Call Plan Check Services, City of Chino, CA
- On-Call Plan Check Services, City of Culver City, CA
- On-Call Plan Check Services, City of Laguna Niguel, CA
- On-Call Plan Check Services, City of Laguna Woods, CA
- On-Call Plan Check Services, City of Mission Viejo, CA
- On-Call Plan Check Services, City of San Dimas, CA
- On-Call Plan Check Services, City of Whittier, CA

Parks

- Boulder Pond Park, Rancho Mission Viejo, CA
- Carriage Crest Park, Carson, CA
- Cherry Park, Lake Forest, CA
- Cordova Park, Mission Viejo, CA
- Darrin Park, Lake Forest, CA
- Los Serranos Park, Chino Hills, CA
- Mile Square Park Golf Course Conversion, Orange, CA
- Murdy Park, Huntington Beach, CA
- Pinehurst Park, Chino Hills, CA
- Portola Park, Lake Forest, CA
- Premier Park, Stanton, CA
- Worthy Park, Huntington Beach, CA
- Yorba Linda Adventure Playground, Yorba Linda, CA

Tom Carcelli
Civil Engineer
civTEC



Tom Carcelli has over 25 years of experience in the civil engineering field with particular emphasis on parks and recreation, commercial/industrial, education and public works projects. His extensive design and management experience in all phases of civil engineering for land development projects throughout Southern California includes grading, water quality, hydrology, hydraulics, storm drain, water/sewer, survey/mapping and street design. Tom has been in charge as a project manager on over 100 projects from master planning to construction with RJM Design Group over the past 20 years.

Education

- BS, Civil Engineering, University of California, Irvine, 1988
- Masters in Architecture, California State Polytechnic University, Pomona, 1994

Licenses

- Registered Civil Engineer/CA #81640
- Qualified SWPPP Developer (QSD) – C-81640

Relevant Project Experience

- Anthony Munoz Community Center, Ontario, CA
- Bommer Canyon Community Park, Irvine, CA
- Cherry Park, Lake Forest, CA
- Cordova Park, Mission Viejo, CA
- Dali Dog Park, Rowland Heights, CA
- Esencia Sports Park, Rancho Mission Viejo, CA
- Ford Park Aquatics Facility, Bell Gardens, CA
- Gardena Community Aquatics & Senior Center, Gardena, CA
- Grant Howald Park, Newport Beach, CA
- JAPRD Community Recreation Center, Riverside, CA
- Joe Balderrama Park, Oceanside, CA
- Lake Mission Viejo Improvements, Mission Viejo, CA
- Los Serranos Park, Chino Hills, CA
- Marguerite Aquatics Complex, Mission Viejo, CA
- Murdy Park, Huntington Beach, CA
- Orange Coast College Baseball Field Renovation, Costa Mesa, CA
- Peace Park Playground, Long Beach, CA
- Portola Park, Lake Forest, CA
- Rancho Cucamonga Central Park Master Plan Update, Rancho Cucamonga, CA
- Santa Ana Civic Center Plaza Improvements, Santa Ana, CA
- Santa Monica Civic Multi-Purpose Sports Field, Santa Monica, CA
- Yorba Linda Adventure Play, Yorba Linda, CA

Staffing (continued)

William Zavrnsnick **FBA ENGINEERING**
Electrical Engineer
FBA Engineering

William Zavrnsnick has 30 years of experience and has been active in the electrical engineering field since joining FBA in 1985. His experience includes the electrical design of Public Works, Parks and Recreation Facilities. He is particularly experienced in the design and development of electrical power distribution, general, specialized and event power systems, outdoor, security and sports field lighting systems, lighting photometric studies, phased construction projects and familiar with public bid type projects and construction.

Education

- BS Civil Engineering/Mount Hood College, Oregon

Certifications

- LEED Accredited Professional – LEED AP
- Illuminating Engineering Society – IES
- Institute of Electrical and Electronic Engineers – IEEE American Institute of Architects – AIA
- Electrical Engineering – Los Angeles County

Relevant Project Experience

- Bommer Canyon Community Park, Irvine, CA
- Bonita Creek Field Renovation, Newport Beach, CA
- City Park Improvements, Lake Elsinore, CA
- Civic Lot Multi-Purpose Sports Field, Santa Monica, CA
- El Dorado Park & Nature Center, Long Beach, CA
- Esencia Sports Park, Rancho Mission Viejo, CA
- Grant Howald Park, Newport Beach, CA
- Hero's Park, Lake Forest, CA
- Joe Balderrama Park, Oceanside, CA
- Kraemer Memorial Park, Placentia, CA
- Laguna Hills City Parks, Laguna Hills, CA
- Lake Forest Neighborhood Parks, Lake Forest, CA
- La Placita Parkette, Placentia, CA
- Los Amigos Park, Santa Monica, CA
- Los Serranos Park, Chino Hills, CA
- Marchant Park, San Dimas, CA
- McFadden Park, Placentia, CA
- Murdy Park, Huntington Beach, CA
- Portola Park, Lake Forest, CA
- Portola Springs Park, Irvine, CA

Chris Curry
Irrigation Designer
Glaser Design

Chris Curry has over 15 years experience in irrigation design, landscape architecture, and landscape construction. His focus is on the efficient use of water in the landscape. He has been rewarded for his efforts by being chosen by the United States Environmental Protection Agency as the WaterSense Irrigation Partner of the year for 2011. He is only the second irrigation design consultant chosen for this award that shows his commitment to the environment through sound water conservation practices. Chris is a leader in the irrigation industry. His expertise is called upon by manufacturers, cities, and water districts.

Education

- Bachelor of Science, Landscape Irrigation Science, California State Polytechnic University, Pomona, CA

Designation

- US Environmental Protection Agency (EPA) WaterSense Irrigation Partner – Selected the 2011 EPA WaterSense Irrigation Partner of the year

Certifications

- Irrigation Association (IA) Certified Irrigation Designer (CID) in Commercial Irrigation Design, Golf Irrigation Design, and Landscape Irrigation Auditing

Memberships

- Professional Member of the American Society of Irrigation Consultants – 2011 Southern California

Parks

- Grant Howald Park, Newport Beach, CA
- Portola Park & Dog Park, Lake Forest, CA
- Central Park Master Plan Update, Rancho Cucamonga, CA
- Worthy Park Renovation, Huntington Beach, CA
- Los Amigos Park, Rancho Cucamonga, CA
- Admiral Kidd / Seaside Park Field Reno, Long Beach, CA
- Redhawk Dog Park Improvements, Temecula, CA

Sports / Aquatics Facilities

- Drake Chavez Soccer Field, Long Beach, CA
- Bonita Creek Field Renovation, Newport Beach, CA
- Lake Forest Sports Park, Lake Forest, CA
- North Beach Improvements, Lake Mission Viejo Assoc, CA
- Central Park Tennis Complex, Santa Clarita, CA
- Fillmore Aquatics & Tennis Complex, Fillmore, CA
- Santa Clarita Sports & Aquatic Center, Santa Clarita, CA

On-Call Plan Check Services

- On-Call Plan Check Services, Aliso Viejo, CA
- On-Call Plan Check Services, Chino, CA
- On-Call Plan Check Services, Laguna Niguel, CA
- On-Call Plan Check Services, Mission Viejo, CA
- On-Call Plan Check Services, San Dimas, CA
- On-Call Plan Check Services, Whittier, CA

GLASIR DESIGN

Staffing (continued)

Noteworthy to our proposal, and unique when compared to other firms, is that RJM holds long-term relationships with both our internal staff and our subconsultants. Over the past 38 years, we have cultivated a collaborative and dependable working dynamic with our subconsultant team, ensuring seamless integration and alignment with project goals. This longevity reflects not only our commitment to fostering trusted partnerships but also our ability to deliver consistent, high-quality results through a unified approach.

We bring extensive experience in collaborating with subconsultants across a wide range of projects, allowing us to effectively manage multidisciplinary teams, coordinate complex deliverables, and maintain clear communication across all parties. These long-standing relationships enable us to leverage the specialized expertise of our subconsultants while ensuring they align with RJM's standards of excellence, reliability, and innovation.

CIVIL ENGINEERING — civTEC, Tom Carcelli

999 Corporate Dr., Suite 100, Ladera Ranch, CA 92694 | (949) 463-8822 | tec@civtec.net

Our team has worked directly with Tom Carcelli on a multitude of projects since 1998. These projects include parks and park renovations, aquatic facilities, sports facilities, streetscapes, plazas and urban design, trails, cemeteries, and more.

Tom will be responsible for any civil engineering coordination including, but not limited to, site grading, drainage, and infrastructure.

ELECTRICAL ENGINEERING – FBA Engineering, Bill Zavrsnick

150 Paularino Avenue, Suite A120, Costa Mesa, CA 92626 | (949) 852-9995 | billz@fbaengr.com

Our team has worked directly with Bill Zavrsnick on a multitude of projects since 2007. These projects include parks and park renovations, aquatic facilities, sports facilities, streetscapes, plazas and urban design, trails, cemeteries, and more.

Bill will be responsible for any electrical engineering coordination including, but not limited to, site lighting, security lighting, decorative fixtures, and general site power/electrical systems.

IRRIGATION DESIGN – Glasir Design, Chris Curry

424 New Jersey Lane, Placentia, CA 92870 | (714) 514-9930 | chris@glasirdesign.com

Our team has worked directly with Chris Curry on a multitude of projects since 2011. These projects include parks and park renovations, aquatic facilities, sports facilities, streetscapes, plazas and urban design, trails, cemeteries, and more.

Chris will be responsible for any irrigation coordination including, but not limited to, landscape irrigation design, assistance with construction documents, and construction administration.

Qualifications

Established in 1987, RJM Design Group has become a prominent, multi-disciplinary firm specializing in landscape architecture, planning, and design. We are committed to serving cities, public agencies, and organizations across California, by providing creative, sustainable solutions that address the unique needs of each community. Our team consists of skilled professionals with diverse backgrounds, including licensed landscape architects, designers, and planners. Known for our innovative designs, we have a strong ability to create community-inspired spaces that enhance the environment and bring people together. Each team member brings a wealth of knowledge and a passion for their craft, ensuring personalized, high-quality service at every stage of every project.

Firm Legal Name	RJM Design Group, Inc.
Type of Business	California Corporation, SBE
Number of Years in Business	38 Years (Since 1987)
Contact Information	(949) 493-2600
List of Owners	Larry P. Ryan — President, larryr@rjmdesigngroup.com Zachary Mueting — Secretary, zach@rjmdesigngroup.com
Principal Contact	Zachary Mueting / zach@rjmdesigngroup.com
Office Location	31591 Camino Capistrano, San Juan Capistrano, CA 92675
Firm Size	20 Personnel*
Personnel	(12) Licensed Landscape Architects, Project Managers (4) Technical Support (4) Administrative Support (2) Certified Arborists (2) FAA Part 107 Licensed Pilots <i>* Some individuals hold multiple licenses</i>
Website	www.rjmdesigngroup.com



RJM Office | San Juan Capistrano, CA



Qualifications (continued)



Ontario Sports Empire

Ontario, CA

Project Completion: 2026
Project Size: 110 acres
Design Cost: \$7.5M
Construction Cost: \$350M

Client Reference
Tito Haes
Executive Public Director
City of Ontario
(909) 395-2665 | thaes@ontarioca.gov



Project Summary

Set to open in Fall 2026, the Ontario Sports Empire is positioned to become the premier venue for major regional and national tournaments, elevating Ontario as a key sports destination in the United States. With 190 acres of top-tier athletic facilities, including 20 long fields, 14 youth diamond fields, 8 full-size diamonds, 4 football/rugby fields and 2 championship baseball fields, the Ontario Sports Empire will be the largest sports complex of its kind west of the Rocky Mountains.

The sports park also offers a family activity area with large video display boards, seating, shade, passive turf areas, spectator viewing and elevated walking concourses, restroom and concession buildings, upper level restaurant style deck seating and field viewing, 3 playgrounds, interior walking paths, surface level parking and parking structure, large and satellite maintenance yards, warehouse storage, batting cages, ticketed gateway entries, pedestrian and vehicular drop off and loading zones, ball containment netting, monument and wayfinding signage.

Located just 10 minutes from the Ontario International Airport, the Ontario Sports Empire will be destination facility for both Ontario residents and visitors.

Project Team

Principal: Larry P. Ryan
Project Manager: Craig Sensenbach
Tamara McClory
Erik Curran



Qualifications (continued)

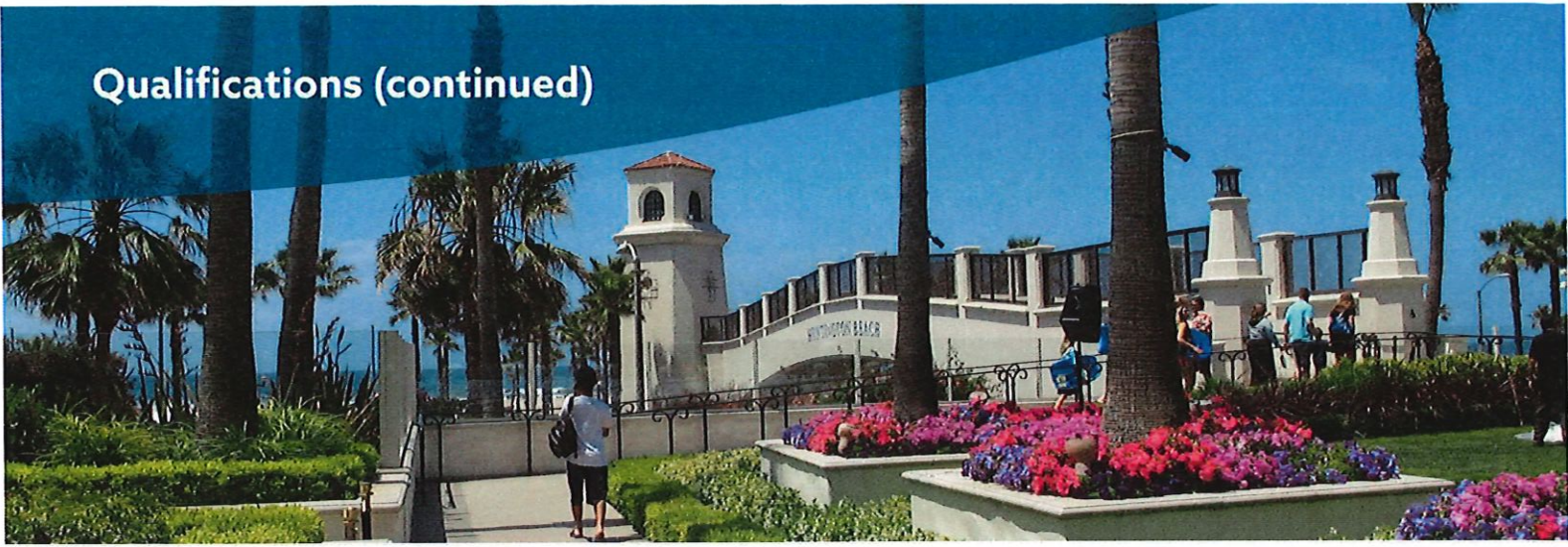

Parks & Recreation Master Plan

Huntington Beach, CA

Year Delivered: 2016
Services: \$ 190,000
Fees: \$ 200,000
Duration of Services: November 2015 to January 2016
Relationship/Role: Prime Consultant

Client Reference

Ashley Wysocki
Director of Community & Library Services
City of Huntington Beach
phone: (714) 374-5302
email: ashley.wysocki@surfcity-hb.org

Project Summary

Nicknamed "Surf City" for its beautiful wide beaches and consistently breaking surf, The City of Huntington Beach has a large and well-established park system with over seventy five parks and numerous community recreation buildings. The City contracted RJM Design Group to update its existing Parks and Recreation Master Plan. The first phase of the project included a background review of the demographics and community trends and their impact on the park system. The second phase involved a detailed inventory of the facilities and programs currently provided in the City, as well as a gap analysis of the existing facilities to determine locations where recreational opportunities are needed. The third phase included a thorough public involvement process including executive interviews, sports organization questionnaire, telephone survey, and public workshops. The fourth phase looked at the demand and needs for facilities based on the inventory of existing facilities and the data derived from the prior phases. Recommendations will include an opportunities feasibility analysis, acquisition plan, cost estimates, capital improvement plan, and sustainable practices/maintenance and operations management plan.

Project Team

Principal: Zachary Mueting
Project Manager: Kristen Schnell
Senior Associate: Tim Gallagher



Qualifications (continued)



Worthy Park Renovation

Huntington Beach, CA

Completion Date: 2017
Project Size: 1.2 Acres
Design Cost: \$ 1.49 Million
Construction Cost: \$ 1.75 Million

Client Reference
David Dominguez
Manager, Facilities & Development services
City of Huntington Beach
(951) 727-3516
ddominguez@surfcity-hb.org

Project Summary

In 2014, RJM Design Group completed a preliminary study of the existing conditions and the possible improvements to park amenities that could be made to update the existing Worthy Park site. Given the park's proximity to City Hall and the adjacent Huntington Beach High School, the site was very visible and showing signs of age. A racquetball court building, that had been shuttered nearly 10 years prior due to the waning interest in the sport, stood right in the center of the park in severe disrepair. The full-size basketball courts had been taken over by the surge in popularity of pickleball with the local community.

The racquetball building was razed giving way to a natural turf practice field, the basketball courts were converted to four pickleball courts, and new play equipment and a picnic shelter compliment the site. Residents have overwhelmingly responded to the facelift, and are now requesting that the other portions of the park be updated to match.

Project Team

Principal: Larry Ryan
Project Manager: Larry Mouri



Qualifications (continued)



Edison Skate Spot

Huntington Beach, CA

Completion Date: 2021
Project Size: 16,000 SF
Design Cost: \$9,800
Construction Cost: \$50,000

Client Reference
Chris Slama
Director of Community & Library Services
City of Huntington Beach
(714) 536-5495
cslama@surfcity-hb.org

Project Summary

As part of the renovations at the Edison Park complex, which hosts a variety of recreational amenities for the community, the City of Huntington Beach elected to construct a new temporary skate spot in an unused portion of the park. By soliciting feedback from the local community, the design consultant team of RJM Design Group and Newline Skateparks were able to craft an all-ages street feature skate spot that challenges experienced riders and helps teach beginners. This skate spot contains various elements including double-sided curbs, a manual pad, a grind bench, a flat bar, and most importantly, tons of flat ground.

Since the grand opening on July 29th, 2021, the simply designed skate spot has gotten rave reviews from the local skateboarding community, as well as parents for giving their young children a place to learn and continue the rich history of skateboarding in Huntington Beach.

Project Team

Principal: Zachary Mueting
Project Manager: Tamara McClory
Project Manager: Kanten Russell, Newline Skate Parks



Qualifications (continued)



Premier Park

Stanton, CA

Project Completed: 2024
Project Size: 0.9 acre
Design Cost: \$96,980
Construction Cost: \$1.2 M

Client Reference

Han Sol Yoo
Associate Engineer, Public Works Engineering
City of Stanton
(714) 890-4204 | hyoo@stantonca.gov

Project Summary

Premier Park, located at 8340 Briarwood Street in the City of Stanton, is a 0.90-acre recreational park that was in need of renovations. The City of Stanton elected RJM Design Group to redesign and renovate Premier Park based on feedback from the community.

The park renovation that includes new tree house themed play equipment and surfacing with integrated shade and seating areas, dynamic exercise equipment, half-court basketball court, concrete walking pathways, split-rail fences, new irrigation system, sodded turf areas, security lighting, and California Friendly landscape plant material.

The park had its Grand Opening in October of 2024 and continues to be a well-visited park for Stanton residents and the local community.

Project Team

Principal: Larry Ryan
Project Manager: Andy Steen



Project Experience



Lower Castaways Aquatics

Newport Beach, CA

Project Completed: 2026
Project Size: 4 acres
Design Cost: \$88,500
Construction Cost: \$42M

Client Reference
Tom Sandefur
Assistant City Engineer
City of Newport Beach
(949) 644-3321 | tsandefur@newportbeachca.gov



Project Summary

Prominently positioned along Newport's picturesque Back Bay and visible from Pacific Coast Highway, the Lower Castaways Aquatic Center offers a dynamic recreational hub with rich historical significance. Situated at Lower Castaways Park—the historic site of the 1870 "Old Landing," where the first commercial vessel steamed into the bay to establish a "new port"—this project blends modern amenities with Newport's coastal heritage.

The 9,100 SF, two-story aquatics center is designed to serve a variety of community needs. The first level features a welcoming reception area, staff offices, men's and women's locker rooms and restrooms, family restrooms, a pool mechanical room, and convenient outdoor lockers. On the second level, visitors will find versatile multi-purpose rooms, an outdoor patio overlooking the stunning Back Bay, a kitchen, and additional restrooms for added convenience. The project site expands beyond the main building to include a separate, one-story lifeguard and concessions building, a competition-ready 25-yard by 50-meter pool, a therapeutic pool for rehabilitation and wellness programs, and a thematic splash pad for family-friendly play. Additionally, the site offers covered spectator seating and dedicated pool equipment storage, group and individual shade cabanas for relaxation, and hand launch and public beach access to support water recreation. Covered outrigger and kayak dry storage racks are provided alongside a scenic stairway and trail connection to Upper Castaways Park. Coastal protection is enhanced with a reconstructed sea wall, while the site's rich history is preserved with a relocated historic 'Old Landing' plaque and monument entry sign. The site also includes a convenient parking lot with 189 stalls, a deceleration lane, and reconfigured sidewalks along Dover Drive for improved accessibility.

Project Team

Principal: Larry Ryan
Project Manager: Craig Sensenbach
Tyler Page

City of Huntington Beach • On-Call Landscape Architecture Services | 22



References of Work Performed Form

(List 5 Local References)

Company Name: RJM Design Group, Inc.

1. Name of Reference: City of Huntington Beach

Address: 2000 Main Street, Huntington Beach, CA 92648

Contact Name: Ashley Wysocki Phone Number: (714) 374-5304

Email: ashley.wysocki@surfcity-hb.org

Dates of Business: 01/2022 - 01/2026

2. Name of Reference: City of Newport Beach

Address: 100 Civic Center Drive, Newport Beach, CA 92692

Contact Name: Tom Sandefur Phone Number: (949) 644-3321

Email: tsandefur@newportbeachca.gov

Dates of Business: 06/2022 - 06/2026

3. Name of Reference: City of Long Beach

Address: 411 West Ocean Blvd., Long Beach, CA 90802

Contact Name: Eric Lopez Phone Number: (562) 570-6256

Email: eric.lopez@longbeach.gov

Dates of Business: 04/2024 - 03/2027

4. Name of Reference: City of Chino

Address: 13220 Central Ave., Chino, CA 91710

Contact Name: Rosa Olguin Phone Number: (909) 334-3314

Email: planning@cityofchino.org

Dates of Business: 07/2022 - 06/2025

5. Name of Reference: City of Aliso Viejo

Address: 12 Journey, Suite 100, Aliso Viejo, CA 92656

Contact Name: Shaun Pelletier Phone Number: (949) 425-2533

Email: spelletier@cityofaliso Viejo.com

Dates of Business: 07/2024 - 06/2027

Qualifications (continued) - References

2025 ON CALL DESIGN SERVICES

RJM Design Group has performed On Call Design Services for numerous cities within the past 38 years in business. Here is a summary of On Call Design Services we have been performing within the past 5 years:

	Client: CITY OF ALISO VIEJO Contact: Shaun Pelletier City Engineer 12 Journey, Suite 100 Aliso Viejo, CA 92656 phone: (949) 425-2533 email: spelletier@cityofaliso Viejo.com	Service Type: Current Contract: Landscape Architecture, Inspection Services, Plan Check Services (On-Call Since 2005) Contract Duration: July 2024 — June 2027	Principal in Charge: Larry P. Ryan RJM Team: Andrew Steen Eric Chastain Contract Amount: Hourly
	Client: CITY OF CHINO Contact: Rosa Olguin Management Assistant 13220 Central Avenue Chino, CA 91710 phone: (909) 334-3314 email: planning@cityofchino.org	Service Type: Current Contract: Landscape Architecture, Inspection Services, Plan Check Services (On-Call Since 1997) Contract Duration: July 2022 — June 2025	Principal in Charge: Larry P. Ryan RJM Team: Andrew Steen Tamara McClory Contract Amount: Hourly
	Client: CITY OF HUNTINGTON BEACH Contact: Ashley Wysocki, Director of Community & Library Services 2000 Main Street Huntington Beach, CA 92648 phone: (714) 374-5302 email: ashley.wysocki@surfcity-hb.org	Service Type: Current Contract: Landscape Architecture and Design Services (On- Call Since 2010) Contract Duration: January 2022 — January 2026	Principal in Charge: Larry P. Ryan Zachary Mueting RJM Team: Andrew Steen Contract Amount: Hourly
	Client: CITY OF LAGUNA NIGUEL Contact: Katie Crockett Planning Manager 30111 Crown Valley Parkway Laguna Niguel, CA 92677 phone: (949) 362-4363 email: kcrockett@cityoflagunaniguel.org	Service Type: Current Contract: Landscape Architecture and Plan Check Services (On-Call Since 2016) Contract Duration: May 2021 — June 2025 (Currently proposing on renewal)	Principal in Charge: Larry P. Ryan RJM Team: Andrew Steen Tamara McClory Eric Chastain Contract Amount: Hourly
	Client: CITY OF LONG BEACH Contact: Eric Lopez Director of Public Works 411 W. Ocean Blvd. Long Beach, CA 90802 phone: (562) 570-6256 email: eric.lopez@longbeach.gov	Service Type: Current Contract: Landscape Architecture and Plan Check Services (On-Call Since 1997) Contract Duration: April 2024 — March 2027	Principal in Charge: Larry P. Ryan RJM Team: Andrew Steen Tamara McClory Contract Amount: Hourly
	Client: CITY OF MISSION VIEJO Contact: Jerry Hill Assistant City Manager 200 Civic Center Drive Mission Viejo, CA 92692 phone: (949) 470-3085 email: jhill@cityofmissionviejo.org	Service Type: Current Contract: Landscape Architecture and Plan Check Services (On-Call Since 1996) Contract Duration: July 2024 — June 2026	Principal in Charge: Larry P. Ryan RJM Team: Andrew Steen Tamara McClory Eric Chastain Contract Amount: Hourly
	Client: CITY OF NEWPORT BEACH Contact: Tom Sandefur Assistant City Engineer 100 Civic Center Dr. Newport Beach, CA 92660 phone: (949) 644-3321 email: tsandefur@newportbeachca.gov	Service Type: Current Contract: Landscape Architecture and Design Services (On- Call Since 2016) Contract Duration: June 2022 — June 2026	Principal in Charge: Larry P. Ryan RJM Team: Tamara McClory Tyler Page Contract Amount: Hourly
	Client: CITY OF WHITTIER Contact: Luis G. Escobedo, AICP Senior Planner 13230 Penn Street Whittier, CA 90602 phone: (562) 567-9320 email: lescobedo@cityofwhittier.org	Service Type: Current Contract: Landscape Architecture and Plan Check Services (On-Call Since 2014) Contract Duration: July 2016 — June 2026	Principal in Charge: Larry P. Ryan RJM Team: Andrew Steen Contract Amount: Hourly

Clarifications, Exceptions, or Deviations

RJM DESIGN GROUP, INC. has established a reputation of integrity and professionalism within the landscape architecture industry. Our due diligence in performing client services begins with our proposal preparation, contract review and negotiation, and carries through to project completion.

We have reviewed the Professional Services Contract for On-Call Landscape Architectural Services with the City of Huntington Beach. As part of this review, we identify items which may not conform to the terms of our insurance coverage and/or to California Civil Code section 2782.8 which regulates contracts between public agencies and design professionals. Upon selection for this project, we would like to discuss the following requested changes pertaining to the agreement in order to arrive at mutually agreeable terms. All suggested additions and/or deletions to the contract language are in **blue**.

Page 3 - Article 7. DISPOSITION OF PLANS, ESTIMATES AND OTHER DOCUMENTS, (line 6):

... whichever shall occur first. These materials may be used by CITY as it sees fit, **provided that any such use not within the purposes intended by this Agreement shall be at City's sole risk.**

Page 3 - Article 8. HOLD HARMLESS, (line 1):

Consultant hereby agrees to protect, ~~defend~~, indemnify and hold ...

Page 3 - Article 8. HOLD HARMLESS, (lines 5-6):

... liability of any kind or nature) **to the extent** arising out of or in connection with CONSULTANT's (or CONSULTANT's subcontractors, if any) negligent **(or alleged negligent)** performance of this ...

Page 3 - Article 8. HOLD HARMLESS, (lines 9-11):

... caused by the ~~sole~~ negligence or willful misconduct of CITY. ~~CONSULTANT will conduct all defense at its sole cost and expense and CITY shall approve selection of CONSULTANT's counsel.~~ This indemnity shall apply to all claims and liability regardless of whether any ...

Page 3 - Article 8. HOLD HARMLESS, (line 13):

... of indemnification to be provided by CONSULTANT. **Notwithstanding the foregoing, if Consultant's obligation to defend, indemnify, and/or hold harmless arises out of Consultant's performance as a "design professional" (as that term is defined under Civil Code section 2782.8), then, to the extent required by Civil Code section 2782.8, which is fully incorporated herein, Consultant's indemnification obligation shall be limited to claims that arise out of, pertain to, or relate to the negligence, recklessness, or willful misconduct of the Consultant, and, upon Consultant obtaining a final adjudication by a court of competent jurisdiction, Consultant's liability for such claim, including the cost to defend, shall not exceed the Consultant's proportionate percentage of fault.**

Page 4 - Article 9. PROFESSIONAL LIABILITY INSURANCE, (line 4):

... however an insurance policy "deductible" of ~~Ten~~ **Twenty Five** Thousand Dollars ~~(\$10,000.00-\$25,000.00)~~ or less is ...

EXHIBIT "B"

Payment Schedule (Hourly Payment)

A. Hourly Rate

CONSULTANT'S fees for such services shall be based upon the following hourly rate and cost schedule:

SEE ATTACHED EXHIBIT B

B. Travel Charges for time during travel are not reimbursable.

C. Billing

1. All billing shall be done monthly in fifteen (15) minute increments and matched to an appropriate breakdown of the time that was taken to perform that work and who performed it.
2. Each month's bill should include a total to date. That total should provide, at a glance, the total fees and costs incurred to date for the project.
3. A copy of memoranda, letters, reports, calculations and other documentation prepared by CONSULTANT may be required to be submitted to CITY to demonstrate progress toward completion of tasks. In the event CITY rejects or has comments on any such product, CITY shall identify specific requirements for satisfactory completion.
4. CONSULTANT shall submit to CITY an invoice for each monthly payment due. Such invoice shall:
 - A) Reference this Agreement;
 - B) Describe the services performed;
 - C) Show the total amount of the payment due;
 - D) Include a certification by a principal member of CONSULTANT's firm that the work has been performed in accordance with the provisions of this Agreement; and
 - E) For all payments include an estimate of the percentage of work completed.

Upon submission of any such invoice, if CITY is satisfied that CONSULTANT is making satisfactory progress toward completion of tasks in accordance with this Agreement, CITY shall approve the invoice, in which event payment shall be made within thirty (30) days of receipt of the invoice by CITY. Such approval shall not be unreasonably withheld. If CITY does not approve an invoice, CITY shall notify CONSULTANT in writing of the reasons for non-approval and the schedule of performance set forth in **Exhibit "A"** may at the option of CITY be suspended until the parties agree that past performance by CONSULTANT is in, or has been brought into compliance, or until this Agreement has expired or is terminated as provided herein.

5. Any billings for extra work or additional services authorized in advance and in writing by CITY shall be invoiced separately to CITY. Such invoice shall contain all of the information required above, and in addition shall list the hours expended and hourly rate charged for such time. Such invoices shall be approved by CITY if the work performed is in accordance with the extra work or additional services requested, and if CITY is satisfied that the statement of hours worked and costs incurred is accurate. Such approval shall not be unreasonably withheld. Any dispute between the parties concerning payment of such an invoice shall be treated as separate and apart from the ongoing performance of the remainder of this Agreement.

Fee Proposal

EXHIBIT B

RJM DESIGN GROUP, INC.	
Principal Landscape Architect	\$240 per hour
Associate Landscape Architect	\$215 per hour
Landscape Architect	\$200 per hour
Job Captain / Landscape Designer	\$185 per hour
CADD Technician / Graphics	\$170 per hour
Word Processor	\$125 per hour
CIVTEC (CIVIL ENGINEER)	
Principal	\$235 per hour
Project Manager	\$185 per hour
Project Engineer	\$165 per hour
Project Surveyor	\$185 per hour
Design Engineer	\$135 per hour
Draftsperson	\$105 per hour
Project Assistant	\$90 per hour
2-Man Survey Crew	\$375 per hour
3-Man Survey Crew	\$550 per hour
GLASIR (IRRIGATION)	
On-Site Consulting / Public Agency Coordination	\$150 per hour
Irrigation Designer	\$125 per hour
Plan Check	\$125 per hour
FBA ENGINEERING (ELECTRICAL ENGINEERING)	
Principal / Project Director	\$250 per hour
Associate / Project Manager	\$175 per hour
Construction Support	\$150 per hour
Electrical Designer	\$120 per hour
CAD / BIM Designer	\$100 per hour
Technical Typist	\$60 per hour

Charges for sub-consultant services are billed at cost plus a 15% coordination fee.

REIMBURSABLE EXPENSES

When incurred, the following project expenses will be billed at cost plus 15% administrative fee in addition to the above professional services fee:

- Printing, plotting, copying, scanning, photography, graphic expenses
- Delivery, shipping, and handling of documents
- Permits, plan check, and inspection fees
- City business license
- Soils testing

Billings for all time and materials and contract extension work shall be in accordance with the level of work performed based on the categories listed above.

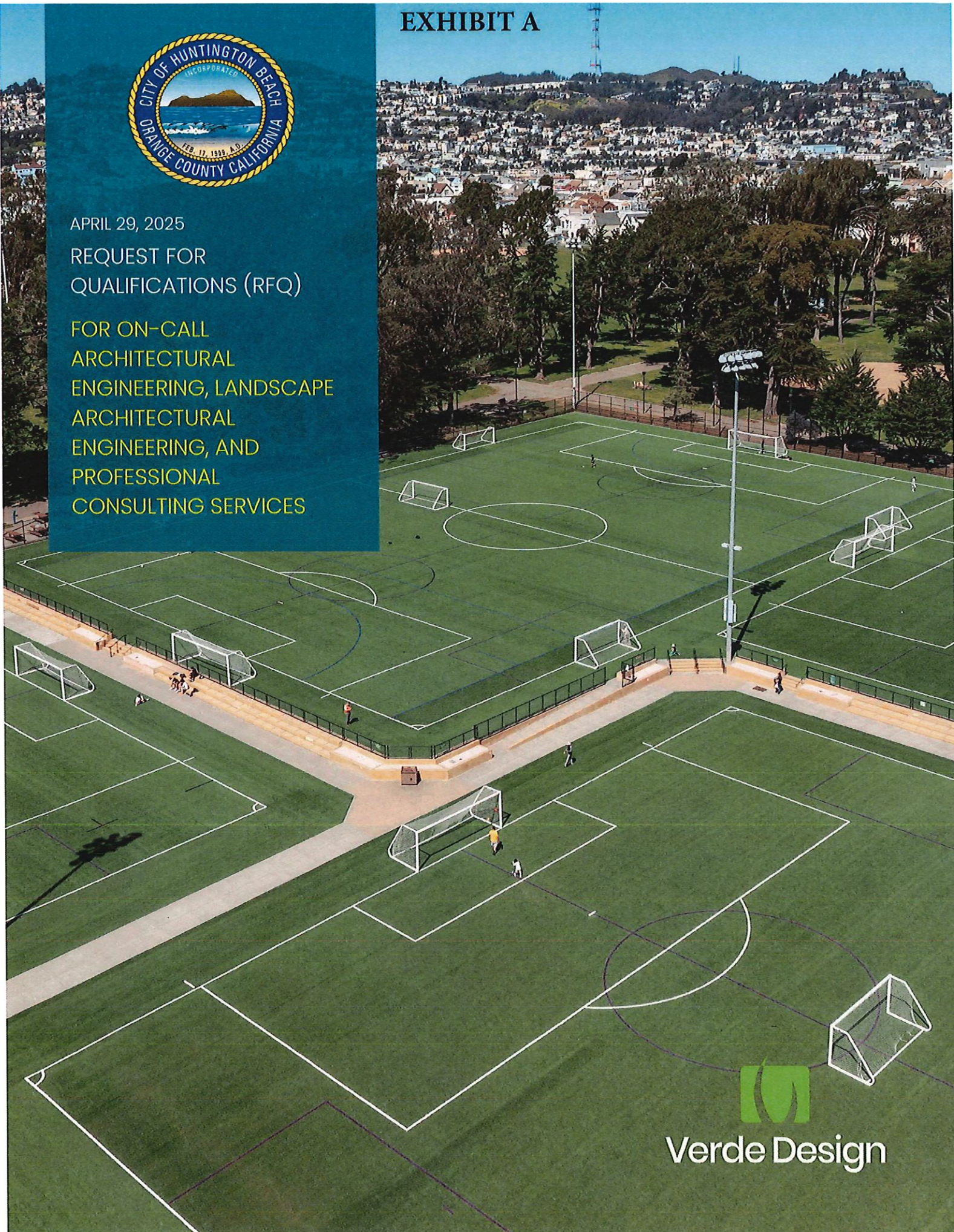

EXHIBIT A

APRIL 29, 2025

REQUEST FOR
QUALIFICATIONS (RFQ)

FOR ON-CALL
ARCHITECTURAL
ENGINEERING, LANDSCAPE
ARCHITECTURAL
ENGINEERING, AND
PROFESSIONAL
CONSULTING SERVICES



Verde Design



Uptown Family Park, City of Paso Robles

TABLE OF CONTENTS

TAB A

VENDOR APPLICATION FORM AND COVER LETTER.....P3

TAB B

BACKGROUND AND PROJECT SUMMARY SECTIONP6

TAB C

METHODOLOGY SECTIONP9

TAB D

STAFFINGP16

TAB E

QUALIFICATIONSP24

TAB F

FEE PROPOSAL (*SUBMITTED SEPARATELY PER THE RFQ*)



April 29, 2025

City of Huntington Beach
2000 Main Street, Huntington Beach, CA 92648
Attn: Cody Hernandez, Buyer



SUBJECT: REQUEST FOR QUALIFICATIONS (RFQ) FOR ON-CALL ARCHITECTURAL ENGINEERING, LANDSCAPE ARCHITECTURAL ENGINEERING, AND PROFESSIONAL CONSULTING SERVICES

Dear Mr. Hernandez and Members of the Evaluation Committee:

We thank you for considering our proposal for the City of Huntington Beach's (City) RFQ for On-Call Architectural Engineering, Landscape Architectural Engineering, and Professional Consulting Services. Verde Design, Inc. stands as a leading provider of comprehensive and integrated landscape architecture and civil engineering services. Our specialization encompasses the planning, design, and construction administration of public recreational and athletic facilities. We collaborate closely with cities, counties, and parks and recreation districts to develop outstanding outdoor environments that improve the quality of life for our clients' communities. We are a committed team of 51 experienced professionals dedicated to improving recreational facilities, athletic programs, and the unique environments that enhance neighborhoods and community areas. We represent a team of talented professionals, including myself, Chris Giannini, as associate and senior project manager, and Mark Baginski as project principal, to help you achieve your goals. Our firm boasts a strong history, having successfully completed over 750 projects for more than 110 public agencies, including over 45 successful on-call partnerships. Many of these projects align closely with your anticipated initiatives. The office that will be providing services is located at 3685 Main Street, Suite 350, Riverside, CA 92501.

Experience with Similar Projects: We proudly uphold an extensive portfolio of successful public recreational facilities, demonstrating our proficiency in transforming master plans into tangible construction projects. Our efforts prioritize health and wellness, fostering an environment conducive to both educational pursuits and recreational activities. This wealth of expertise has reinforced our distinguished reputation for crafting designs that are not only visually striking but also functional for public interaction, all while honoring the historical and cultural significance of the communities we serve. We possess a profound understanding of how to create community facilities that cater to the recreational needs and interests of the population, ensuring that these spaces are sustainable, operationally efficient, and visually appealing.

Sharing Our Knowledge: We will act as an integral part of your team, focusing on fostering robust relationships with your staff by attentively considering your evolving objectives and executing projects that fulfill them. Recognizing that proactive communication is essential for timely and budget-conscious project delivery, our team will be accessible and responsive during the entire process and even after project completion. By selecting Verde Design, you are securing a dedicated advocate and a partner invested in the enduring success of your projects.

We trust that this submission will enhance your comprehension of our dedication to excellence in design and exceptional service for our clients. We are eager to have the chance to create something remarkable within the Huntington Beach community, all while adhering to the established timeline and budget constraints. In my capacity as both associate and senior project manager, I, with the assistance of Mike Salazar, project manager, will be your main point of contact and will remain actively engaged throughout the entire process until your project is successfully completed. The proposal price will be valid for a period of at least 180 days. We acknowledge Addendum No. 1 and 2.

Sincerely,
VERDE DESIGN, INC.

Chris Giannini, RLA, Associate & Sr. PM (City contact) | Mark Baginski, RLA, LEED AP, Principal (Authorized Signature)
951.221.3142 | chrisg@verdedesigninc.com | 408.850.3411 | mark@verdedesigninc.com
3685 Main Street, Suite 350, Riverside, CA 92501 | 3685 Main Street, Suite 350, Riverside, CA 92501



REQUEST FOR PROPOSAL
VENDOR APPLICATION FORM

TYPE OF APPLICANT: ☒ NEW ☐ CURRENT VENDOR

Legal Contractual Name of Corporation: Verde Design Inc.

Contact Person for Agreement: Mark Baginski

Corporate Mailing Address: 3685 Main Street, Suite 350

City, State and Zip Code: Riverside, CA 92501

E-Mail Address: mark@verdedesigninc.com

Phone: 408.850.3411 Fax: 408.985.7260

Contact Person for Proposals: Chris Giannini

Title: Associate, Senior Project Manager E-Mail Address: chrisg@verdedesigninc.com

Business Telephone: 951.221.3142 Business Fax: 408.985.7260

Year Business was Established: 2007

Is your business: (check one)

☐ NON PROFIT CORPORATION ☒ FOR PROFIT CORPORATION

Is your business: (check one)

☒ CORPORATION ☐ LIMITED LIABILITY PARTNERSHIP
☐ INDIVIDUAL ☐ SOLE PROPRIETORSHIP
☐ PARTNERSHIP ☐ UNINCORPORATED ASSOCIATION



Names & Titles of Corporate Board Members

(Also list Names & Titles of persons with written authorization/resolution to sign contracts)

Names	Title	Phone
Mark Baginski	Principal/Secretary	408.850.3411
Devin Conway	Principal/Vice President	408.850.3420
Derek McKee	Principal/President	408.850.3410
Nance Cronin	Principal/Treasurer	408.850.3405
Antonia Conway	Board Member	408.884.9585

Federal Tax Identification Number: 20-897-4203

City of Huntington Beach Business License Number: N/A
(If none, you must obtain a Huntington Beach Business License upon award of contract.)

City of Huntington Beach Business License Expiration Date:

TAB B BACKGROUND AND PROJECT SUMMARY SECTION

FIRM PROFILE

VERDE DESIGN FIRM INFORMATION

Type of Legal Entity: S Type Corporation and Certified Small Business Enterprise

Years in Business: 18 years

Number of Employees: 51

Main-Contact: Chris Giannini, RLA, Associate, Sr. PM, 951.221.3142 | chrisg@verdedesigninc.com

Office Providing Services: 3685 Main Street, Suite 350, Riverside, CA 92501

Website: www.verdedesigninc.com

ABOUT VERDE DESIGN

Verde Design is an integrated landscape architecture and civil engineering firm specializing in award-winning recreational and athletic-focused spaces. We provide our clients with comprehensive planning, design, and construction administration services, and focus on serving cities, counties, and parks and recreations districts.

We have partnered with over 110 public agencies to date, and have completed more than 750 public facility projects for clients. Projects have ranged from small neighborhood pocket parks to destination sites, including expansive community parks and sports complexes. We staff our projects with a team of creative problem solvers, and draw upon our in-house site planning, grading and drainage, planting, and irrigation design expertise, to provide solutions that meet or beat project schedules and remain within the established project budgets.

BRIEF HISTORY

In 2007, Derek McKee and Devin Conway, both veterans of the A/E/C industry, purchased key assets of a former firm and founded Verde Design, a certified SBE. Our leaders have crafted a culture rooted in sound practice, focused on sustainability, and staffed with people who care about enhancing their communities. Since our founding in Santa Clara, we expanded operations with additional offices in Folsom, Santa Rosa, and Riverside.

18 YEARS IN BUSINESS
AS A CERTIFIED SMALL BUSINESS ENTERPRISE

150 PARK & PLAYGROUND PROJECTS FOR PUBLIC AGENCIES

110 PUBLIC AGENCIES PARTNERED WITH OVER THE LAST 18 YEARS IN BUSINESS

FIRM PRINCIPALS



OUR PROJECTS & SERVICE TYPES

- Landscape Architecture
- Civil Engineering
- Master Planning
- Facility Assessments
- Management Plans/Studies
- Feasibility Studies
- Schematic Design
- 3D Modeling
- Community Facilitation & Outreach
- Construction Documentation
- Irrigation Design & Audits
- Cost Estimating
- New & Replacement Athletic & Rec Fields
- New & Replacement Playgrounds
- All-Inclusive Playgrounds
- Bike/Skate Parks
- Sports Field/Park Lighting
- Tennis/Hard Courts
- Pre-Fab Buildings for Restrooms, Concessions, Maintenance, and Storage
- Plazas/Entry Elements
- Stormwater Facilities
- SWPPP & SWMOC



VERDE DESIGN BY THE NUMBERS

WE ARE PROUD
THAT OVER 96%
OF OUR BUSINESS
COMES FROM
REPEAT CLIENTS

96%



51 TALENTED
PROFESSIONALS

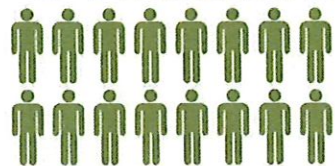

750

ATHLETIC FACILITY PROJECTS
COMPLETED IN THE LAST 18
YEARS IN BUSINESS



4

SANTA CLARA
FOLSOM
SANTA ROSA
RIVERSIDE
BRANCH OFFICES

*OFFICE PROVIDING SERVICES:
RIVERSIDE OFFICE: 3685 MAIN ST,
SUITE 350, RIVERSIDE, CA 92501



**110 PUBLIC
AGENCIES**
PARTNERED
WITH IN
THE LAST 18
YEARS
IN BUSINESS

**\$750 MILLION IN PUBLIC
PROJECTS COMPLETED**

18

**YEARS IN
BUSINESS**
AS A CERTIFIED
SMALL
BUSINESS
ENTERPRISE

42

**PROJECT DESIGN
AWARDS RECEIVED**

400

SYNTHETIC TURF FIELDS

DESIGNED FOR
OUR PROJECTS/CLIENTS



Verde Design possesses a wealth of experience in the design of athletic and recreational facilities, having successfully completed more than 400 projects involving synthetic turf, which includes over 100 synthetic turf field replacements. Our comprehensive understanding of these turf systems, combined with our technical proficiency, has established us as a premier specialist in synthetic turf across California.

The expertise of our project team encompasses a thorough knowledge of the necessary products, drainage solutions, maintenance protocols, and the management of program usage that synthetic turf fields demand. We are committed to equipping you with the essential information required to make well-informed choices regarding the selection of products for your fields.



UNDERSTANDING OF THE CITY

Verde Design understands that the City of Huntington Beach (City) is built out and new development is limited. As existing facilities age, renovation, re-imagining and redevelopment of public spaces is critical to meeting the community's needs. The City is seeking qualified design consultants to submit qualifications to be selected to provide consulting services on an "on-call" basis for projects to be determined during the three-year term of the contract which has an optional one-year term. The City will issue task orders for each project based upon the scope of services, qualifications, work schedule and reasonableness of the fee. For task orders greater than \$50,000, the City will solicit qualifications from two or more consultants. In the case of projects where the consultant cannot provide all services internally, we may sub-contract with appropriate firms. The scope of work in general terms will include the following.

- Kick-off & progress meetings
- Preliminary plans and design
- Entitlements/permits
- Construction documents (plans, specifications, cost estimates and bidding documents)
- Technical reports and analysis of varying types
- Bid assistance
- Construction support

Verde Design is submitting under the Landscape Architectural Engineering Services category. We understand that the objective is to provide the City with experienced, professional personnel to provide high quality, timely services and documents for bidding and construction. The types of services include the following.

- Provide landscape, architectural, planning and design services primarily for existing City parks, facilities, community centers, clubhouses, tenant improvements, ADA modifications and park developments.



UN Plaza, City of San Francisco

- Landscape architecture services throughout City medians and public spaces
- Prepare sketches, renderings, and materials boards providing alternative architectural concepts, designs, and options that can be applied to project requirements.
- Prepare in AutoCAD or Revit, 24x36 inch construction drawings for bidding and archival purposes, providing code requirements, floor plans, ceiling plans, roof plans, elevations, walls, material schedules, door and window schedules, and details. A full-size set at design stage will be provided with electronic file in PDF format, and in AutoCAD or Revit format.
- Provide technical specifications in MS Word format, for materials and methods to be incorporated into the City's Standard Supplemental Master Specifications.
- Prepare Architect's/ Engineer's cost estimates.
- Provide support during construction of projects.
- Prepare as-builts and provide electronic file in PDF format, and in AutoCAD or Revit format.
- Additional services such as assistance with environmental assessments, material testing, civil and soils engineering and building architecture may also be provided through the use of subconsultants or in-house personnel.



APPROACH AND METHODOLOGY

IMPLEMENTATION PLAN

PROJECT MANAGEMENT

Our approach to project management starts with the allocation of a highly skilled and experienced team tailored to each project. Chris Giannini will act as the senior project manager and your main point of contact, while Mark Baginski will take on the role of principal-in-charge. Both professionals bring over thirty years of experience in designing, managing, and supervising a diverse range of projects that align closely with the City of Huntington Beach's (City) upcoming projects.

Mark and Chris have collaborated on numerous projects focused on the development of neighborhood, community, and regional park facilities, encompassing both new constructions and renovations. Their work spans a wide array of enhancements, including inclusive playgrounds, fitness stations, splash pads, and various sports courts, as well as amenities like picnic areas, amphitheaters, and dog parks. They have also designed aquatics centers, running tracks, and fields for baseball, soccer, and cricket, while ensuring the integration of essential infrastructure such as sports lighting, irrigation systems, and efficient grading and drainage solutions tailored to client needs. Additionally, their partnership extends to the creation of educational plazas and collegiate athletic facilities, showcasing their dedication to improving community spaces through thoughtful design and landscaping.

The effectiveness of our collaborative approach lies in the commitment of our key personnel, who will be engaged with the project from its inception to its completion.

We prioritize fostering strong partnerships, ensuring that our clients feel comfortable reaching out with inquiries or seeking



John D Morgan Park, City of Campbell, 2022 American Public Works Association (APWA) Honor Awards Recipient (Env/Parks < \$2M)

our insights. This relationship-driven service promotes transparent and candid communication throughout the duration of the project and beyond. We will ask you about your preferences regarding communication method and frequency during the project and will tailor our communication style to suit your preferences. Documents like the Basis of Design Document, Design Log, and Submittal Book will help us communicate ideas, track inquiries and document design progression, which will help you manage the project from the City side and will help you communicate project progress to your team.

The Basis of Design document will provide a detailed summary of our understanding of the conceptual design. The Design Log documents the questions and decisions that arise during the design phase so that when the project is complete, a summary of specific decisions that shaped the final design can be easily referenced. These documents will be included in the Submittal Book along with an updated estimate of cost, plan and spec submittals and proposed site furnishing images that extends from conceptual design through the final CD submittal. These





South Sunset Fields, San Francisco

resources, among others, are integral to our team's internal and external processes, facilitating the communication of critical information throughout the project lifecycle.

In the process of preparing progress submittals, we find it advantageous to convene with the design team to collectively examine the plans and specifications. This collaborative approach fosters effective communication among team members, enabling us to identify and rectify any gaps in the plans while minimizing ambiguities. To facilitate this teamwork, we have invested in a variety of user-friendly and interactive tools that enhance collaboration with our staff, partners, and clients. One of the primary tools we employ for our internal Quality Assurance / Quality Control measures is Bluebeam Revue, which we utilize consistently for plan review, document plan revisions and managing agency approval processes. We are also able to share Bluebeam studio sessions with the client, if desired, so that real-time plan review can be done by the City as well. These redlined documents can be shared as pdf

files with the City to document the plan review process for all parties. Furthermore, we are equipped to participate in design charrettes through online platforms or in-person with the City and other Stake Holders.

SOLICITING AND DOCUMENTING VIEWS OF INTERNAL AND EXTERNAL STAKEHOLDERS

There are various definitions of "stakeholder." We begin by verifying who our stakeholders are and understanding their relationship with the project and the typical approach the City has used before. We have approached stakeholder input in various ways. Sometimes, with smaller groups, it can be as simple as one in depth meeting. Larger groups, especially when they include community groups or special interest groups, may require several progressive, outreach meetings that start with general project information and end with finalized conceptual planning based upon stakeholder input. We sometimes also prepare project documents, questionnaires, support images and graphics that are used in an online platform that allows stakeholders



& the local community to conveniently provide their input virtually and conveniently. Just as with live meetings, we then take that input and summarize it and put it into easy to read and understand formats and graphics to document the outreach process. These summaries also demonstrate to the stakeholders that they have been heard and that their input was integrated into the development of the project. This information then serves as our design directives that we use to inform our design process and ultimately to develop the final project design.

SCOPE OF WORK

DELIVERING SERVICES/PROJECT APPROACH TO WORKING WITH THE CITY

Verde Design believes that the key to developing successful projects begins with a simple, but clear, philosophy, **Investigate, Listen, Understand, and Recommend**. These are the core elements of our project approach. Beginning with our initial kick-off meeting with City staff, we will learn more about the proposed project(s) and better understand your goals. This framework is critical to ensure consistent and clear communication is established between our team and City staff. Our desire is to build rapport with our clients. We want to become trusted partners as we work with you and for you on your projects.

Investigate - The first step to the success of a project begins with a solid investigation. We will review existing documents and plans. We will conduct a site visit with client staff to understand and analyze the existing conditions of the facilities. This will ensure that we fully understand the projects' parameters and constraints, as well as the existing site conditions and existing challenges. This site analysis effort will be utilized throughout the projects, enabling educated and effective decisions to be made at the beginning of the design phase and throughout the project design.



Kaiser Permanente Sports Village, City of Bakersfield

Listen - A key element to project success, or any relational success for that matter. We emphasize the importance of listening to all project stakeholders' concerns and desires. Our team will provide options and incorporate guidance provided by our client and other stakeholders, including maintenance and operations staff, user groups, advisory bodies, and members of the community. The result of our focus on listening is a cohesive team that works together on a shared path of understanding with client goals in mind, resulting in smooth-running projects.

Understand - As we mentioned, we use all information available to develop design solutions that respond to our clients' project needs, including site constraints, client staff direction, community feedback, and the allocated budget. We document our understanding of the input and design process by providing you with a Basis of Design Document. This document serves as a summary of the input we have received and states what we have heard and what our understanding of the design directive is. We list all aspects of the project design in detail so that you can review and comment on it to ensure that we have the same understanding and expectations.





Kay Sakamoto Park, City of Roseville

Recommend – Using our clients’ clear and approved concept, we will render the project’s vision into a complete, biddable set of construction documents. The Verde Design team will draw upon past successes with our extensive recreational projects, and knowledge of recreational and athletic facility design and construction to seamlessly facilitate the construction document phase. With most of our projects being constructed, our staff are also well experienced in supporting our clients through bidding and construction phases.

QUALITY ASSURANCE/QUALITY CONTROL (QA/QC)

Our dedication to quality control throughout the life of a project is one of the ways we establish trust that leads to long-term relationships with our clients: We are proud of the fact that over 96% of our business comes from repeat clients. Our internal Quality Assurance (QA)/ Quality Control (QC) reviews address design, biddability, constructability, compliance with local/state codes, and project requirements.

Our QC begins with the design phase and continues throughout a project’s life. During the design phase, we will review the content

of the schematic design graphics and support elements. The review at this stage is not technical, but quality control reviews the design to verify community and staff comments are included or rectified, spelling, as well as graphic clarity.

As we develop construction documents, we have a licensed professional who is not part of the project team provide a ‘fresh eyes’ review of the documents, in addition to the reviews by the principal-in-charge and the project manager. We perform internal redline reviews, incorporate revisions, and review all client comments prior to submitting the documents to you.

We review the submittal packages one week prior to our submittal date and again during the City review period. During submittal review meetings with City staff, we will share our comments and jointly decide how to address each of them. As part of our internal review process, we request draft submittals from all team consultants one week prior to the submittal date. We review their plans, comment on their materials, coordinate improvements between all team members, and return them for updates as needed before we incorporate their materials into our submittal package to you.



TAB C

METHODOLOGY SECTION

Another aspect of our quality assurance process is our multi-disciplinary firm. We have licensed landscape architects, civil engineers, and irrigation designers working together on the design and integration of the drainage, utilities, grading, materials, paving, layout, planting, and irrigation. Our staff will develop the project with systems designed together, creating a more efficient and effective product.

Upon your request we can provide our internal redline pdf drawings with each submittal that will outline comments and items we have seen and have addressed prior to our submittal. We can also provide City staff comments and documents that were provided as part of the city's review process with what their status is and how they were resolved. Each submittal includes priority items such as cost estimate progress, plan updates, specifications, basis of design document and the design log which tracks questions, answers or outstanding items that came up since the last submittal. All team members help update this report for each submittal. At each submittal, we also have a meeting with City staff to present the submittal package in which the progress report is essentially the meeting agenda.

The goals of the Verde Design QC/QA process are to ensure that the project is bid within the stated budget, that the documentation package is clear and free of ambiguity so that it can be properly priced by a group of qualified bidders, and that the improvements can be constructed in accordance with the design intent.

HOW WE CONTROL SCHEDULING

Verde Design employs 51 professionals with a variety of experience and expertise that can be utilized to complete or assist with any project. The variety of work completed



Fair Oaks Park, City of Sunnyvale
2022 APWA Honor Awards Recipient (Env/Parks \$5M-\$25M)

by our firm allows us to intelligently respond to the needs and design services that may be required for your anticipated projects. We strive to provide problem-specific solutions by matching the personal and professional qualities of the individuals on our team to best serve the project's needs.

Project schedules are a critical aspect of all projects outlining tasks, milestones, and deliverables. When the schedule is being developed, we develop our internal staffing plan and workload schedule. Communicating and coordinating large staffing needs for a project is done internally in our weekly production meetings. If a project is going to require more staff than one project team can complete, we look at additional staff support or overtime to meet delivery schedules.

At the start, we will meet with you and your project team. We will review your overall schedule constraints, identify critical path items, set initial milestones, and then prepare a draft master project schedule for further discussion. This schedule will include such items as submittal deadlines, dates for review/presentation meetings, community/





Noe Valley Town Square, City of San Francisco

governing body milestones, agency review, etc. As the schedule is refined and dates are set, we will make staffing assignments within Verde and arrange internal workloads to meet your deadlines. As the lead consultant, we will also be carefully coordinating the work of team consultants to ensure that their work is completed on schedule.

PREPARING BUDGETS AND ESTIMATES

METHODOLOGY

Good budgeting and estimating begin with developing a clear project program, prioritizing the program elements, and aligning them with your expressed budget. We begin each project by developing cost estimates based on the known information and program. We work with the client to determine the revisions to the program throughout each submittal to maintain the accuracy of project costs within budget. Our estimates are developed by our staff and team, and we start them early during the design phase.

Verde Design is actively working throughout California and understands that market conditions vary. Our team adjusts to local market conditions to provide the most

accurate estimate possible. While we are seeing some easing of inflationary influences, there is uncertainty in future markets relative to potential tariffs on foreign goods which will cause some escalation in selective products.

Our strategy to overcome these challenges is a multi-faceted approach to cost estimating, including utilizing relationships in the contractor community to understand current pricing and preparing additive alternates to our project plans to cushion against market dynamics.

CONTINGENCIES UTILIZED

Verde Design utilizes the following contingencies as a starting point for most projects:

- Survey, Permits, Traffic and SWPPP 3%
- Bonding 2%
- Mobilization/Project Management 12-15%

We have also carried other contingencies as determined by the project and bidding environment:

- Escalation +/- 5%
- Bidding Contingency +/- 5-10%
(Based on the number of bidders received)





Edgewater Park, City of Foster City

Our pricing approach includes materials, labor, and markups based on a proven format we have honed over years of successful project bidding. The trickiest part of cost estimating is the dynamics of the market at the time of bid versus when the plans are completed, which is usually months before in some cases. Adding a bid contingency is good if there is a lag between the final estimate and bidding.

STANDARD ESTIMATING MANUALS USED AS REFERENCE

Verde Design does not rely on manuals or guidebooks for estimating. We have found these to be unreliable. We focus on getting real costs from contractors, suppliers, and manufacturers. We communicate with specialty trades to understand asphalt, concrete, electrical, fencing costs, etc. We can demonstrate the accuracy of this approach through our historical bid results summary.

SPECIFIC TASKS IN THE SCOPE OF WORK

As previously noted, it is our intent to build rapport with City staff with the goal of developing efficient and effective lines of communication. The initial expectation from City staff is to provide information. Information

about communication preferences, information regarding expectations from the design consultant, information regarding the City's design guidelines and design preferences and processes and lastly, information about the project site. This would include assistance in locating existing record drawings. We would also like to hear from maintenance staff regarding challenges on existing sites or long-term maintenance preferences.

Once we are in the design phase, we will look to the City to collect and provide input from City staff relative to design options as well as provide meaningful input on both conceptual designs and construction drawing, milestone submittals as well as calendar availability relative to project meetings or site visits. If there are community meetings, we see the City staff as partners and co-facilitators in some respects depending upon the complexity of the project.

As the design consultant, it is our role to provide you with status reports on the project related to budget, schedule, and design decisions. We will provide you with appropriate plans, specs and estimates for your review based upon input we have been provided.



FIRM STAFFING AND KEY PERSONNEL

To help the City of Huntington Beach (City) accomplish their future goals and projects, we have hand-selected a team with specialized public recreational facility knowledge, problem-solving experience, and a history of successfully working together on an extensive list of projects for numerous public agencies with similar scope to the City's anticipated projects. We recognize the importance of continuing to build and develop new and ongoing relationships throughout your project, and are committed to maintaining a consistent project team. Please see below for a team organizational chart. The subsequent pages will provide insights into our proposed as-needed subconsultant team, including overviews of their firms. Furthermore, we have included the resumes of key members from Verde Design at the conclusion of this section, detailing their project experience, qualifications, credentials, and specific roles they will provide for your projects.

PROJECT TEAM ORGANIZATIONAL CHART



Mark Baginski, RLA, LEED AP

Principal-in-Charge

408.850.3411

mark@verdedesigninc.com

Years with Firm: 16

Office Location: Santa Clara/
Riverside

Chris Giannini, RLA

Associate, Sr. PM/ Contact

951.221.3142

chrisg@verdedesigninc.com

Years with Firm: 6

Office Location: Riverside



Michael Salazar, RLA

Project Manager

951.266.5221

mikes@verdedesigninc.com

Years with Firm: 3

Office Location: Riverside



Giovani Aguirre, RLA

Project Designer

951.266.5423

gio@verdedesigninc.com

Years with Firm: 3

Office Location: Riverside



Jamie Wallis, PE, QSD/QSP

Sr. Associate, Civil Engineer

408.850.3425

jamie@verdedesigninc.com

Years with Firm: 10

Office Location: Santa Clara/
Riverside



Verde Design Production Staff



SUBCONSULTANT TEAM

SUBCONSULTANT COORDINATION

At the beginning of a project, we review the project scope for consultant needs, including verifying with the City if there are any particular consultants that may have recent experience and knowledge of their particular project site we should consider. We establish a scope of work with the team, and coordinate it with the City.

Part of that scope is the timeline and attaining buy-in from our proposed list of subconsultant team members on the schedule and deliverable dates. As the design process evolves and documentation progresses, the Verde Design staff works with subconsultants to ensure that our team is using the proper AutoCAD (CAD) background files and specification templates. We will work to get submittals from subconsultants five (5) days before they are due so that we can review and redline for content and clarity prior to the official submittal to the City.

This process also continues during the City review of the submittal. After receiving any City (or public agency) comments from the submittal, the Verde Design project team will have a design team meeting to coordinate the project design, including client comments, with the subconsultants, and coordinate the work required toward the next submittal. We regularly have project and team meetings to coordinate and adjust items to avoid any conflicts later during construction. Additionally, we review each subconsultants' deliverables to ensure the programmatic needs of the project are captured.

CL SURVEY

As-Need Service: Survey

CL Surveying & Mapping (CL Survey) is a local, SBE/DBE/MBE professional land survey firm that focuses exclusively on public works projects for design engineering firms, general contractors and municipalities. CL Survey's owners, Lam Le and Dan Calvillo, are licensed

professional land surveyors, have over 45 years of combined experience in the survey industry, and are involved in every project.

CONVERSE CONSULTANTS

As-Need Service: Geotechnical Engineering

Converse is a consulting engineering firm that provides geotechnical engineering, engineering geology, soils and materials testing and inspection, environmental services, water resources management, and occupational and environmental health/safety services. The firm's experience and dedicated team of professionals partners with clients to provide innovative solutions on projects since 1946. Its past, present, and future are founded on the principles of providing high-quality service in a timely and cost-effective manner.

DAHLIN GROUP

As-Need Service: Architecture

Dahlin is a diverse architecture and planning practice of 150+ multicultural professionals working with developers, municipalities, and private clients. Since 1976, Dahlin has been committed to excellence in design – best demonstrated through their long-term client relationships and by their award-winning, financially successful, and sustainable design solutions. For your Park, Facilities, and Recreation Master Plan, Dahlin will be providing assessments of the existing recreation buildings and will develop conceptual diagrams and budgets for future and/or renovated recreation buildings.

FBA ENGINEERING

As-Need Service: Electrical Engineering

Since 1968, FBA Engineering (FBA) has sought consistency and excellence in providing innovative, state-of-the-art electrical, technology and lighting design solutions that match the unique requirements of each of its client each project. FBA provides professional, independent, and innovative electrical engineering via consulting, planning, design and construction documents for projects



TAB D STAFFING

from basic to complex whether local, national or international. Verde Design has partnered with FBA on more than 15 projects from recreational to athletic facility programming.

KIER + WRIGHT

As-Need Service: Civil Engineering

Kier + Wright provides civil engineering and land surveying services for the planning and construction. Our land surveying department produces topographic surveys for use in our own civil engineering plans. Through this coordination with our in-house civil design professionals, our surveying personnel have an in-depth understanding of the user experience, and know how to produce the optimal product showing the desired level of detail for utilization in the design process. In addition to providing these services for our own design work, Kier & Wright's client base includes numerous architects and engineers

who rely on Kier & Wright to provide them with base mapping and design-level topographic surveying for their projects.

WATEARTH

As-Need Service: CEQA

Watearth is your best resource for planning, master plans, modeling, design, and construction support services in disciplines such as Water Resources, Environmental, Green Infrastructure, Hydrology & Hydraulics, Site Design, Stormwater, and Communications in the Federal Government, Industrial, Litigation/Expert Witness, Local and State Government, Private Development, Transportation, Utilities, and Water Districts sectors. Watearth's niche focus allows them to create solutions that elude less specialized firms. With highly accredited senior staff, Watearth is widely considered a leading firm in our disciplines, filling both key sub and prime roles.



Rotary Playgarden, City of San Jose



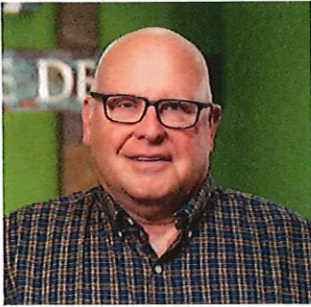

MARK BAGINSKI RLA, LEED AP PRINCIPAL-IN-CHARGE | VERDE DESIGN, INC.

Mark joined Verde Design as a principal in 2008, one year after it was founded. He brings over 30 years of professional experience, and is responsible for project design and management, client relationships, and production of project documents. His projects have included recreational and athletic facilities, including neighborhood and pocket parks with playgrounds, athletic fields and sports complexes, plazas and streetscapes, aquatic facilities, commercial property

development, and corporate campus master planning. Mark's projects have earned several notable awards and distinctions. A key characteristic of Mark's designs is the belief in an overall "big idea." This ensures that our clients' projects benefit from a strong, overall design concept that incorporates their goals and project objectives. Mark's background leading multidisciplinary development teams from the early programming phase through construction management, provides a broad base of experience for his projects.

Education

B.S., Mississippi State University, 1991
B.L.A., Landscape Architecture,
Mississippi State University, 1991
A.A.S., Land Development, State
University of New York at
Cobleskill, 1987

Licenses & Affiliations

CA 4089, Landscape Architect, 1994
LEED Accredited Professional
American Society of Landscape
Architects
Urban Land Institute
Coalition for Adequate School
Housing
American Sports Builders
Association
California Parks and Recreation
Society

PROJECT ROLE

Mark will be your advocate to keep your project on target to meet your goals. He will be responsible for contract administration and oversee design development. As the design development proceeds, he will review all aspects of the project to confirm that all goals are met.

RELEVANT EXPERIENCE

Town of Apple Valley

- Joseph McConnel Jr. Park, Community Park & Athletic Facility (current)

City of Cathedral City

- Dream Homes Park, Community Park & Playground (current)

City of Roseville

- F-51 (Riego Creek Park), Community Park (current)
- Roseville Regional Soccer Complex, Sports Complex (current)
- Gibson Park, Sports Complex (2023)
- F-94 (Kay Sakamoto) Pocket Park & Playground (2021)
- F-101 (North Hayden) Pocket Park (2021)
- F-97 (Jim Gray) Pocket Park & Playground (2019)
- Pistachio Park, Community Park (2019)
- F-95 (Bev Bos) Pocket Park & Playground (2018)

City of San Francisco

- Golden Gate Park Fitness, Community Park (current)
- Kimbell Playfields, Sports Complex (current)
- Crocker Amazon Baseball Fields, Sports Complex (current)
- Noe Valley Town Square, Urban Design (2023)
- UN Plaza, Urban Design (2023)
- Crocker Amazon Soccer Fields, Sports Complex (2023)
- South Sunset Fields, Sports Complex (2022)

City of Sunnyvale

- Community Center Grounds, Community Park (current)
- Lakewood Park, Community Park (current)
- Fair Oaks Park, Community Park (2022)

City of West Sacramento

- Bryte Park, Community Park/Sports Complex (current)
- Recreational Center, Community Park (2024)

Fair Oaks Recreation and Park District, Fair Oaks

- Phoenix Park, Community Park (current)
- Jim Streng Park, Community Park & Playground (2022)





CHRIS GIANNINI RLA

ASSOCIATE, SENIOR PROJECT MANAGER | VERDE DESIGN, INC.

Chris joined Verde Design in 2019 as our Southern California office leader who leads all production efforts. This includes graphics, conceptual and construction drawing efforts as well as meeting preparation and project updates. Chris will provide management for the project, working with the team to attain input from your staff and various agencies involved, develop project programs, as well as direct supervision of drafting personnel, to ensure that you are satisfied and

that the project's goals are met. Chris brings expertise in recreational facility and public park design, public works, high-density housing development, private residential design, commercial development, retail development, streetscape and highway design, and construction management to the Verde Design team. Chris has more than 25 years of experience in the design industry. Over his career, Chris has received multiple project awards from California Parks & Recreation Society (CPRS), American Society of Civil Engineers (ASCE) and American Public Works Association (APWA), which are all organizations he is actively involved in.

Education

B.S., Landscape Architecture,
California Polytechnic State
University, Pomona, 1993

Licenses & Affiliations

CA 4287, Landscape Architect, 1998
American Society of Landscape
Architects
California Parks and Recreation
Society
Coalition for Adequate School
Housing

PROJECT ROLE

Chris will oversee the preparation of schematic design, and construction documents/packages. His responsibilities include consistent QA/QC and design direction of the project. During the startup phase, he will work with Mike and the team to attain input from your staff, develop project programs, and respond to development issues.

RELEVANT EXPERIENCE

Town of Apple Valley

- Joseph McConnell Jr. Park, Community Park & Athletic Facility (current)

City of Cathedral City

- Dream Homes Park, Community Park & Playground (current)
- Downtown Dog Park, Conceptual Plan (2023)
- Panorama Park, Dog Park (2022)

City of Santa Ana

- 1st & Mountainview Park, Community Park (current)
- Chavez Campesino Park, Sports Complex (2022)

City of Burbank

- Brace Canyon Park, Sports Complex (2023)

City of Bakersfield

- Kaiser Permanente Sports Village, Sports Complex (2023)

City of Orange

- Hart Park, Sports Complex (current)

City of Palm Springs

- Whitewater Park, Master Plan (2019)

City of Poway

- Lake Poway Softball Field, Sports Complex (current)

Alvord School District, Riverside

- Norte Vista High School, Athletic Facility (2025)

Coachella Valley Unified School District, Coachella Valley

- Sea View Elementary School, Athletic Facility (2021)

Colton Joint Unified School District, Colton

- Grand Terrace High School, Athletic Facility (2025)





MICHAEL SALAZAR RLA PROJECT MANAGER | VERDE DESIGN, INC.

Mike joined Verde Design in 2022, contributing over 20 years of expertise in the field of landscape architecture. Prior to joining Verde Design, he dedicated his skills to several comprehensive landscape architectural firms. Mike's extensive portfolio includes a wide variety of public and private projects, including master planned communities, mixed-use commercial retail spaces, residential sub-divisions, parks, schools, churches, and streetscapes. Notably, he has overseen projects from the initial proposal stage and conceptual development to the creation of detailed working drawings, ultimately resulting in the thorough management of construction administration.

Education

B.S., Landscape Architecture,
California Polytechnic State
University, Pomona, 2001

Licenses & Affiliations

CA 5166, Landscape Architect, 2006

PROJECT ROLE

Mike will coordinate with Chris and lead in the preparation of graphics, meeting preparation, client needs, and landscape construction documents/packages. Mike's responsibilities include management of projects as well as direct supervision of drafting personnel. He will also be responsible for drafting and other assistance as required to complete all assigned projects.

RELEVANT EXPERIENCE

Town of Apple Valley

- Joseph McConnel Jr. Park, Community Park & Athletic Facility (current)

City of Cathedral City

- Dream Homes Park, Community Park & Playground (current)

City of Santa Ana

- 1st & Mountainview Park, Community Park (current)
- Chavez Campesino Park, Sports Complex (2022)

City of Burbank

- Brace Canyon Park, Sports Complex (2023)

City of Santa Fe Springs

- River Park, Conceptual Plan (current)

City of Poway

- Lake Poway Softball Field, Sports Complex (current)

Oro Grande School District, Oro Grande

- Oro Grande Elementary School, Exterior Educational Facility (2022)

Coachella Valley Unified School District, Coachella Valley

- Mecca Elementary School, Athletic Facility (2022)
- Sea View Elementary School, Athletic Facility (2021)

Los Angeles Unified School District, Los Angeles

- Gardena High School, Athletic Facility (current)

Palo Verde Unified School District, Palo Verde

- Palo Verde High School, Athletic Facility (2020)





GIOVANI AGUIRRE RLA PROJECT DESIGNER | VERDE DESIGN, INC.

Giovani became a member of Verde Design in 2022, taking on the role of project designer. In this capacity, Giovanni plays a pivotal role in various projects, engaging in tasks that range from the initial stages of conceptual design to the preparation of construction documentation, and further extending support during the construction administration phase. With over a decade of professional experience, Giovanni has been involved in a diverse array of project types, including parks, trails, streetscapes, single-family and multi-family residential developments, commercial retail spaces, industrial projects, and environmental planning initiatives, which encompass design guidelines, specific plans, and Greening Studies.

Education

B.S., Landscape Architecture,
California Polytechnic State
University, Pomona, 2013
A.S., Riverside City College, 2008

Licenses & Affiliations

CA 6899, Landscape Architect,
2023
American Society of Landscape
Architects

PROJECT ROLE

Gio will be responsible for design, drafting, and team coordination to help create the best possible product for the client. In this role, he will collaborate with Chris and Mike, beginning with the program development through the construction services. He will manage the construction documentation packaging and files. Gio will also be responsible for all construction cost estimating.

RELEVANT EXPERIENCE

Town of Apple Valley

- Joseph McConnel Jr. Park, Community Park & Athletic Facility (current)

City of Cathedral City

- Dream Homes Park, Community Park & Playground (current)
- Downtown Dog Park, Conceptual Plan (2023)
- Town Square Water Play, Community Park (2023)

City of Santa Ana

- 1st & Mountainview Park, Community Park (current)

City of Burbank

- Brace Canyon Park, Sports Complex (2023)

City of Santa Fe Springs

- River Park, Conceptual Plan (current)

City of Glendale

- Pacific Park, Sports Complex (current)

City of Poway

- Lake Poway Softball Field, Sports Complex (current)

City of Bakersfield

- Kaiser Permanente Sports Village, Sports Complex (2023)

Oro Grande School District, Oro Grande

- Oro Grande Elementary School, Exterior Educational Facility (2022)

Coachella Valley Unified School District, Coachella Valley

- Mecca Elementary School, Athletic Facility (2022)

Palo Verde Unified School District, Palo Verde

- Palo Verde High School, Athletic Facility (2020)

Alvord School District, Riverside

- Norte Vista High School, Athletic Facility (2025)

Colton Joint Unified School District, Colton

- Grand Terrace High School, Athletic Facility (2025)





JAMIE WALLIS PE, QSD/QSP

SENIOR ASSOCIATE, CIVIL ENGINEER | VERDE DESIGN, INC.

Jamie joined Verde Design in 2014 and has developed into recent associate. She joined Derek's team to assist in managing current design projects, maintaining and building client relationships, and overseeing the rest of the production team in many aspects of each project she is involved in. During Jamie's time with Verde Design, she has assisted or managed a variety of projects, including public parks, athletic fields, and school facilities. Jamie also provides stormwater

calculations, stormwater pollution prevention plans, and QSD service to ensure that the new facilities are designed in compliance with stormwater and C.3 requirements, if needed. Jamie utilizes her experience as a former NCAA D1 athlete, and her technical design skills, to produce innovative solutions to unique project issues.

Education

B.S., Civil Engineering, Santa Clara University, Santa Clara, 2013

Licenses & Affiliations

CA C86612, Professional Engineer, 2016

CA QSD/QSP Certification #26164, 2016

PROJECT ROLE

Jamie will support the civil engineering and documentation aspects of the project. She will work with Derek, Daniel, and Jerry to coordinate the engineering and production of construction documents and provide stormwater calculations for the project to ensure compliance with stormwater regulations and C.3 requirements.

RELEVANT EXPERIENCE

City of Foster City

- Edgewater Park, Sports Complex (2024)
- Catamaran Park, Sports Complex (2016)

City of Redwood City

- Hawes Park, Sports Complex (2024)
- Red Morton Community Park, Sports Complex (2016)

City of San Jose

- Tamien Park Phase I, Community Park & Playground (2021)

City of Burbank

- Brace Canyon Park (2023))

City of South San Francisco

- Orange Memorial Park, Sports Complex (2023)

City of Alameda

- Estuary Park Phase II, Community Park (current)
- Estuary Park Phase I, Community Park (2017)

City of Burlingame

- Murray Soccer Field, Sports Complex (2016)

City of Milpitas

- Milpitas Sports Center, Sports Complex (2016)

Los Gatos Union School District, Los Gatos

- Blossom Hill Elementary School, Exterior Outdoor Classroom Area (2023)
- Daves Avenue Elementary School, Exterior Outdoor Classroom Area (2023)
- Louise Van Meter Elementary School, Exterior Outdoor Classroom Area (2023)

Mount Diablo Unified School District, Concord

- Oak Grove Middle School, Athletic Facility & Quad Area (2020)
- Mount Diablo Elementary School, Athletic Facility (2019)
- College Park High School, Athletic Facility (2018)

Pacifica School District, Pacifica

- Cabrillo Elementary School, Athletic Facility (current)
- Ortega Elementary School, Athletic Facility (2024)



FIRM QUALIFICATIONS

Our mission is to provide **excellence in design and outstanding service to our clients**. In our 18 years in business, we have accumulated an extensive portfolio of successful recreational and athletic facilities, partnering with more than 110 public agencies and developing over 45 on-call partnerships, and have completed over 750 recreational and athletic facility projects.

Projects for public agencies have included master plans for community and pocket parks to regional and destination sites, which include a variety of components, but not limited to, natural grass and synthetic turf fields, playgrounds, as well as all-inclusive playground with custom play features and surfaces, bike and skate parks, hard courts, fitness and exercise areas, recreational and passive areas, picnic and BBQ areas, sports field/park/security lighting, park beautification and perimeter fencing/security, irrigation design, and ADA and circulation improvements.

The City of Huntington Beach's (City) RFQ for On-Call Architectural Engineering, Landscape Architectural, and Professional Consulting Services is a submittal that directly aligns with our 18 years of built and proven project experience. Our experienced team will guide the City through a comprehensive programming process, ensuring that all aspects of your projects are thoroughly understood. This will empower the City to make well-informed decisions at each step of the way, ultimately leading to successful outcomes. At Verde Design, we recognize the significance of both the operational and maintenance requirements in any project. We are committed to collaborating with our clients to ensure that these needs are effectively met.

We have demonstrated our ability to consistently play a role with educating communities through community workshops and stakeholder meetings, which allows



Sea Cloud Park, City of Foster City

them to make informed decisions. We have proven experience taking projects from just an idea through community meetings to conceptual design to constructed and completed projects.

Our in-house team of landscape architects and civil engineers will seamlessly integrate plans and specifications into a complete and easily built set of construction documents. The extensive experience we have garnered through successful collaborations with public agencies has led to the development of numerous thoughtfully designed recreational facilities. In many instances, we faced the critical decision of selecting between natural grass and turf fields, ensuring that each choice aligned with the specific needs and preferences of the communities we serve. Many of these facilities have been community and destination sites that receive a high-level of attention, traffic, and use. The sophisticated design concept serves as a catalyst for our team's innovative thinking, guaranteeing meticulous development of your projects with thorough exploration of all available options.

Should our team be selected to collaborate with the City, we will dedicate ourselves to understanding your objectives, preferences, current priorities, and principles in order to ensure a successful partnership. This begins with a shared vision built upon your project goals, and is supported by Verde Design's portfolio of similar work, which can be seen in following pages.



TAB E QUALIFICATIONS

CAPTAIN JOSEPH MCCONNEL JR. USAF PARK, APPLE VALLEY

Verde Design was engaged to deliver design services for a 12-acre community park in the Town of Apple Valley. This site, which had formerly served as sports fields and featured a decomposed granite track, was leased from the local school district and had deteriorated over time. Recognizing its potential, the Town chose this property to apply for Proposition 68 State Grant Funding aimed at establishing a new park. The state subsequently awarded funding to the Town to create a recreational facility that would benefit the underserved community. In response, Verde Design's multi-disciplinary team has developed various conceptual master plan options that align with the allocated budget, and they are currently in the process of preparing the construction drawing.

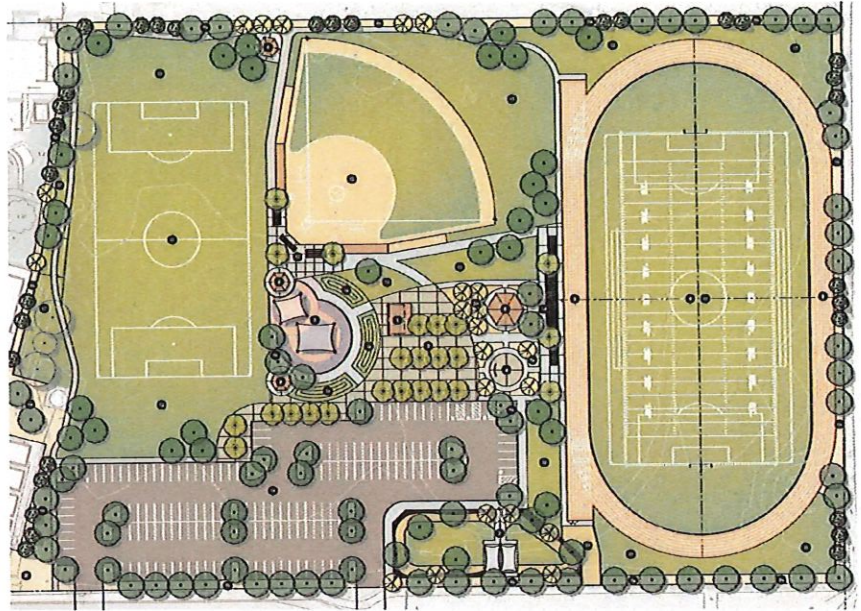

Project Team: Mark Baginski (PIC), Chris Giannini (Sr. PM), Mike Salazar (PM), and Gio Aguire (Designer)

PACIFIC PARK, GLENDALE

Pacific Park is a joint use park shared by the City of Glendale and Glendale USD. Verde Design was hired to provide design services from concept through construction support for the replacement of an existing synthetic turf field. The field suffers from poor drainage and has ADA compliance challenges. Construction drawings are now complete and include drainage improvements that did not require the complete replacement of field base material and drainage. Access compliance has also been addressed and a new netting system has been designed to keep soccer balls out of the adjacent street. The project is currently bidding.

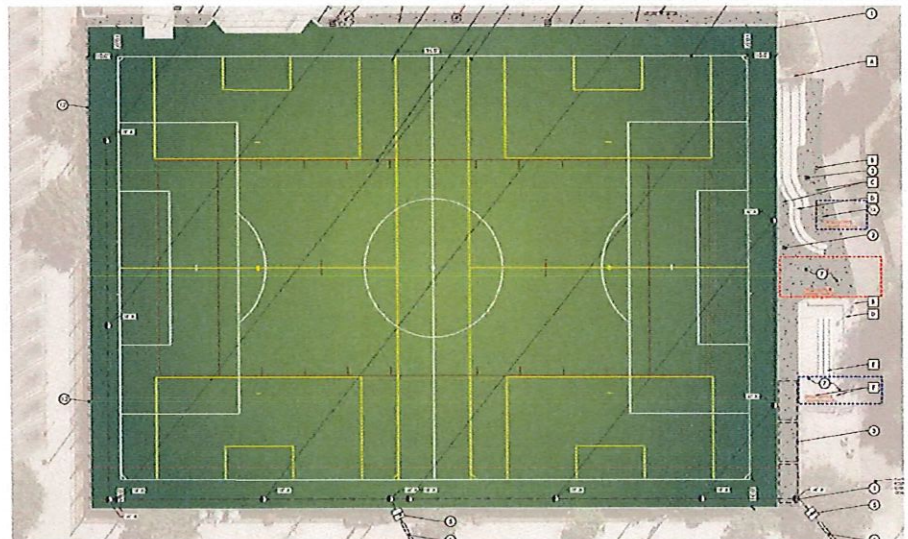

and include drainage improvements that did not require the complete replacement of field base material and drainage. Access compliance has also been addressed and a new netting system has been designed to keep soccer balls out of the adjacent street. The project is currently bidding.

Project Team: Mark Baginski (PIC), Chris Giannini (Sr. PM), and Gio Aguire (Designer)



TAB E QUALIFICATIONS

KAISER PERMANENTE SPORTS VILLAGE, BAKERSFIELD

Verde Design was selected by the City of Bakersfield to deliver conceptual design services for the remaining 95 acres of undeveloped parkland designated for the Kaiser Permanente Sports Village. Our team has developed a comprehensive updated conceptual master plan that encompasses a variety of recreational facilities, including six natural grass football fields equipped with sports field lighting, eight baseball and softball fields, a skate park, and a dog park. Additionally, the plan



features fitness stations, a splash pad, an aquatics center, a community center, a designated play area, restroom and concessions buildings, shade structures, picnic areas, walking trails, parking facilities, and internal roadways. Furthermore, we have developed detailed construction drawings for 35 acres of improvements at the park under Phase IV of this project. This phase includes the development of five football fields with sports field lighting, a restroom and concessions building, enhancements to roadway extensions, and the establishment of two parking areas to accommodate visitors.

Project Team: Mark Baginski (PIC), Chris Giannini (Sr. PM) and Gio Aguirre (Designer)

DREAM HOMES PARK, CATHEDRAL CITY

In 2020, Verde Design undertook the conceptual planning for a 7.5-acre community park situated along the seasonal Whitewater River in Cathedral City. This park is designed to integrate trail connections with the region's master-planned CV Link trail, which serves as an alternative



transportation route for the Coachella Valley. The proposed design encompasses a variety of features, including a multi-use natural grass open space, a futsal court, a central plaza, restroom facilities, two covered play areas, fitness stations, two basketball courts, a dog park, picnic shelters, picnic tables, walkways, benches, and two designated parking areas.

The City has recently engaged our firm to leverage our expertise in order to successfully finalize this project, specifically tasking us with the development of the construction drawings. With these drawings now finalized, the park is actively undergoing construction, and it is anticipated that the park will open in mid 2025.

Program: Mark Baginski (PIC), Chris Giannini (Sr. PM), Mike Salazar (PM), and Gio Aguirre (Designer)



TAB E QUALIFICATIONS

BRACE CANYON PARK, BURBANK

Brace Canyon Park includes existing natural grass sports fields over an existing concrete reservoir, as well as an unpaved walking path. The City has eliminated the use of pesticides in their park programs and seeks to reduce the use of water so they chose to replace the natural grass fields with synthetic turf. The concrete reservoir is roughly 30" below existing grades and was built in the 1940's. Load requirements and access points are critical design criteria that must be followed. Verde Design is currently designing construction drawings for this project.

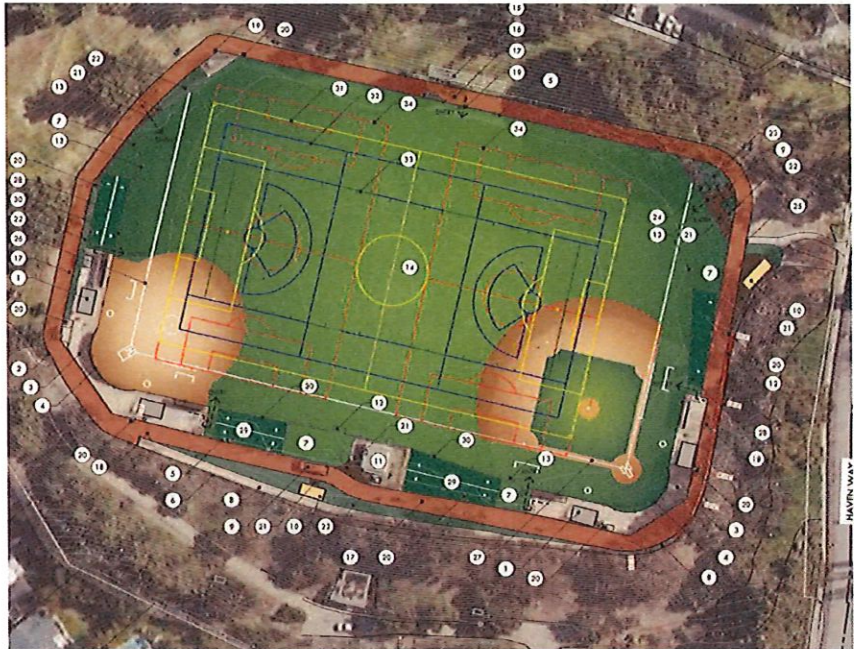

Project Team: Mark Baginski (PIC), Chris Giannini (Sr. PM), Mike Salazar (PM), Gio Aguirre (Designer), and Jamie Wallis (Civil Engineer)

WHITE WATER PARK, PALM SPRINGS

Verde Design provided conceptual planning efforts for a 5.7 acre community park for the City of Palm Springs along the seasonal Whitewater River. The park will be developed with trail connections to the region's master planned CV link trail, Coachella Valley's alternative transportation route.

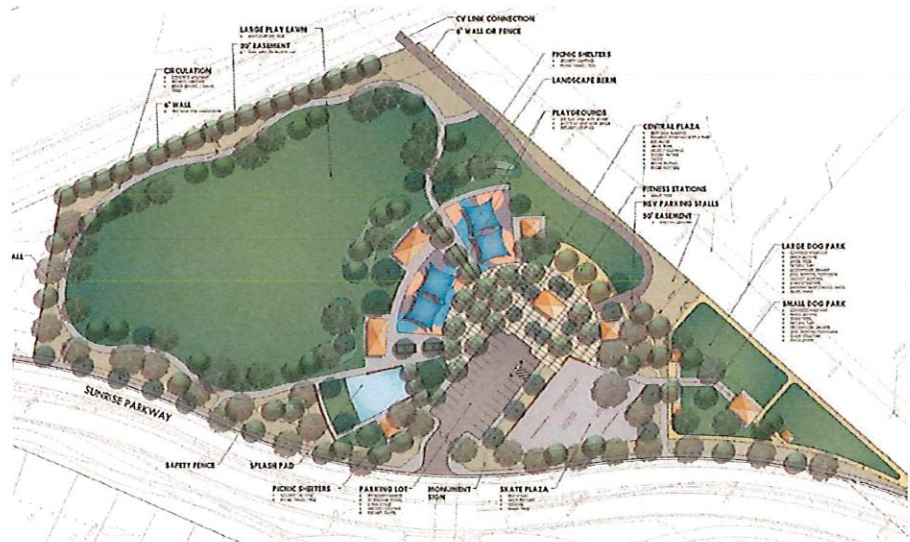

The park design includes natural grass open space, two covered play areas, splash pad, fitness stations, dog park, skate plaza, drinking fountains, picnic shelters, picnic tables, a monument sign, walkways, fencing and benches.

Project Team: Mark Baginski (PIC) and Chris Giannini (Sr. PM)



TABLE QUALIFICATIONS

FAIR OAKS PARK, SUNNYVALE

Verde Design was selected by the City of Sunnyvale for the renovation of Fair Oaks Park, a 15-acre community park located in Northern Sunnyvale, originally built in 1969. The design includes the replacement of the existing natural grass athletic field with synthetic turf for its baseball, soccer, and multi-use fields. This is the City's first park with synthetic turf, which will greatly extend the duration of playtime, particularly during periods of heavy rainfall. Alongside the remarkable fields, we collaborated closely with



both the Magical Bridge Foundation and City staff to seamlessly integrate an all-inclusive playground into the park's overall design. This inclusive approach ensures that individuals of all abilities can enjoy the park's amenities and foster a sense of community. The project also included hardcourt improvements, expanded picnic areas, and circulation and infrastructure improvements.

Project Team: Mark Baginski (PIC), Pat Healy (PM), Qian Huang (Job Captain), Bill Drulias (Director of Design), and Daniel Correia (Job Captain)

GIBSON PARK, ROSEVILLE

Gibson Park is a recreational facility situated in the City of Roseville (City), featuring a variety of sports courts that cater to tennis, pickleball, and basketball enthusiasts. Currently, the park has completed its first phase, which encompasses the construction of nine pickleball courts, a restroom facility, shaded seating areas, and lighting for the sports courts. Additionally, this phase has

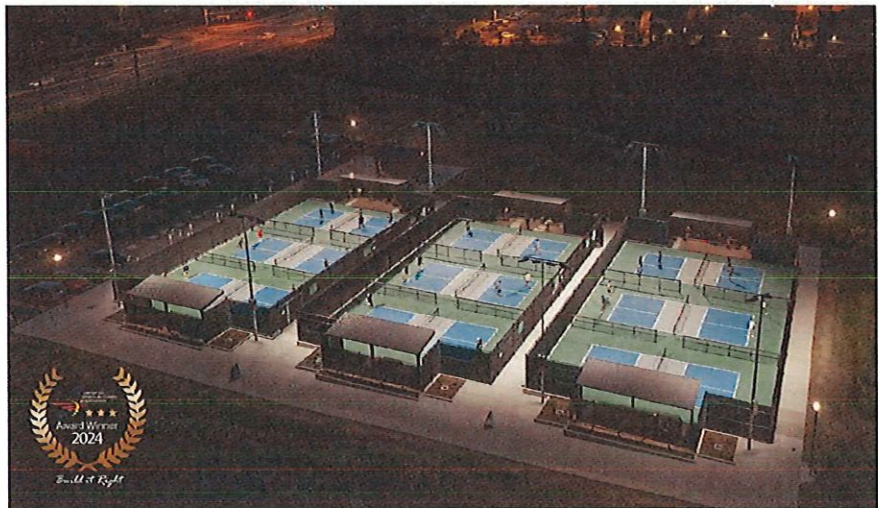

introduced enhancements such as accessible parking spaces and electric vehicle charging stations. Looking ahead, the City plans to expand further with the addition of three more pickleball courts, ten tennis courts, and three basketball courts, alongside improvements in parking, landscaping, and signage. Future developments will also incorporate a walking trail and a fitness loop equipped with fitness stations, promoting a more diverse range of recreational activities for the community.

Project Team: Mark Baginski (PIC), Chris Sullivan (Sr. PM), and Amy LaTomme (PM)



TAB E QUALIFICATIONS

JOHN D MORGAN PARK, CAMPBELL

The City's grand vision has been to provide recreation and learning opportunities to a large part of the population previously underserved and set out to create an all-inclusive play area within the mature John D Morgan Park. The City engaged the PRC and established an Ad Hoc subcommittee to lead the design process. Community engagement was integral in developing the park site through several workshops and lead to the 'Play in the Trees' theme and play features.



The existing site was well established but working within the existing forested site and underground root systems required an adept team to keep the project moving in a timely efficient process. The site also included underground utilities within easements that were protected in place during construction but required a team effort from manufacturer to installer to avoid field conflicts. The playground amenities allow users of all levels to play side by side without barriers and the introduction of a picture exchange communication board (PECS) for non verbal park users. This may be the first installation of a PECS board in a public park in northern California.

Project Team: Derek McKee (PIC) and Bill Drulias (Director of Design)

TAMIEN PARK, SAN JOSE

Verde Design was selected by the City of San Jose (City) to provide two concept plans, a preferred concept, construction documents, bidding, and construction assistance for the City's Tamien Park. Included in Phase I of the 3.67-acre park design, is a new parking lot, a pre-fabricated restroom/storage building, security lighting with power outlets, shade structures, picnic and play opportunities. Additional features of the park include a post-tension slab basketball court, synthetic turf volleyball court, youth play area, game tables, ornamental fencing, stone pilasters, signage, pervious and impervious paving, site-specific improvements, drought-tolerant planting, and an MWEL-compliant pump and irrigation system that is designed to be switched over to recycled water when it becomes available. In Spring 2021, Verde Design completed Phase II additions to the park, which included a natural grass multi-use field with accompanying shade structures, perimeter all-weather walking/running path, and field netting. An outdoor fitness/exercise area is provided with additional seating and shade. The park is designed to have direct linkage to the train station upon build out. A perimeter pathway encompasses the new field with raised planting beds. A solar lighting was also installed for safety and emergency lighting.



Project Team: Derek McKee (PIC) and Bill Drulias (Director of Design)



References of Work Performed Form

(List 5 Local References)

Company Name: Verde Design Inc.

1. Name of Reference: Town of Apple Valley

Address: 14955 Dale Evans Parkway, Apple Valley, CA, 92307

Contact Name: Rich Berger Phone Number: 760.240.7000

Email: rberger@applevalley.org

Dates of Business: June 2023 - Estimated mid 2025

2. Name of Reference: City of Glendale

Address: 201 E. Colorado Street, Glendale, CA 91201

Contact Name: Joseph Gonzalez Phone Number: 818.550.4415

Email: jogonzalez@glendaleca.gov

Dates of Business: March 2024 - In design

3. Name of Reference: City of Burbank

Address: 275 East Olive Avenue Burbank, CA 91502

Contact Name: Mike Del Campo Phone Number: 818.238.5343

Email: mdelcampo@burbankca.gov

Dates of Business: January 2020 - October 2023

4. Name of Reference: City of Cathedral City

Address: 68700 Avenida Lalo Guerrero, Cathedral City, CA 92234

Contact Name: John Corella Phone Number: 760.770.0340

Email: Jcorella@cathedralcity.gov

Dates of Business: November 2019 - Estimated mid 2025

5. Name of Reference: City of Bakersfield

Address: 1600 Truxtun Avenue, Bakersfield, CA 93306

Contact Name: Navdip Grewal Phone Number: 415.999.6548

Email: ngrewal@bakersfieldcity.us

Dates of Business: December 2019 - August 2023



EXHIBIT "B"

Payment Schedule (Hourly Payment)

A. Hourly Rate

CONSULTANT'S fees for such services shall be based upon the following hourly rate and cost schedule:

SEE ATTACHED EXHIBIT B

B. Travel Charges for time during travel are not reimbursable.

C. Billing

1. All billing shall be done monthly in fifteen (15) minute increments and matched to an appropriate breakdown of the time that was taken to perform that work and who performed it.
2. Each month's bill should include a total to date. That total should provide, at a glance, the total fees and costs incurred to date for the project.
3. A copy of memoranda, letters, reports, calculations and other documentation prepared by CONSULTANT may be required to be submitted to CITY to demonstrate progress toward completion of tasks. In the event CITY rejects or has comments on any such product, CITY shall identify specific requirements for satisfactory completion.
4. CONSULTANT shall submit to CITY an invoice for each monthly payment due. Such invoice shall:
 - A) Reference this Agreement;
 - B) Describe the services performed;
 - C) Show the total amount of the payment due;
 - D) Include a certification by a principal member of CONSULTANT's firm that the work has been performed in accordance with the provisions of this Agreement; and
 - E) For all payments include an estimate of the percentage of work completed.

Upon submission of any such invoice, if CITY is satisfied that CONSULTANT is making satisfactory progress toward completion of tasks in accordance with this Agreement, CITY shall approve the invoice, in which event payment shall be made within thirty (30) days of receipt of the invoice by CITY. Such approval shall not be unreasonably withheld. If CITY does not approve an invoice, CITY shall notify CONSULTANT in writing of the reasons for non-approval and the schedule of performance set forth in **Exhibit "A"** may at the option of CITY be suspended until the parties agree that past performance by CONSULTANT is in, or has been brought into compliance, or until this Agreement has expired or is terminated as provided herein.

5. Any billings for extra work or additional services authorized in advance and in writing by CITY shall be invoiced separately to CITY. Such invoice shall contain all of the information required above, and in addition shall list the hours expended and hourly rate charged for such time. Such invoices shall be approved by CITY if the work performed is in accordance with the extra work or additional services requested, and if CITY is satisfied that the statement of hours worked and costs incurred is accurate. Such approval shall not be unreasonably withheld. Any dispute between the parties concerning payment of such an invoice shall be treated as separate and apart from the ongoing performance of the remainder of this Agreement.

DETERMINING COSTS FOR PROFESSIONAL FEES

Verde Design strongly believes that the success of any project begins with clear communication including identifying a specific scope of services and associated fees for every respective project. It is important to us that our client not only feels that they received the services that they paid for but that it was also excellent value without sacrifice.

If we are selected to perform professional services for the City of Huntington Beach (City), we will review the project scope with you to develop project specific tasks, consultant needs and overall process to establish professional compensation which can be provided in a fee breakdown matrix. It is our intent to be all-inclusive with our proposal and prefer not to provide additional services or contract amendments as the project progresses.

Typically, our fees are provided on a lump sum fixed fee basis that is derived from the task/fee worksheet. Additional services, if required, can use fixed fee or time and materials approach as determined through discussions with the City. We have provided services utilizing a percentage of construction costs. While the percentage can vary based on scope, we are typically in the 7.5% to 12% range. Fee percentage is determined by the complexity and overall size of the project scope and anticipated construction budget.



Barkley Park, City of Woodside





Verde Design

For every project, we determine a cost utilizing a task and fee methodology tailored to the specific requirements of the project, with a preference for a fixed fee lump sum structure. The accompanying chart details the current rates for professional services and office-related expenses. Additionally, the reimbursable rates and associated costs are presented at the bottom of the chart.

Project Rates	2025	2026	2027	2028
Principal	\$275.00 per hour	\$285.00 per hour	\$295.00 per hour	\$305.00 per hour
Project Manager/Construction Manager				
Level Four	\$260.00 per hour	\$270.00 per hour	\$280.00 per hour	\$290.00 per hour
Level Three	\$240.00 per hour	\$250.00 per hour	\$260.00 per hour	\$270.00 per hour
Level Two	\$195.00 per hour	\$200.00 per hour	\$210.00 per hour	\$220.00 per hour
Level One	\$180.00 per hour	\$190.00 per hour	\$200.00 per hour	\$210.00 per hour
Project Engineer				
Level III	\$200.00 per hour	\$210.00 per hour	\$220.00 per hour	\$230.00 per hour
Level I	\$185.00 per hour	\$195.00 per hour	\$210.00 per hour	\$215.00 per hour
IT Manager	\$195.00 per hour	\$205.00 per hour	\$215.00 per hour	\$225.00 per hour
CAD Manager	\$190.00 per hour	\$200.00 per hour	\$210.00 per hour	\$220.00 per hour
Project Designer	\$175.00 per hour	\$180.00 per hour	\$190.00 per hour	\$200.00 per hour
Job Captain/Staff Engineer/Construction Admin	\$165.00 per hour	\$170.00 per hour	\$180.00 per hour	\$190.00 per hour
Draftsperson Level II	\$160.00 per hour	\$165.00 per hour	\$170.00 per hour	\$180.00 per hour
Draftsperson Level I	\$155.00 per hour	\$160.00 per hour	\$165.00 per hour	\$170.00 per hour
Project Administrator	\$100.00 per hour	\$105.00 per hour	\$110.00 per hour	\$115.00 per hour
Intern	\$85.00 per hour	\$90.00 per hour	\$95.00 per hour	\$100.00 per hour

Reimbursable Rates

Blueprints, Printing and Reproductions	Cost plus 10%
Sub Consultant Services	Cost plus 10%

Reimbursable Expenses

Blueprints and Reproductions	Travel Expenses
Photography	Parking and Toll Expenses
Models and Renderings	Permit Fees
Postage/Overnight Mail Service	Courier Delivery Service

Charge Rate Schedule is subject to revisions.





SURVEYING AND MAPPING SERVICES FEE SCHEDULE

(This rate schedule is subject to a revision on October 1, 2025)

Office Staff:

Contract/ Survey Manager	\$260
Project Surveyor	\$220
Survey Analyst / Technician	\$185
Admin / Clerical	\$100

Note: Authorized overtime will be charged at 1.5 times the above rate.

Field Staff:

1 Person Field Crew *	\$265
2 Person Field Crew *	\$365
3 Person Field Crew *	\$485

** CL Surveying and Mapping, Inc. is signatory to the International Union of Operating Engineers Local 12. Field surveyors are therefore paid prevailing wage rates for all work performed.*

Reimbursable Expenses:

1. 3D Laser Scanner equipment is not included in our overhead rate and will be invoiced at an additional separate daily rate.
2. All field staff are subject to prevailing wages.
3. Aerial Mapping costs by subconsultant will be invoiced as an ODC. A copy of invoices from the subconsultant will be submitted for reimbursement.





CONVERSE CONSULTANTS Non-Prevailing Wage Schedule of Fees Geotechnical Personnel

Introduction

It is the objective of Converse Consultants to provide its clients with quality professional and technical services and a continuing source of professional advice and opinions. Services will be performed in a manner consistent with that level of care and skill ordinarily exercised by members of the profession currently practicing in the same locality under similar conditions. This fee schedule is valid through December 31, 2025.

Hourly Charges for Personnel

Staff assignments will depend on personnel availability, job complexity, project site location, and experience level required to satisfy the technical requirements of the project and to meet the prevailing standard of professional care.

Field Technical Services (all including vehicle and equipment)

Construction Inspector – ACI/ICC and/or AWS/CWI certified (concrete, post-tension, masonry, structural steel, fireproofing; includes concrete batch plant and local steel fabrication inspections)	\$90
Non-Destructive Testing Inspector (ultrasonic, magnetic particle, dye penetrant).....	90
Construction Inspector/Technician (skidmore, pull testing, torque testing, Schmidt hammer, and pachometer).....	90
Coring Technician	90
Soils Technician (soil, base, asphalt concrete, and moisture emission testing)	90
Senior Soils Technician.....	95
Sample Pick-Up	60

Professional Services (field and office)

Staff Professional	\$150
Senior Staff Professional.....	155
Project Professional	165
Project Manager.....	175
Senior Professional	180
Principal Professional.....	225
Principal/Consultant	235

Laboratory Testing

Laboratory Technician.....	Per Test
(See Geotechnical Laboratory Testing and Materials Testing Services fee schedules.)	
Laboratory Supervisor	\$100

Office Support

Clerical/Word Processing	\$90
Drafting.....	90
CAD Operator/Drafting Manager	100

An overtime charge of 50 percent of the above hourly rates (excluding Professional Services) will be added for time in excess of eight hours per day and for all time on Saturdays, Sundays and holidays. An overtime charge of 100 percent of the above hourly rates (excluding Professional Services) will be charged on Sunday if hours worked were seven continuous eight hours per day in one work week, not counting paid time off within the week. Travel time to and from the job site will be charged at the hourly rates for the appropriate personnel.

Expenses

1. Exploration expenses (drilling, trenching, etc.) are charged at cost plus fifteen percent.
2. Travel and subsistence expenses (transportation, room and board, etc.) for individuals on projects requiring travel and/or living 50 miles away from the project site are charged at cost plus fifteen percent.
3. Automobile and truck expenses are charged at cost plus fifteen percent (rentals) or at the current IRS mileage rate for company-owned vehicles traveling between principal office and project.
4. Other out-of-pocket direct project expenses (aerial photos, long-distance telephone calls, permits, outside printing services, tests, etc.) are charged at cost plus fifteen percent.

Invoices

1. Invoices will be submitted to the Client on a monthly basis, and a final bill will be submitted upon completion of services.
2. Payment is due upon presentation of invoice and is past-due thirty days from invoice date. In the event Client fails to make any payment to Converse when due, Converse may immediately cease work hereunder until said payment, together with a service charge at the rate of eighteen percent per annum (but not exceeding the maximum allowed by law) from the due date, has been received. Furthermore, Converse may at its sole option and discretion refuse to perform any further work irrespective of payment from Client in the event Client fails to pay Converse for services when said payments are due.
3. Client shall pay attorneys' fees or other costs incurred in collecting any delinquent amount.

General Conditions

The terms and provisions of the Converse General Conditions are incorporated into this fee schedule as though set forth in full. If a copy of the General Conditions does not accompany this fee schedule, Client should request a copy from this office.

Converse Consultants P2025 Geotech



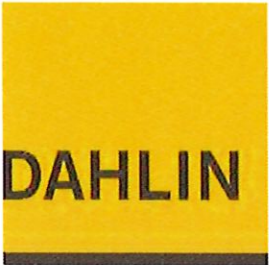

RATES

2025 BASIC HOURLY RATE SCHEDULE	PRESIDENT/CEO, SENIOR VICE PRESIDENT, FOUNDER, CFO, CMO, CPO	\$ \$275 - \$300
	PRINCIPAL, DIRECTOR, MANAGING PRINCIPAL, MANAGING DIRECTOR, SENIOR PRINCIPAL, SENIOR DIRECTOR	\$210 - \$270
	SENIOR - ARCHITECT, PROJECT MANAGER, PROJECT SPECIALIST, DESIGNER, PLANNER	\$190 - \$200
	ARCHITECT, PROJECT MANAGER, PROJECT SPECIALIST, PROJECT DESIGNER, DESIGN MANAGER	\$170 - \$180
	JOB CAPTAIN, INTERIOR DESIGNER, BIM SPECIALIST, DESIGNER, PLANNER	\$130 - \$160
	DESIGNER/DRAFTER	\$100 - \$120
	ADMINISTRATION	\$85 - \$125

RATES EFFECTIVE THROUGH DECEMBER 31, 2025 AND MAY BE ADJUSTED ANNUALLY



FBA HOURLY RATE SCHEDULE – 2024

Principal / Project Director	\$ 210.00/hour
V.P. / Senior Associate	\$ 160.00/hour
Associate / Project Manager	\$ 160.00/hour
Construction Support	\$ 135.00/hour
Electrical Designer	\$ 110.00/hour
CAD / BIM Designer	\$ 90.00/hour
Technical Typist	\$ 50.00/hour





HOURLY RATE SCHEDULE

Effective February 24, 2025 through February 28, 2026

Principal	\$ 325.00 / Hour
Development Services Manager	\$ 305.00 / Hour
Associate	\$ 275.00 / Hour
Structural Engineering Manager	\$ 260.00 / Hour
Technical Manager (SME) / Senior Engineering Manager	\$ 260.00 / Hour
Senior Engineer	\$ 249.00 / Hour
Engineer III	\$ 228.00 / Hour
Engineer II	\$ 198.00 / Hour
Engineer I	\$ 160.00 / Hour
Engineering Tech III	\$ 208.00 / Hour
Engineering Tech II	\$ 189.00 / Hour
Engineering Tech I	\$ 175.00 / Hour
Project Coordinator III	\$ 150.00 / Hour
Project Coordinator II	\$ 137.00 / Hour
Project Coordinator I	\$ 129.00 / Hour
Senior Land Surveyor	\$ 255.00 / Hour
Senior Survey Construction Manager	\$ 255.00 / Hour
Survey Operations Coordinator	\$ 218.00 / Hour
Project Surveyor III	\$ 228.00 / Hour
Project Surveyor II	\$ 185.00 / Hour
Project Surveyor I	\$ 158.00 / Hour
Draftsman / Survey Tech III	\$ 178.00 / Hour
Draftsman / Survey Tech II	\$ 152.00 / Hour
Draftsman / Survey Tech I	\$ 132.00 / Hour
3D Laser Scanning Crew	\$ 444.00 / Hour
3-Man Survey Crew	\$ 360.00 / Hour
2-Man Survey Crew	\$ 286.00 / Hour
1-Man Survey Crew	\$ 180.00 / Hour
1-Man Hrly Rate (Travel)	\$ 125.00 / Hour
2-Man Hrly Rate (Travel)	\$ 205.00 / Hour
Engineering / Survey Intern	\$ 90.00 / Hour
Testimony (Trial or Deposition)	\$ 589.00 / Hour

All blueprinting and reproduction will be billed at cost plus 10%.

Time spent for preparation for testimony will be billed in accordance with the above hourly rates.





Rates

Rates

Classification	Rates (\$/hr)
Principal	\$ 360.00
Managing Engineer	\$ 265.00
Sr. Project Manager	\$ 240.00
Project Manager	\$ 180.00
Project Coordinator	\$ 135.00
Sr. Engineer	\$ 225.00
Engineer	\$ 180.00
Assistant Engineer	\$ 135.00
Sr. Environmental Planner	\$ 200.00
Environmental Planner	\$ 140.00
Sr. Environmental Scientist	\$ 200.00
Environmental Scientist	\$ 165.00
Assistant Environmentalist	\$ 115.00
Geologist	\$ 165.00
Sr. Hydrologist	\$ 180.00
Hydrologist	\$ 165.00
Sr. Landscape Architect or Designer	\$ 200.00
Landscape Architect or Designer	\$ 145.00
Sr. Designer	\$ 170.00
Designer	\$ 125.00
Sr. GIS Specialist	\$ 170.00
GIS Specialist	\$ 140.00
Sr. Surveyor	\$ 170.00
Surveyor	\$ 140.00
Sr. Inspector	\$ 170.00
Inspector	\$ 135.00
Outreach or Communications Specialist	\$ 155.00
Technical Editor	\$ 125.00
Graphic Designer	\$ 125.00
Project Controls	\$ 155.00
Administrative Assistant	\$ 95.00

