

PROFESSIONAL SERVICES CONTRACT BETWEEN  
THE CITY OF HUNTINGTON BEACH AND  
DAVID VOLZ DESIGN LANDSCAPE ARCHITECTS, INC.  
FOR  
ON-CALL ARCHITECTURAL ENGINEERING, LANDSCAPE  
ARCHITECTURAL ENGINEERING AND PROFESSIONAL  
CONSULTING SERVICES

THIS AGREEMENT ("Agreement") is made and entered into by and between the City of Huntington Beach, a municipal corporation of the State of California, hereinafter referred to as "CITY," and DAVID VOLZ DESIGN LANDSCAPE ARCHITECTS, INC., a California Corporation hereinafter referred to as "CONSULTANT."

WHEREAS, CITY desires to engage the services of a consultant to provide on-call architectural engineering, landscape architectural engineering and professional consulting services; and

Pursuant to documentation on file in the office of the City Clerk, the provisions of the Huntington Beach Municipal Code, Chapter 3.03, relating to procurement of professional service contracts have been complied with; and

CONSULTANT has been selected to perform these services,

NOW, THEREFORE, it is agreed by CITY and CONSULTANT as follows:

1. SCOPE OF SERVICES

CONSULTANT shall provide all services as described in **Exhibit "A,"** which is attached hereto and incorporated into this Agreement by this reference. These services shall sometimes hereinafter be referred to as the "PROJECT."

CONSULTANT hereby designates Jamie Graham who shall represent it and be its sole contact and agent in all consultations with CITY during the performance of this Agreement.

2. CITY STAFF ASSISTANCE

CITY shall assign a staff coordinator to work directly with CONSULTANT in the performance of this Agreement.

3. TERM; TIME OF PERFORMANCE

Time is of the essence of this Agreement. The services of CONSULTANT are to commence on \_\_\_\_\_, 20\_\_\_\_ (the "Commencement Date"). This Agreement shall automatically terminate three (3) years from the Commencement Date, unless extended or sooner terminated as provided herein. All tasks specified in **Exhibit "A"** shall be completed no later than three (3) years from the Commencement Date. The time for performance of the tasks identified in **Exhibit "A"** are generally to be shown in **Exhibit "A."** This schedule may be amended to benefit the PROJECT if mutually agreed to in writing by CITY and CONSULTANT.

In the event the Commencement Date precedes the Effective Date, CONSULTANT shall be bound by all terms and conditions as provided herein.

4. COMPENSATION

In consideration of the performance of the services described herein, CITY agrees to pay CONSULTANT on a time and materials basis at the rates specified in **Exhibit "B,"** which is attached hereto and incorporated by reference into this Agreement, a fee, including all costs and expenses, not to exceed One Million Dollars (\$1,000,000.00).

5. EXTRA WORK

In the event CITY requires additional services not included in **Exhibit "A"** or changes in the scope of services described in **Exhibit "A,"** CONSULTANT will undertake such work only after receiving written authorization from CITY. Additional compensation for such extra work shall be allowed only if the prior written approval of CITY is obtained.

6. METHOD OF PAYMENT

CONSULTANT shall be paid pursuant to the terms of **Exhibit "B."**

7. DISPOSITION OF PLANS, ESTIMATES AND OTHER DOCUMENTS

CONSULTANT agrees that title to all materials prepared hereunder, including, without limitation, all original drawings, designs, reports, both field and office notices, calculations, computer code, language, data or programs, maps, memoranda, letters and other documents, shall belong to CITY, and CONSULTANT shall turn these materials over to CITY upon expiration or termination of this Agreement or upon PROJECT completion, whichever shall occur first. These materials may be used by CITY as it sees fit, provided that any such use not within the purposes intended, by the Agreement shall be at City's sole risk.

8. HOLD HARMLESS

A. To the extent allowed by Civil Code Section 2782.8, CONSULTANT hereby agrees to protect, defend, indemnify and hold harmless CITY, its officers, elected or appointed officials, employees, agents and volunteers from and against any and all claims, damages, losses, expenses, judgments, demands and defense costs (including, without limitation, costs and fees of litigation of every nature or liability of any kind or nature) arising out of or in connection with CONSULTANT's (or CONSULTANT's subcontractors, if any) negligent (or alleged negligent) performance of this Agreement or its failure to comply with any of its obligations contained in this Agreement by CONSULTANT, its officers, agents or employees except such loss or damage which was caused by the sole negligence or willful misconduct of CITY. CONSULTANT will conduct all defense at its sole cost and expense and CITY shall approve selection of CONSULTANT's counsel. This indemnity shall apply to all claims and liability regardless of whether any insurance policies are applicable. The policy limits do not act as limitation upon the amount of indemnification to be provided by CONSULTANT.

B. To the extent that CONSULTANT performs “Design Professional Services” within the meaning of Civil Code Section 2782.8, then the following Hold Harmless provision applies in place of subsection A above:

“CONSULTANT hereby agrees to protect, defend, indemnify and hold harmless CITY and its officers, elected or appointed officials, employees, agents and volunteers, from and against any and all claims, damages, losses, expenses, demands and defense costs (including, without limitation, costs and fees of litigation of every nature or liability of any kind or nature) to the extent that the claims against CONSULTANT arise out of, pertain to, or relate to the negligence, recklessness, or willful misconduct of CONSULTANT. In no event shall the cost to defend charged to CONSULTANT exceed CONSULTANT’s proportionate percentage of fault. However, notwithstanding the previous sentence, in the event one or more other defendants to the claims and/or litigation is unable to pay its share of defense costs due to bankruptcy or dissolution of the business, CONSULTANT shall meet and confer with CITY and other defendants regarding unpaid defense costs. The duty to indemnify, including the duty and the cost to defend, is limited as provided in California Civil Code Section 2782.8.

C. Regardless of whether subparagraph A or B applies, CITY shall be reimbursed by CONSULTANT for all costs and attorney’s fees incurred by CITY in enforcing this obligation. This indemnity shall apply to all claims and liability regardless of whether any insurance policies are applicable. The policy limits do not act as a limitation upon the amount of indemnification to be provided by CONSULTANT.

#### 9. PROFESSIONAL LIABILITY INSURANCE

CONSULTANT shall obtain and furnish to CITY a professional liability insurance policy covering the work performed by it hereunder. This policy shall provide coverage for CONSULTANT’s professional liability in an amount not less than One Million Dollars



(\$1,000,000.00) per occurrence and in the aggregate. The above-mentioned insurance shall not contain a self-insured retention without the express written consent of CITY; however an insurance policy "deductible" of Ten Thousand Dollars (\$10,000.00) or less is permitted. A claims-made policy shall be acceptable if the policy further provides that:

- A. The policy retroactive date coincides with or precedes the initiation of the scope of work (including subsequent policies purchased as renewals or replacements).
- B. CONSULTANT shall notify CITY of circumstances or incidents that might give rise to future claims.

CONSULTANT will make every effort to maintain similar insurance during the required extended period of coverage following PROJECT completion. If insurance is terminated for any reason, CONSULTANT agrees to purchase an extended reporting provision of at least two (2) years to report claims arising from work performed in connection with this Agreement.

If CONSULTANT fails or refuses to produce or maintain the insurance required by this section or fails or refuses to furnish the CITY with required proof that insurance has been procured and is in force and paid for, the CITY shall have the right, at the CITY's election, to forthwith terminate this Agreement. Such termination shall not effect Consultant's right to be paid for its time and materials expended prior to notification of termination. CONSULTANT waives the right to receive compensation and agrees to indemnify the CITY for any work performed prior to approval of insurance by the CITY.

#### 10. CERTIFICATE OF INSURANCE

Prior to commencing performance of the work hereunder, CONSULTANT shall furnish to CITY a certificate of insurance subject to approval of the City Attorney evidencing the foregoing insurance coverage as required by this Agreement; the certificate shall:

- A. provide the name and policy number of each carrier and policy;
- B. state that the policy is currently in force; and
- C. shall promise that such policy shall not be suspended, voided or canceled by either party, reduced in coverage or in limits except after thirty (30) days' prior written notice; however, ten (10) days' prior written notice in the event of cancellation for nonpayment of premium.

CONSULTANT shall maintain the foregoing insurance coverage in force until the work under this Agreement is fully completed and accepted by CITY.

The requirement for carrying the foregoing insurance coverage shall not derogate from CONSULTANT's defense, hold harmless and indemnification obligations as set forth in this Agreement. CITY or its representative shall at all times have the right to demand the original or a copy of the policy of insurance. CONSULTANT shall pay, in a prompt and timely manner, the premiums on the insurance hereinabove required.

#### 11. INDEPENDENT CONTRACTOR

CONSULTANT is, and shall be, acting at all times in the performance of this Agreement as an independent contractor herein and not as an employee of CITY. CONSULTANT shall secure at its own cost and expense, and be responsible for any and all payment of all taxes, social security, state disability insurance compensation, unemployment compensation and other payroll deductions for CONSULTANT and its officers, agents and employees and all business licenses, if any, in connection with the PROJECT and/or the services to be performed hereunder.

#### 12. TERMINATION OF AGREEMENT

All work required hereunder shall be performed in a good and workmanlike manner. CITY may terminate CONSULTANT's services hereunder at any time with or without cause, and whether or not the PROJECT is fully complete. Any termination of this Agreement by CITY shall

be made in writing, notice of which shall be delivered to CONSULTANT as provided herein. In the event of termination, all finished and unfinished documents, exhibits, report, and evidence shall, at the option of CITY, become its property and shall be promptly delivered to it by CONSULTANT.

13. ASSIGNMENT AND DELEGATION

This Agreement is a personal service contract and the work hereunder shall not be assigned, delegated or subcontracted by CONSULTANT to any other person or entity without the prior express written consent of CITY. If an assignment, delegation or subcontract is approved, all approved assignees, delegates and subconsultants must satisfy the insurance requirements as set forth in Sections 9 and 10 hereinabove.

14. COPYRIGHTS/PATENTS

CITY shall own all rights to any patent or copyright on any work, item or material produced as a result of this Agreement.

15. CITY EMPLOYEES AND OFFICIALS

CONSULTANT shall employ no CITY official nor any regular CITY employee in the work performed pursuant to this Agreement. No officer or employee of CITY shall have any financial interest in this Agreement in violation of the applicable provisions of the California Government Code.

16. NOTICES

Any notices, certificates, or other communications hereunder shall be given either by personal delivery to CONSULTANT's agent (as designated in Section 1 hereinabove) or to CITY as the situation shall warrant, or by enclosing the same in a sealed envelope, postage prepaid, and depositing the same in the United States Postal Service, to the addresses specified below. CITY and CONSULTANT may designate different addresses to which subsequent notices, certificates or

other communications will be sent by notifying the other party via personal delivery, a reputable overnight carrier or U. S. certified mail-return receipt requested:

TO CITY:

City of Huntington Beach  
ATTN: Dir. Comm. & Library Services  
2000 Main Street  
Huntington Beach, CA 92648

TO CONSULTANT:

David Volz Design Landscape Architects,  
Inc.  
ATTN: Jamie Graham  
151 Kalmus Drive, Suite M8  
Costa Mesa, CA 92626

17. CONSENT

When CITY's consent/approval is required under this Agreement, its consent/approval for one transaction or event shall not be deemed to be a consent/approval to any subsequent occurrence of the same or any other transaction or event.

18. MODIFICATION

No waiver or modification of any language in this Agreement shall be valid unless in writing and duly executed by both parties.

19. SECTION HEADINGS

The titles, captions, section, paragraph and subject headings, and descriptive phrases at the beginning of the various sections in this Agreement are merely descriptive and are included solely for convenience of reference only and are not representative of matters included or excluded from such provisions, and do not interpret, define, limit or describe, or construe the intent of the parties or affect the construction or interpretation of any provision of this Agreement.

20. INTERPRETATION OF THIS AGREEMENT

The language of all parts of this Agreement shall in all cases be construed as a whole, according to its fair meaning, and not strictly for or against any of the parties. If any provision of this Agreement is held by an arbitrator or court of competent jurisdiction to be unenforceable, void, illegal or invalid, such holding shall not invalidate or affect the remaining

covenants and provisions of this Agreement. No covenant or provision shall be deemed dependent upon any other unless so expressly provided here. As used in this Agreement, the masculine or neuter gender and singular or plural number shall be deemed to include the other whenever the context so indicates or requires. Nothing contained herein shall be construed so as to require the commission of any act contrary to law, and wherever there is any conflict between any provision contained herein and any present or future statute, law, ordinance or regulation contrary to which the parties have no right to contract, then the latter shall prevail, and the provision of this Agreement which is hereby affected shall be curtailed and limited only to the extent necessary to bring it within the requirements of the law.

21. DUPLICATE ORIGINAL

The original of this Agreement and one or more copies hereto have been prepared and signed in counterparts as duplicate originals, each of which so executed shall, irrespective of the date of its execution and delivery, be deemed an original. Each duplicate original shall be deemed an original instrument as against any party who has signed it.

22. IMMIGRATION

CONSULTANT shall be responsible for full compliance with the immigration and naturalization laws of the United States and shall, in particular, comply with the provisions of the United States Code regarding employment verification.

23. LEGAL SERVICES SUBCONTRACTING PROHIBITED

CONSULTANT and CITY agree that CITY is not liable for payment of any subcontractor work involving legal services, and that such legal services are expressly outside the scope of services contemplated hereunder. CONSULTANT understands that pursuant to *Huntington Beach City Charter* Section 309, the City Attorney is the exclusive legal counsel for

CITY; and CITY shall not be liable for payment of any legal services expenses incurred by CONSULTANT.

24. ATTORNEY'S FEES

In the event suit is brought by either party to construe, interpret and/or enforce the terms and/or provisions of this Agreement or to secure the performance hereof, each party shall bear its own attorney's fees, such that the prevailing party shall not be entitled to recover its attorney's fees from the nonprevailing party.

25. SURVIVAL

Terms and conditions of this Agreement, which by their sense and context survive the expiration or termination of this Agreement, shall so survive.

26. GOVERNING LAW

This Agreement shall be governed and construed in accordance with the laws of the State of California.

27. SIGNATORIES

Each undersigned represents and warrants that its signature hereinbelow has the power, authority and right to bind their respective parties to each of the terms of this Agreement, and shall indemnify CITY fully for any injuries or damages to CITY in the event that such authority or power is not, in fact, held by the signatory or is withdrawn.

28. ENTIRETY

The parties acknowledge and agree that they are entering into this Agreement freely and voluntarily following extensive arm's length negotiation, and that each has had the opportunity to consult with legal counsel prior to executing this Agreement. The parties also acknowledge and agree that no representations, inducements, promises, agreements or warranties, oral or otherwise, have been made by that party or anyone acting on that party's behalf, which are not embodied in this

Agreement, and that that party has not executed this Agreement in reliance on any representation, inducement, promise, agreement, warranty, fact or circumstance not expressly set forth in this Agreement. This Agreement, and the attached exhibits, contain the entire agreement between the parties respecting the subject matter of this Agreement, and supersede all prior understandings and agreements whether oral or in writing between the parties respecting the subject matter hereof.

29. EFFECTIVE DATE

This Agreement shall be effective on the date of its approval by the City Council.

This Agreement shall expire when terminated as provided herein.

IN WITNESS WHEREOF, the parties hereto have caused this Agreement to be executed by and through their authorized officers.

CONSULTANT,  
DAVID VOLZ DESIGN LANDSCAPE  
ARCHITECTS, INC.

CITY OF HUNTINGTON BEACH, a  
municipal corporation of the State of  
California

By:   
\_\_\_\_\_  
Eric Sterling  
print name

\_\_\_\_\_  
Mayor

ITS: (circle one) Chairman/President/Vice President

\_\_\_\_\_  
City Clerk

AND

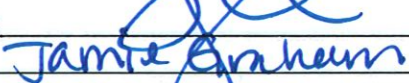
By:   
\_\_\_\_\_  
Jamie Graham  
print name

ITS: (circle one) Secretary/Chief Financial Officer/Asst.  
Secretary - Treasurer

INITIATED AND APPROVED:

\_\_\_\_\_  
Director of Community & Library Services

REVIEWED AND APPROVED:

\_\_\_\_\_  
City Manager

APPROVED AS TO FORM:

  
\_\_\_\_\_  
City Attorney

Agreement, and that that party has not executed this Agreement in reliance on any representation, inducement, promise, agreement, warranty, fact or circumstance not expressly set forth in this Agreement. This Agreement, and the attached exhibits, contain the entire agreement between the parties respecting the subject matter of this Agreement, and supersede all prior understandings and agreements whether oral or in writing between the parties respecting the subject matter hereof.

29. EFFECTIVE DATE

This Agreement shall be effective on the date of its approval by the City Council.

This Agreement shall expire when terminated as provided herein.

IN WITNESS WHEREOF, the parties hereto have caused this Agreement to be executed by and through their authorized officers.

CONSULTANT,  
DAVID VOLZ DESIGN LANDSCAPE  
ARCHITECTS, INC.

CITY OF HUNTINGTON BEACH, a  
municipal corporation of the State of  
California

By: \_\_\_\_\_  
\_\_\_\_\_  
print name

**ITS:** (circle one) Chairman/President/Vice President

**AND**

By: \_\_\_\_\_  
\_\_\_\_\_  
print name

**ITS:** (circle one) Secretary/Chief Financial Officer/Asst.  
Secretary - Treasurer

\_\_\_\_\_  
Mayor

\_\_\_\_\_  
City Clerk

INITIATED AND APPROVED:

  
\_\_\_\_\_  
Director of Community & Library Services

REVIEWED AND APPROVED:

\_\_\_\_\_  
City Manager

APPROVED AS TO FORM:

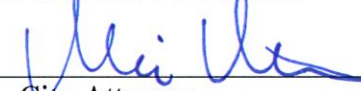
  
\_\_\_\_\_  
City Attorney



## **EXHIBIT "A"**

A. STATEMENT OF WORK: (Narrative of work to be performed)

Consultant to provide on-call architectural engineering, landscape architectural engineering and professional consulting services

B. CONSULTANT'S DUTIES AND RESPONSIBILITIES:

SEE ATTACHED EXHIBIT A

C. CITY'S DUTIES AND RESPONSIBILITIES:

D. WORK PROGRAM/PROJECT SCHEDULE:

EXHIBIT A

---

# PROPOSAL

To Provide Professional Landscape Architectural Design Services for

---

CITY OF HUNTINGTON BEACH

ON-CALL LANDSCAPE  
ARCHITECTURE DESIGN

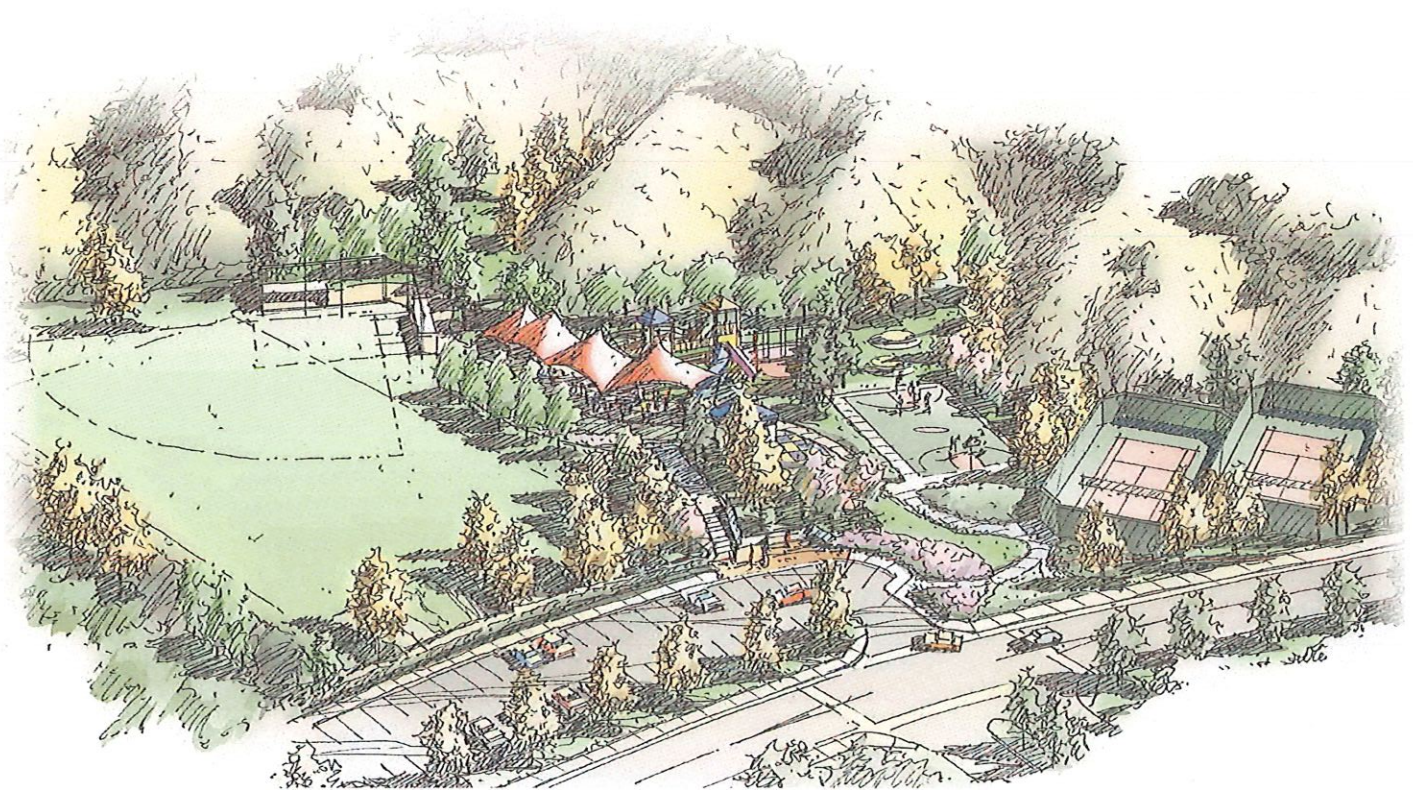

APRIL 29, 2025

---

Designing landscapes that create community

**DWD** David Volz Design  
Landscape Architects and Park Planners



.....  
April 29, 2025



Designing landscapes that create  
community...

Cody Hernandez  
City of Huntington Beach  
2000 Main Street  
Huntington Beach, CA 92648

**RE: PROPOSAL TO PROVIDE PROFESSIONAL LANDSCAPE ARCHITECTURE DESIGN SERVICES  
FOR THE CITY OF HUNTINGTON BEACH AS NEEDED**

Dear Mr. Hernandez,

Huntington Beach has a great inventory of parks and public landscapes. The creative designers at David Volz Design has a long history of designing award winning parks throughout Southern California. We have worked with hundreds of cities providing a variety of multidiscipline professional design, planning, and construction support related services for capital improvement projects associated with parks and recreation, streets, and neighborhood revitalization. Our firm would very much like to assist the City of Huntington Beach in the development of future outstanding public landscape projects as a member of your design team.

**EXPERIENCE IN PROVIDING ON-CALL CAPITAL IMPROVEMENT PROJECT DESIGN SERVICES – DVD** is currently providing professional on-call as-needed design services to two dozen public agencies. Under these commissions we provide public facilities, park and green way planning and design, peer review, standards development and budgeting services as active city staff extension professionals. In Anaheim, where we have provided on-call services for over 18 years, including more than 200 task orders, we regularly interact with city staff providing consultations, plan review, budgeting and design services for projects throughout the city.

**QUALIFICATIONS OF THE DESIGN TEAM – Eric Sterling** will be the point of contact for you and your staff. We have for over three decades provided scores of public agencies with on-call consulting services. My firm has specialized in the delivery of public projects including dozens of award-winning projects. Mr. Gary Vasquez, DVD's director of design and project manager, will provide the creative flair that makes DVD designed landscapes special. Our firm has proven expertise in managing multi-discipline project teams, delivering quality design documents and maintaining strong relationships with all our design team partners and public agency clients. At DVD, we understand the importance of providing safe, durable and easy to maintain landscapes and we are adept at providing high quality public construction projects.

David Volz Design has a very creative design team and our desire to be Huntington Beach's design partner will be evidenced in our energy and enthusiasm every step of the way. My firm and I look forward to working with your city's team and the citizens of Huntington Beach on all your important park and landscape projects. This proposal is valid for 180 days.

Very truly yours,

**DAVID VOLZ DESIGN**

A handwritten signature in black ink, appearing to read 'Eric Sterling', is written over a horizontal line.

Eric Sterling, R.L.A. # 2375

.....  
**Corporate Office**  
151 Kalmus Drive, Suite M8  
Costa Mesa, CA 92626  
714.641.1300

**Coachella Valley Office**  
78060 Calle Estado  
La Quinta, CA 92253  
760.580.5165

**San Jose Office**  
84 W Santa Clara Street, Suite 700  
San Jose, CA 95113  
669.444.0461

**San Diego Office**  
4660 La Jolla Village Dr, Suite 100 #1834  
San Diego, CA 92122  
858.247.1222

**REQUEST FOR PROPOSAL**

**VENDOR APPLICATION FORM**

TYPE OF APPLICANT: ☐ NEW ☒ CURRENT VENDOR

Legal Contractual Name of Corporation: David Volz Design Landscape Architects, Inc.

Contact Person for Agreement: Jamie Graham, Director of Administration

Corporate Mailing Address: 151 Kalmus Drive, Suite M8

City, State and Zip Code: Costa Mesa, CA 92626

E-Mail Address: dvd@dvolzdesign.com

Phone: (714) 641-1300 Fax: \_\_\_\_\_

Contact Person for Proposals: Allie Stafford

Title: Marketing Manager E-Mail Address: astafford@dvolzdesign.com

Business Telephone: (714) 641-1300 Business Fax: \_\_\_\_\_

Year Business was Established: 1997

Is your business: (check one)

☐ NON PROFIT CORPORATION ☒ FOR PROFIT CORPORATION

Is your business: (check one)

☒ CORPORATION ☐ LIMITED LIABILITY PARTNERSHIP  
☐ INDIVIDUAL ☐ SOLE PROPRIETORSHIP  
☐ PARTNERSHIP ☐ UNINCORPORATED ASSOCIATION

**Names & Titles of Corporate Board Members**

(Also list Names & Titles of persons with written authorization/resolution to sign contracts)

Names	Title	Phone
Eric Sterling	President	(714) 641-1300
Jamie Graham	Secretary	(714) 641-1300

Federal Tax Identification Number: 33-0835124

City of Huntington Beach Business License Number: \_\_\_\_\_  
 (If none, you must obtain a Huntington Beach Business License upon award of contract.)

City of Huntington Beach Business License Expiration Date: \_\_\_\_\_



# TABLE OF CONTENTS

## Firm Qualifications

Firm Profile .....	6
Project Experience .....	7
References .....	12

## Project Team

Organizational Chart .....	13
Resumes	

## Work Plan

Understanding & Approach .....	14
Creative Playgrounds .....	16
Sustainability .....	17
Community Outreach .....	18
Graphic & Renderings .....	19
Scope of Services .....	20
Quality Control .....	24

## Appendix

Certifications	
Letters of Recommendation	

## Fee Proposal (Seperate)

Hourly Rate Schedule	
----------------------	--

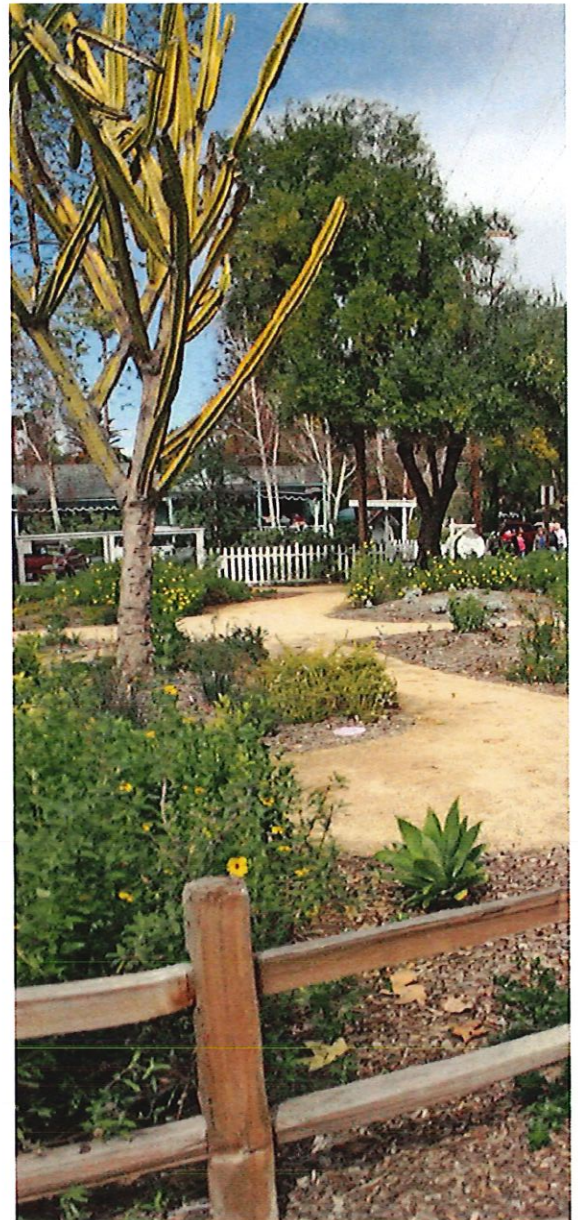



## FIRM QUALIFICATIONS

## FIRM PROFILE

David Volz Design (DVD) is committed to the creative design of outstanding public spaces. We develop landscapes, parks, sports fields, and streetscapes to meet the specific needs of their communities. DVD designs special environments for those who seek recreation in a beautiful setting: wonderful natural environments for those who are simply looking for respite, and for those who pursue recreation and competitive athletic endeavors on the playing field. Our firm capitalizes on what the site and nature has to offer. For all of our commissions, we work to enhance the site's use, working within environmentally sound parameters while taking full advantage of the site and its surroundings to best service the community's needs.

We provides a wide range of services to our public agency clients: site planning, budgeting and preparation of construction documents are the mainstays of the services we provide. Public facilities and landscape improvements we have designed are evident in communities throughout Southern California. We have successfully delivered award-winning public landscape important projects in all over California

We strive to stay on top of the constantly changing world of the construction industry and its pricing. We regularly analyze what is happening with projects during estimating and bidding process to ensure that we are as close as possible to our clients' budget. We have been very successful in tracking costs.

Our company understands the importance of protecting the environment, protecting our resources and the health of future generations. **DVD is proud to be a LEED Accredited and a Qualified Stormwater Designer QSD company.** We understand the commitment we have to the public to deliver quality projects that offer a high return for the public funds invested; projects that can be maintained and deliver a lifetime of service to the communities they are built for.

Our team will be easy to work with, creative, and responsive. We live by our mission statement to "create community" through our designs. Together our firm will be a pro-active knowledgeable resource for your city staff.

**PLANNING & DESIGNING**  
Demonstration gardens, mitigation & restoration  
Nature parks, interpretive gardens & wilderness camps  
Streetscape development & redevelopment  
Community, Neighborhood & mini-parks  
Facility master plans & feasibility studies  
School fields & campus planning  
Irrigation renovation & redesign  
Design guidelines & standards  
Sports parks & stadiums  
Grant applications  
& GIS

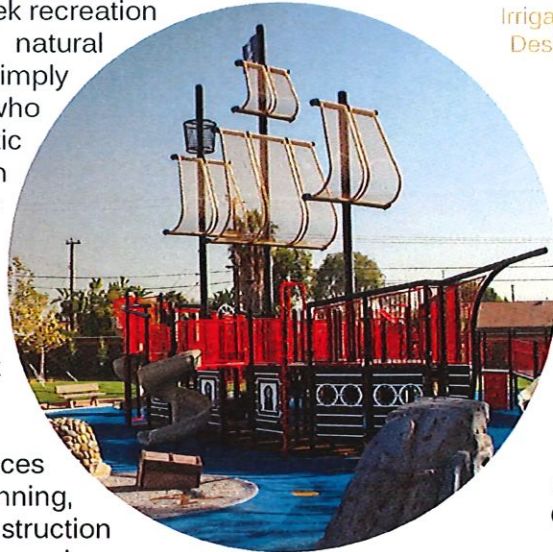

Founded in 1997  
27 years in business  
S-Corporation-CA  
Never filed for bankruptcy  
Wholly-owned Business  
16 employees  
David Volz PLA #2375  
Gary Vasquez PLA #3883  
Eric Sterling PLA #5463  
Luis Pedraza PLA #6782  
Shaun Johnson PLA #6413  
Clayton Franklin PLA #6909  
LEED Accredited  
SBE

"DVD continues to build its reputation on creativity and service in the design of outstanding public spaces. We create high quality public spaces for our clients' communities and neighborhoods. We work with public agencies and the people they serve to develop innovative landscapes of outstanding beauty."

Contact Person:  
Eric Sterling, President, RLA,  
714-641-1300  
esterling@dvolzdesign.com

Like us on Facebook!  
Follow us on Instagram!  
@davidvolzdesign



www.dvolzdesign.com

ON-CALL LANDSCAPE ARCHITECT, CITY OF HUNTINGTON BEACH

**DVD**





## WHITAKER ELEMENTARY SCHOOL PARK

There are no parks nor any available parklands in this section of Buena Park. An initial opportunity to provide some dedicated park facilities at Whitaker School has blossomed into a full of fledged "new" park across three acres of school yard. Through a series of community outreach workshops a plan has emerged with several exciting and unique elements. In addition to normal park amenities, shaded picnic spaces, play lots restrooms, a jog path and nice open spaces, there will be a STEM themed hardscape plaza, unique geometric ground patterns and other creative play spaces. The basketball court surface will be painted for fraction ball, a math-based ball game. The running/walking track will have distance markers. The universal accessible play lot is envisioned to have fun, exciting, and challenging elements for all ages. This fully lighted park will host sports activities, family gatherings, and a myriad of recreation opportunities in this under served part of the city. As the property is to be shared with Whitaker Elementary School, a unique agreement between the City and the School District will allow for this great joint use community facility.

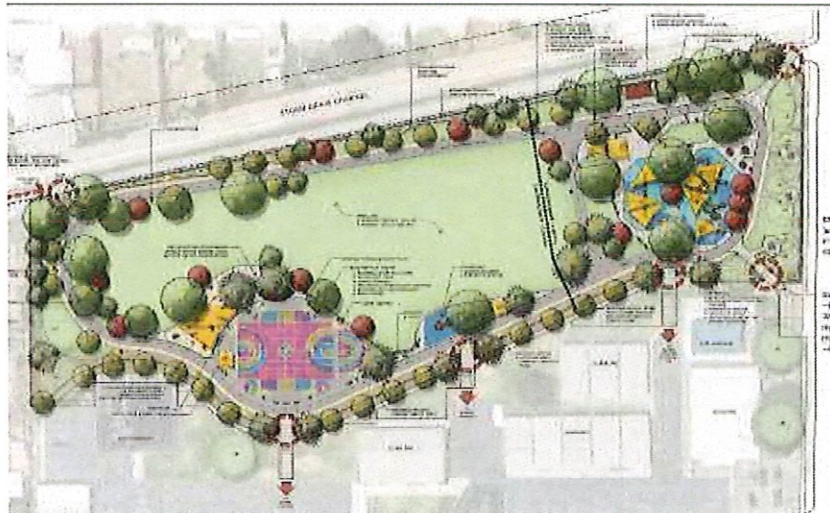

Client:  
City of Buena Park

Reference:  
"David Volz Design has always provided the City of Buena Park with high-quality professional services for these projects and many others."

Jim Box  
Director of Community Services  
(714) 562-3850  
jbox@buenapark.com

### Key Elements:

- Universally Accessible play lots
- Basketball Court
- Running/Walking Track
- STEM Elements
- Lighting

### Services provided:

- Master Plan
- Community Outreach
- Construction Documents
- Construction Period Services

Start Date: June 2019  
Completion Date: August 2024  
Cost of Design: \$331,911

DVD Project Manager:  
Eric Sterling  
Staff: David Volz, Gary Vasquez,  
Paul Cassar, Luis Pedraza

Subconsultants: Ardurra, Design  
West Engineering, Shucui Yaghi  
Consulting Engineers

### More Buena Park Projects:

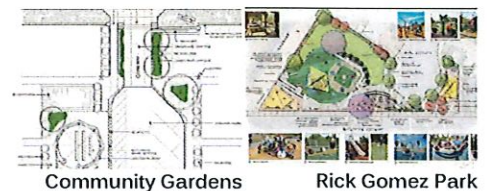



# HICKS CANYON PARK

Hicks Canyon Park in Irvine has recently undergone a remarkable renovation, breathing new life into this beloved community space. The introduction of updated batting cages has brought a wave of excitement to sports enthusiasts of all ages, providing a perfect place for aspiring baseball and softball players to hone their skills. Accompanied by comfortable bleacher seating, family and friends can now cheer on their athletes while enjoying the games. But the park's enhancements go beyond sports, as a well-designed exercise area now offers outdoor fitness equipment, encouraging a healthy and active lifestyle for visitors.

For families, Hicks Canyon Park has introduced new and engaging playgrounds that are sure to delight children. These thoughtfully designed play areas provide a safe and entertaining environment for kids to explore and have fun. The park's transformation signifies a commitment to fostering a sense of community, offering an array of amenities that cater to the diverse interests and needs of residents. Hicks Canyon Park is more than just a park; it's a dynamic, inclusive space that encourages physical activity, social interaction, and memorable experiences for everyone in the Irvine community.



**Client:**  
City of Irvine

**Reference:**  
Anthony Caraveo  
Senior Project Manager  
(949) 724-7555  
acaraveo@cityofirvine.org

**Key Elements:**

- Themed playground
- Batting cages
- Shade structures
- Fitness equipment

**Services provided:**

- Conceptual Design
- Design Development
- Construction Documents
- Construction Period Services

**Acreage:** approximately 1  
**Start Date:** 2018  
**Date of completion:** Feb. 2024  
**Cost of Design:** \$ 76,750  
**Cost of Construction:** \$

**DVD Project Manager:** Sarah Moon  
**Staff:** David Volz, Gary Vasquez, Eric Sterling, Paul Cassar, Luis Pedraza, Dana Bull  
**Subconsultants:** DMS Consultants, Design West Engineering



**More Irvine Projects:**



Irvine Civic Center

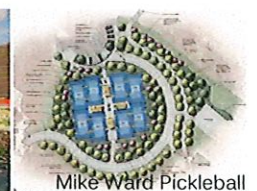

Mike Ward Pickleball



# HOLLYDALE COMMUNITY PARK & COMMUNITY OUTREACH

Hollydale Community Park is being re-envisioned as a multi-faceted recreation center for this easterly section of the Hollydale Community in eastern South Gate. This two acre parcel of land is situated between the railroad tracks that run across the warehouse corridor and Industrial Avenue, the street that separates residential neighborhoods from the commercial sector. The site currently houses a dilapidated ballfield, broken concrete drive and a boarded-up structure that once served as a community room. "Safety first" was the request of the residents who attended the community park planning meetings. The improved park is to have new picnic spaces, a play lawn, open air theater with a movie screen backdrop, benches, play equipment, shade trees and a gateway marker at the neighborhood entryway.

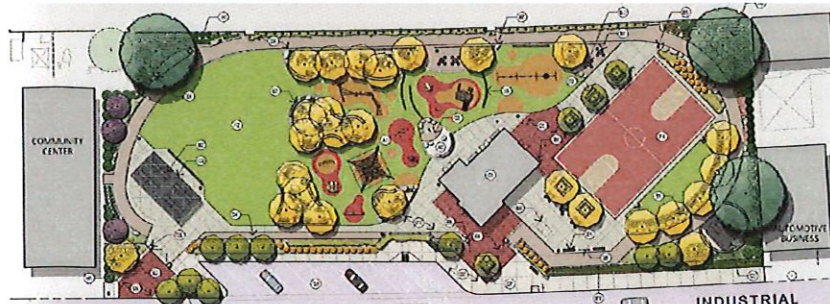
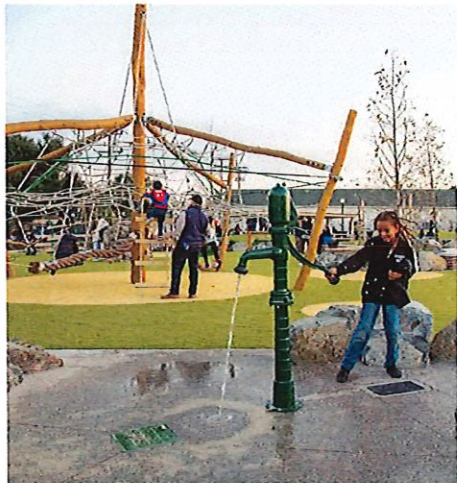

## Client:

City of South Gate

## Reference:

Steve Costley

Interim Director of Parks & Recreation

(323) 563-5494

scostley@sogate.org

## Key Elements:

- Community Center
- Walking Trail
- Basketball Courts
- Playground

## Services provided:

- (8) Community Outreach Workshops & Display Exhibits
- Summary Report
- Design Development
- Final Concept Plan
- Construction Documents
- Grant Application Assistance

Acreage: 1.42

Start Date: October 2017

Completion: January 2025

Cost of Design: \$253,000

Construction Cost: TBD

## DVD Project Manager:

Luis Pedraza

Staff: David Volz, Gary Vasquez, Larry Poindexter, Paul Cassar, Dana Bull

Subconsultants: DMS

Consultants, Design West

Engineering, SKA Engineering

## More South Gate Projects:





## FREMONT PARK

The revitalization of Fremont Park will be a great improvement for the citizens of Glendale. It has a special character and being the oldest park in the city, an important historical context; it provides a wonderful greenspace and needed recreational opportunities for the residents who live just north of downtown Glendale. This community, through several outreach meetings, provided DVD park planners with insights related to the park's use and the current needs for recreation. The slate of improvements we planned will be enjoyed by all: new synthetic turf soccer fields, community center, play spaces, picnic grounds and ball courts. New lighting, easy access, and a full perimeter drive path will ensure better security. New parking, new maintenance facilities and a refurbished home for the model railroad club will improve this community focal point.

This busy facility includes an active tennis community with regularly scheduled lessons, tournaments, and play days. There is also a great contingent of drop-in regulars that frequent these courts. An update of the facility was needed, access, lighting and new fencing, and net stations were installed based upon DVD renovation plans. The courts were sawcut, patched and resurfaced to accommodate this facility-wide makeover. The new courts are beautiful, they have state of the art lighting and a new downloadable lighting control.

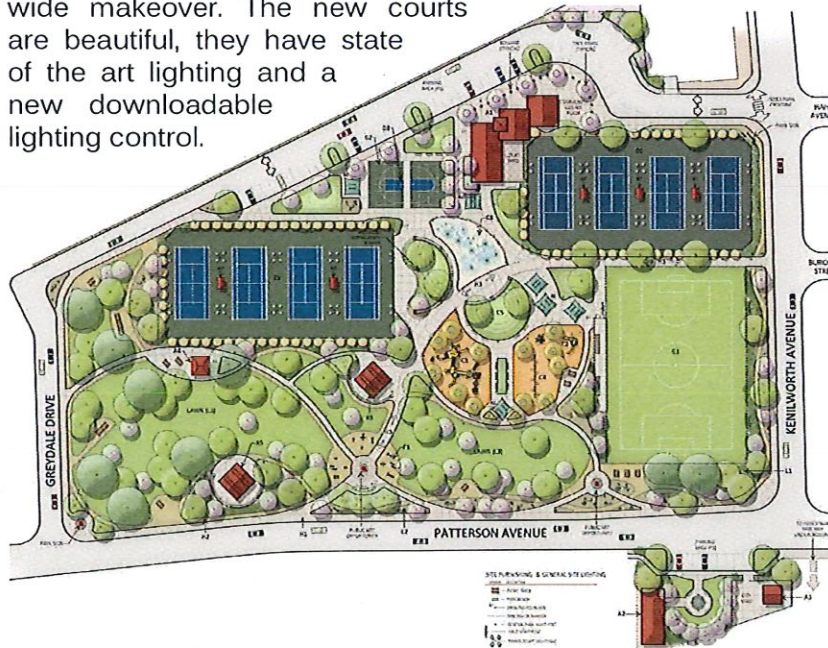

**"DVD and their team ... have provided leadership for community outreach, have designed creative and fun play spaces and have prepared high quality construction documents."**

George Balteria, Retired City of Glendale  
Letter of Recommendation

**Client:** City of Glendale  
**Reference:**  
Joseph Gonzalez  
Park Planner  
(818) 550-4415  
jogonzalez@glendaleca.gov

### Key Elements:

- (8) Tennis courts
- Large community building
- Soccer arena, enclosed, synthetic turf & lights
- Large fully accessible play spaces
- Spray pad play space
- Pickle ball & basketball courts
- Large parking lot
- Open lawn and picnic pavilions
- Art all around the park
- Night lighting throughout
- Walkways & beautiful gardens

### Services provided:

- Master Plan & Community Outreach
- Design Development
- Construction Documents
- Bidding Assistance
- Construction Period Services

**Acreage:** 8

**Start Date:** March 2015

**Completion Date:** Out to Bid Soon

**Cost of Design:** \$1.1 million

**Construction Estimate:** \$12.3 mil

### DVD Project Manager:

Gary Vasquez

**Staff:** David Volz, Paul Cassar, Luis Pedraza, Larry Poindexter

**Subconsultants:** Civil Works Engineer, Design West Engineering, LGC Geotechnical, SKA Engineers

### More Glendale Projects:





## SANTIAGO PARK

Santiago Park, located in Santa Ana, is a captivating embodiment of an innovative approach to landscape architecture. This natural haven, radiates a sense of tranquility while offering an array of engaging amenities. The centerpiece is undoubtedly the amphitheater, thoughtfully integrated into the park's layout. The park's organic design philosophy is further accentuated by the inclusion of strategically placed picnic tables that encourage relaxation and social interaction amidst the soothing embrace of nature.

As one ventures through Santiago Park, the meticulously designed walking trails weave an intricate tapestry that connects visitors with the park's abundant natural beauty. The careful balance struck between the park's landscape and the functional trails, creating an immersive experience that allows individuals to immerse themselves in the serene surroundings. Complementing the park's multifaceted appeal, a small playground beckons to younger visitors, offering a space for exploration and play. This holistic approach to design underscores the crafting of public spaces that resonate with the essence of the community they serve.

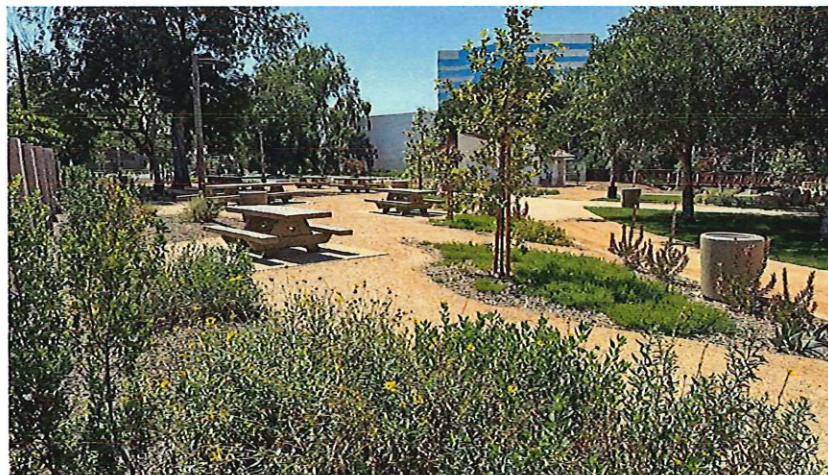
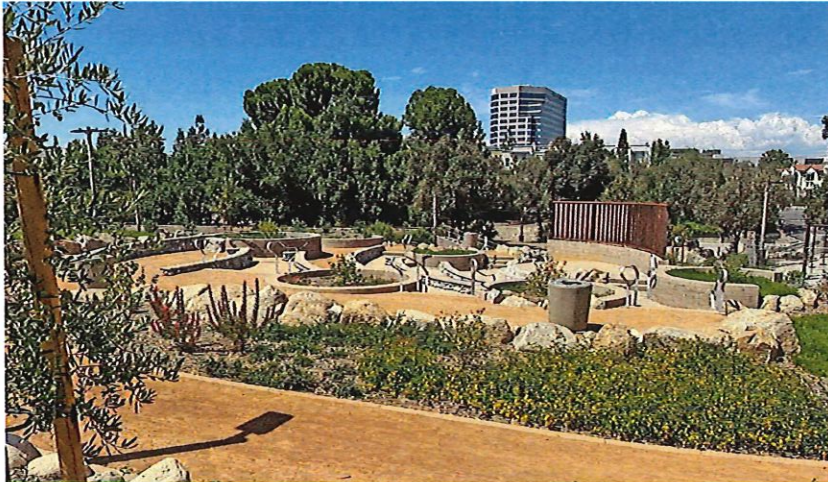

Client: City of Santa Ana

Reference: Suzi Furjanic  
(714) 571-4241  
SFurjanic@santa-ana.org

**Key Elements:**

- Native plantings
- Entry monument
- Amphitheater
- Playground
- Walking trails
- Picnic tables

**Services provided:**

Concept Plan  
Design Development  
Construction Documents  
Construction Period Services

Size: 3.8 acres

Start Date: April 2021

Completion Date: Summer 2023

Design Cost: \$179,343

Construction Estimate: \$16 million

**DVD Project Manager:**

Gary Vasquez

**Staff:**

David Volz, Luis Pedraza, Dana Bull

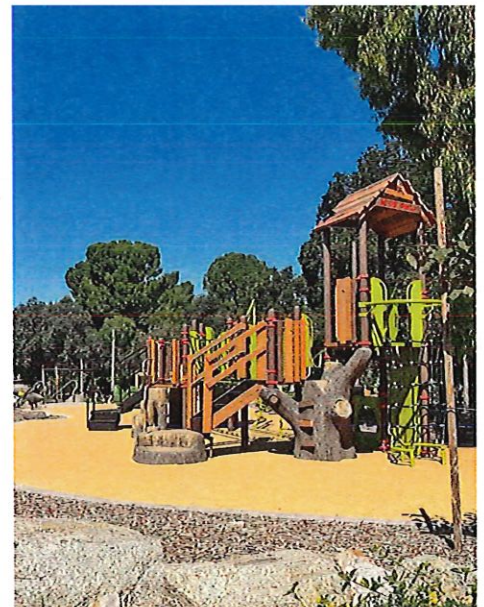

# REFERENCES

Company Name: David Volz Design Landscape Architects, Inc.

1. Name of Reference: Whitaker Park, City of Buena Park

Address: 6650 Beach Blvd. Buena Park, CA 90622

Contact Name: Jim Box Phone Number: (714) 562-3850

Email: jbox@buenapark.com

Dates of Business: June 2019- August 2024

2. Name of Reference: Santiago Park, City of Santa Ana

Address: 20 Civic Center Plaza, Santa Ana, CA 92701

Contact Name: Suzi Furjanic Phone Number: (714) 571-4241

Email: sfurjanic@santaana.org

Dates of Business: 2021- 2023

3. Name of Reference: Hicks Canyon Park, City of Irvine

Address: 1 Civic Center Plaza, Irvine, CA 92606

Contact Name: Anthony Caraveo Phone Number: (949) 724-7555

Email: acaraveo@cityofirvine.org

Dates of Business: 2018 -2024

4. Name of Reference: Hollydale Community Park, City of South Gate

Address: 8650 California Ave, South Gate, CA 90280

Contact Name: Steve Costley Phone Number: (323) 563-5494

Email: scostley@sogate.org

Dates of Business: 2017 - current

5. Name of Reference: Fremont Park, City of Glendale

Address: 613 E. Broadway Glendale, CA 91206

Contact Name: Joseph Gonzalez Phone Number: (818) 550-4415

Email: jogonzalez@glendaleca.gov

Dates of Business: 2015- current



# ORGANIZATIONAL CHART

Our creative designers have the background and expertise to deliver outstanding landscape architecture services for your city's project. The DVD key team members are experienced and talented professionals and they will be supported by a team of licensed landscape architects, several very capable designers, sub consultants, and support staff.

Our design approach, from design development through construction document development, includes strong quality control techniques as well as several quality control measures. For example, our team will have a senior staff landscape architect assigned to specifically provide quality control oversight. This experience landscape architect will be involved in regular in-house design review of project drawings, specifications and budget estimate. He will provide input, and advice to the project administrator. This effort, together with our other quality control measures, will focus on providing the city with a design which is accurate and constructable.

Delivering projects within our client's expectations, budgets and time frame is our top priority. We will establish milestones for deliverables and set precise schedules for meetings and reviews. Our senior management will review all submittals prior to issuance. We will provide recommendations based upon experience and expertise for the betterment of any project assigned to DVD. These same senior DVD professionals will remain the primary contact for the City throughout the project.

David Volz Design looks forward to a long relationship with your city. We are committed to delivering high quality services, designs, reports, documents, and support to the city

City of Huntington Beach  
On-Call Landscape Architect Services

## DAVID VOLZ DESIGN LANDSCAPE ARCHITECTS, INC

Eric Sterling, RLA #5463  
*Principal in charge*

Gary Vasquez, RLA #3883  
*Director of design*

Luis Pedraza, RLA #6782  
*Landscape Architect*

Shaun Johnson, RLA #6413  
*Landscape Architect*

Clayton Franklin, RLA #6909  
*Landscape Architect*

Bryce Frost  
*Landscape Designer*

Bryant Avalos  
*Landscape Designer*

Angela Lee  
*Landscape Designer*

Michelle Maldonado  
*Project Designer*

Xitlali Casarrubias  
*Project Designer*

Jonathan Aguirre  
*Project Designer*

Lisa Namekawa  
*Project Designer*





## ERIC STERLING

### PRINCIPAL IN CHARGE

Mr. Sterling is a highly experienced landscape architect with 25+ years of experience in the field. He is returning to DVD after a 9-year absence exploring worldly projects. Throughout his career, he has worked on a variety

of projects for public agencies, including recreational parks, streetscapes, school sites, and city design guidelines. One of Mr. Sterling's strengths is his attention to detail, which has proven invaluable in his work with playground design, the latest construction practices and materials, and ADA accessibility concerns. He works closely with staff, clients, and agencies to create successful products, and he is especially skilled in working with contractors during construction to ensure that projects are completed successfully.

#### EDUCATION

BS, Landscape Architecture, 2005  
California State Polytechnic University, Pomona

#### SKILLS

AutoCAD, Rhino, Microsoft Office, Adobe Creative Suite, Sketch up, GIS

**YEARS WITH DVD:** 2005 - present

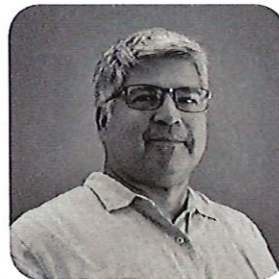

## GARY VASQUEZ

### DIRECTOR OF DESIGN

Mr. Vasquez is a highly experienced and award-winning senior design leader with 30+ years of experience in designing multi-faceted projects throughout California. He is a valuable member of the DVD team providing

creative design solutions to any challenges or opportunities that arise. Over the years, Mr. Vasquez has provided high-quality project management on many of DVD's most successful and highly acclaimed park projects. He is known for his ability to deliver innovative and unique designs that meet and exceed client expectations.

#### EDUCATION

MLA, Landscape Architecture, 1989  
California State Polytechnic University, Pomona  
BS, Ornamental Horticulture, 1986  
California State Polytechnic University, San Luis Obispo

#### REGISTRATION

Landscape Architect, California, #3883, 1992

#### SKILLS

AutoCAD, Adobe Photoshop, Microsoft Office

**YEARS WITH DVD:** 1997 - present

**ROLE:** Works extensively on the development process from inception through master plan development, construction document preparation, contract administration, and on-site inspection. He managed the project to ensure adherence to established project budgets, and schedules.

#### RECENT PROJECT EXPERIENCE

##### COSTA MESA SANITARY HEADQUARTERS

**Client:** Costa Mesa Sanitary District  
A turf removal/water conservation project to provide a boldly vibrant landscape design which incorporates native landscape. These outreach programs include waste reduction, composting and mulching as well as water saving irrigation practices and landscape material selection.

##### WOLFSON PARK EXPANSION

**Client:** City of Rancho Mirage  
Working hand-in-hand with the city to deliver a design that meets the communities' expectations, the overall design needed to fit within the parks' existing Victorian style while accommodating new program features.

##### REFLECTION PARK

**Client:** City of Desert Hot Springs  
The new program includes ADA upgrades, benches, boulders and cobble, new native landscape and irrigation, a reflective monument sign, and a grid of California Fan Palms. The Park will utilize energy efficient night lighting and no turf grass.

##### WHITAKER ELEMENTARY SCHOOL PARK

**Client:** City of Buena Park  
An initial opportunity to provide some dedicated park facilities at Whitaker School has blossomed into a full of fledged "new" park across three acres of school yard. Through a series of community outreach





## SHAUN JOHNSON

### LANDSCAPE ARCHITECT

Shaun discovered his passion for bringing projects from concept to construction fruition. Over the past 15+ years, his diverse experience has spanned residential, theme park, and resort projects, exposing him to a wide array of challenges. The satisfaction of witnessing an idea come to life is the result of creative problem-solving and extensive project management. Shaun firmly believe that 3D models and meticulously crafted construction drawings are instrumental in breathing life into conceptual ideas. This approach has led him to develop innovative techniques and skills that have become standards within the organizations where he has contributed his expertise.

#### EDUCATION

- B.S. Landscape Architecture, California State Polytechnic University, Pomona, 2008

#### REGISTRATION

Landscape Architect, California, #6413

#### SKILLS:

Adobe Creative Suite, Sketch up, AutoCAD, Photoshop, Lumion, Illustrator, Microsoft Office, BIM

**YEARS WITH DVD:** 2024 - present

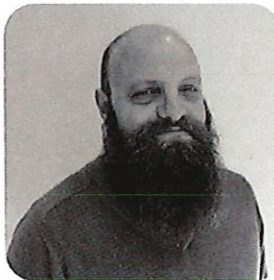

## CLAYTON FRANKLIN

### LANDSCAPE ARCHITECT

With over 15 years of professional experience, Clayton has honed his expertise in landscape architecture through extensive involvement in all phases of design, from Concept Design and Schematic Design to

Design Development and Construction Documentation. Clayton's skill set includes hand drawing, advanced detail drafting, constructability methodologies, and irrigation design.

#### EDUCATION

- B.S. Landscape Architecture, Arizona State University, Tempe, 2008

#### REGISTRATION

Landscape Architect, California, #6909

Landscape Architect, Arizona #70953

#### SKILLS:

Adobe Creative Suite, Sketch up, AutoCAD, Photoshop, Lumion, Illustrator, Microsoft Office,

**YEARS WITH DVD:** 2024 - present

**ROLE:** Works extensively on the development process from inception through master plan development, construction document preparation, contract administration, and on-site inspection. He managed the project to ensure adherence to established project budgets, and schedules.

#### PROJECT EXPERIENCE

##### CENTRAL PARK BLOCK

**Client:** City of Glendale

The modern playground will provide an exciting and safe play area for children, while the splash pad offers a fun way to cool off during hot days. The amphitheater is set to become a focal point for cultural events and performances, enriching the park's role as a vibrant gathering space for residents and visitors alike.

##### LARRY MOORE PARK

**Client:** City of Paso Robles

Larry Moore Park is being upgraded to include new sports fields, enhancing recreational opportunities for the local community. These improvements will provide residents with modern facilities supporting youth and adult athletics in a vibrant and accessible public space.

##### FREMONT PARK

**Client:** City of Glendale

The park's ambiance and the many gathering spaces within the park will be enhanced by new synthetic turf soccer fields, community center, play spaces, picnic grounds, ball courts, and new lighting.

##### PARADISE PARK

**Client:** City of Torrance

The 4.6-acre site features playgrounds, fitness and picnic areas, and structures slated for renovation or replacement, with a focus on creating a cohesive design that interconnects the park's programmed spaces while preserving existing trees.





## LUIS PEDRAZA

### LANDSCAPE ARCHITECT

Luis is skilled in managing and directing professional staff in a dynamic atmosphere, making him an effective leader and team player. His ability to communicate a vision from both the client and his own innovative

stylings is exceptional. Luis's communication skills and visual perception make him capable of creating projects that convey a unique and engaging vision for clients. His passion for design and community outreach, coupled with his years of experience and expertise, make him a valuable asset to any design team.

#### EDUCATION

- MLA, Landscape Architecture, California State Polytechnic University, Pomona, 2017
- Certificate in Ornamental Horticulture, 2011, Orange Coast College, Costa Mesa, Ca
- BA, Graphic Design, 2009, California State University, Fullerton, Ca

#### REGISTRATION

Landscape Architect, California, #6782, 2022

#### SKILLS:

Adobe Creative Suite, Sketch up, AutoCAD, Bilingual - Spanish/English, HTML, CSS, Microsoft Office

**YEARS WITH DVD:** 2013 - present



## BRYANT AVALOS

### LANDSCAPE DESIGNER

Bryant Avalos leads the team of landscape designers, bringing with him a wealth of experience in design development, construction documents, and irrigation design. With a keen eye for detail and a passion for

creating beautiful, functional outdoor spaces. With an eye for detail and a passion for creating beautiful, functional outdoor spaces. He is skilled in using the latest design software and techniques to create detailed plans and visualizations that accurately represent the final product.

#### EDUCATION

BS, Landscape Architecture and Environmental Planning, University State Utah, 2016

#### SKILLS

AutoCAD, Microsoft Office, Adobe Creative Suite, Sketch up, Irrigation Design, GIS

**YEARS WITH DVD:** May 2023 - present

**AVAILABILITY:** 40%

**ROLE:** Works extensively on the development process from inception through master plan development, construction document preparation, contract administration, and on-site inspection. He managed the project to ensure adherence to established project budgets, and schedules.

#### PROJECT EXPERIENCE

##### TURF MEDIAN REPLACEMENT

**Client:** City of Norwalk

This EEMP grant funded project included the removal of turf and replaced with low water use and drought tolerant plantings within medians and side panels.

##### WOODBURY PARK

**Client:** City of Garden Grove

The revitalization of this significant green space in southwestern Garden Grove responds to community desires for enhanced infrastructure. Through comprehensive neighborhood input and on-site meetings, the final concept plan prioritizes an open and visible core, improved safety measures, accessibility, and the incorporation of new recreational elements, ultimately transforming the park into a vibrant community hub.

##### WAYFINDING SIGNAGE

**Client:** City of Gardena

GIS was leveraged to visualize and analyze traffic patterns (road speeds, intersections, Average Daily Traffic (ADT), bike routes, ADA design standards, etc.) and city boundary/zoning information.

##### REFLECTION PARK

**Client:** City of Desert Hot Springs

The new program includes ADA upgrades, benches, boulders and cobble, new native landscape and irrigation, a reflective monument sign, and a grid of California Fan Palms. The Park will utilize energy efficient night lighting and no turf grass.





## ANGELA LEE

### LANDSCAPE DESIGNER

Angela has a unique talent for analyzing data from community input charrettes to help form a common goal of what the community desires. Her ability to communicate the design

vision and goals to the community is a crucial component of her work. She is passionate about creating landscapes that are both functional and visually stunning and strives to exceed client expectations. Her commitment to excellence, coupled with her years of experience, make her an invaluable asset to the team.

#### EDUCATION

- MLA, Landscape Architecture, 2010, University of Michigan, MI
- BS, Cinema-Television Critical Studies, 2003, University of Southern California, CA

#### SKILLS

AutoCAD, Microsoft Office, Adobe Creative Suite, Sketch up, GIS

#### ACCOMPLISHMENTS

- Landscape Architecture Faculty Award, University of Michigan

**YEARS WITH DVD:** 2013 - 2016 & October 2021 - present

**AVAILABILITY:** 40%



## JONATHAN AGUIRRE

### PROJECT DESIGNER

Jonathan's tenure in the landscape architectural field has profoundly shaped his professional identity, instilling in his qualities of dedication, loyalty, ambition, and unwavering

determination. This journey has been marked by a relentless pursuit of new skills and capabilities, driven by a perpetual eagerness to enhance his professional growth.

#### EDUCATION

- BS. Landscape Architecture, California State Polytechnic University, Pomona, 2021

#### SKILLS

AutoCAD, Microsoft Office, Adobe Creative Suite, Sketch up, GIS

**YEARS WITH DVD:** November 2023 - present

**ROLE:** Responsible for analyzing data from our community input charrette process to help form a common goal of what the community desires, prepares landscape architectural plans, specifications, and cost estimates on a multitude of projects, plan checking to ensure consistent update of plan details from client requests.

#### PROJECT EXPERIENCE

##### WAYFINDING SIGNAGE

**Client:** City of Gardena

GIS was leveraged to visualize and analyze traffic patterns (road speeds, intersections, Average Daily Traffic (ADT), bike routes, ADA design standards, etc.) and city boundary/zoning information.

##### COSTA MESA SANITARY HEADQUARTERS

**Client:** Costa Mesa Sanitary District

A turf removal/water conservation project to provide a boldly vibrant native landscape design.

##### WHITE OAK RIDGE

**Client:** City of Orange

The phased landscape renovation of White Oak Ridge will follow a landscape precedent previously established on Trails End Lane. The new landscape will utilize water saving plants and water efficient irrigation.

##### BERKSHIRE & GREVELIA PARKS

**Client:** City of South Pasadena

The Berkshire and Grevelia lots have been purchased and the neighborhood has given initial ideas for the conversion of these properties to pocket parks. DVD designed life back to the exciting park facilities that the neighbors envisioned for their community.





## MICHELLE MALDONADO

### PROJECT DESIGNER

As a recent graduate from the landscape architecture program at Berkeley, Ms. Maldonado brings a strong design background. With her knowledge of AutoCAD and SketchUp, as well as her attention to detail and

ability to work well in a team, she is well-suited to assist with the design and planning of various landscape projects, conduct research and gather data, and prepare cost estimates and project schedules. Her strong communication skills will also be an asset when it comes to client meetings and presentations. She has a great sense of responsibility, and she is eager to learn and grow in the field.

### EDUCATION

BS, Landscape Architecture, University of California, Berkley, 2022

### SKILLS

AutoCAD, Rhino, Microsoft Office, Adobe Creative Suite, Sketch up, GIS

**YEARS WITH DVD:** May 2022 - present



## XITLALI CASARUBBIAS

### PROJECT DESIGNER

Ms. Casarubbias has a strong focus on community engagement and creating designs that are versatile and provide a range of services. By engaging with the community to understand their wants and needs,

she aims to create designs that add meaning and value to the space. Her motivation and team-oriented approach will make her an asset to any team and will ensure the success of any project she works on. Her ability to balance the technical and creative aspects of landscape architecture are valuable skills, and her approach to engaging the community in her designs will bring a unique perspective to the team and projects.

### EDUCATION

BS, Landscape Architecture, University of California, Berkley, 2021

### SKILLS

AutoCAD, Rhino, Microsoft Office, Adobe Creative Suite, Sketch up, GIS

**YEARS WITH DVD:** June 2022 - present

**ROLE:** Assist with the design and planning of landscape projects, including site analysis, conceptual design, and construction documents, Conduct research and gather data on site conditions, materials, and regulations, Participate in client meetings and prepare graphics for presentations.

### RECENT PROJECT EXPERIENCE

#### AROVISTA PARK MODERNIZATION

**Client:** City of Brea

The goal is to create an all inclusive destination park to improve emotional, social, physical, and mental health and where they can explore, discover, relax, and play in a safe and uniquely fun environment.

#### COSTA MESA SANITARY

##### HEADQUARTERS

**Client:** Costa Mesa Sanitary District

A turf removal/water conservation project to provide a boldly vibrant native landscape design.

#### SANTA ANA SPLASH PADS

**Client:** City of Santa Ana

The City of Santa Ana has the opportunity to re-imagine a portion of six existing parks and plan for new splash pads.

#### PICKLEBALL COURTS @ MIKE WARD COMMUNITY PARK

**Client:** City of Irvine

This facility upgrade will include a 8-court layout, electrical upgrades and lighting, shade, player and spectator seating, and other amenities.

#### JURUPA AVENUE MEDIANS

**Client:** City of Fontana

We will consider the already developed street medians and the right-of-way along the project corridor to include the aesthetics of the unique neighborhood characteristics.



# UNDERSTANDING & APPROACH

David Volz Design provides a wide range of services to our public agency clients: site planning, budgeting and preparation of construction documents are the mainstays of the services we provide. Public facilities and landscape improvements we have designed are evident in communities throughout Southern California. We live by our mission statement to "create community" through our designs. Together our firm will be a pro-active knowledgeable resource for your city staff. David Volz Design offers the following services to in the delivery of excellent projects for your citizens:

- Design Services for Capital Improvement Projects-** DVD provides a wide range of services to our public agency clients: site planning, budgeting and preparation of construction documents are the mainstays of the services we provide. Public facilities and landscape improvements we have designed are evident in communities throughout Southern California. This work includes: community and neighborhood parks, public greenspaces, streets and road improvements, and civic center campus improvements. Our creative designs have garnered accolades and awards for our public agency clients. We work closely with city staff, community groups and neighborhoods to develop iconic designs that reflect local community values and enhance the quality of life in cities where we work. We help communities implement their vision of their community through the development of outstanding public spaces.
- General Landscape Architectural Design-** DVD's clients are public agencies throughout Southern California. We specialize in providing public works planning and design services for planting schemes, irrigation systems and hardscape for parks, street medians and all types of public green space.
- Conversion Projects That Address Water Use Challenges-** DVD is currently working on turf conversion and drought response projects for projects in dozens of cities. We are converting high water use medians to drought tolerant plantings in Costa Mesa, San Dimas, Irvine, La Quinta and Commerce. We have a city-wide report and action plan to reduce water use in Cypress's 15 city parks that identifies a 19 million gallon per year water use reduction. DVD has provided plans for park renovations that address water use reductions in South Gate, Irvine, Palm Springs, Rancho Mirage, West Covina and several other southland cities.
- Drip Irrigations, Micro Irrigation, Sub-surface and Specialty Irrigation Installation Expertise -** DVD has provided design

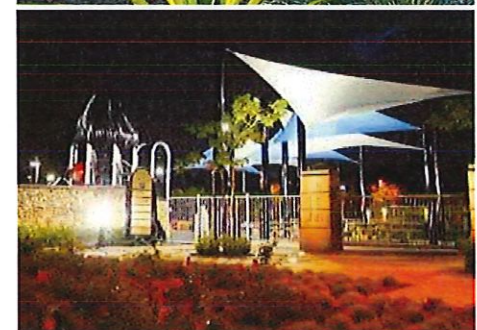



services for new and conversion irrigation systems that utilize the latest technologies for low volume water application. Notable applications include several important installations in the Coachella Valley including Rancho Mirage City Hall, Marine Way in Irvine at the Gateway to the Great Park and Newport Beach's Balboa Boulevard streetscape.

- **Construction Management and Inspection Services Experience** - DVD regularly provides oversight, construction management and inspection services for many of the projects we design and for projects designed by others that are being constructed by our on-call clients.
- **Plan Checking, Peer Reviews and Project Reports** - DVD provides excellent plan check and peer reviews for our clients on all types of landscape oriented projects. We have systems in place for tracking and quick turnaround of any reviews assigned to our firm. Clear and concise review comments are electronically tracked to ensure full resolution of noted deficiencies. One week turn around for reviews is typical for our office.
- **ADA Compliance** - DVD is often asked to design or redesign public spaces to meet and exceed typical accessibility requirements. Several of our clients are very sensitive to the needs of special populations. Public spaces must meet the most stringent elements of the ADA and our designers take to heart our commitment to provide access for all.

David Volz Design will represent the City ensuring the city's interests are met. We will be a faithful member of the city staff and provide informed and thoughtful analysis whenever it is requested. Our team would relish the opportunity to participate in regular meetings with city staff and to provide on-site personnel for any relevant meetings or events. Public agencies are DVD's only clients and our invoicing process will be adapted to meet your requirements. Our accounting staff is friendly and accessible, and can prepare special invoicing and reports at the city's request.

## IN-HOUSE RESOURCES

AutoCAD is our primary design tool for drafting and producing construction documents. The version we use is the latest; AutoCAD 2018. We also use LandFX , a landscape architectural overlay program to aid in our design work and Sketchup for 3D modeling. Microsoft office (Word, Excel, Powerpoint) is for word processing, spreadsheets, and presentations. We also use Prezi to create presentations and slide shows. To prepare graphics and marketing content, DVD uses Adobe suite, InDesign, and Photoshop, Illustrator.

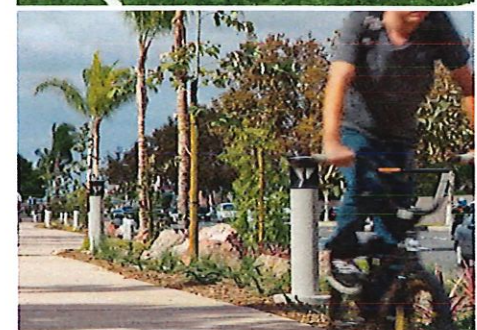
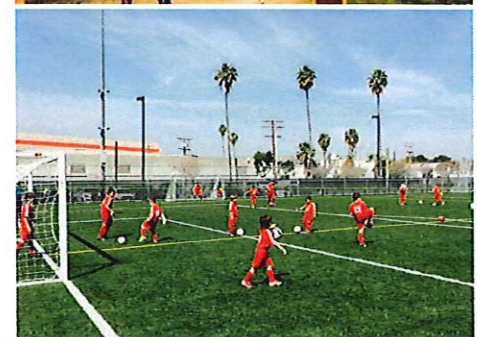
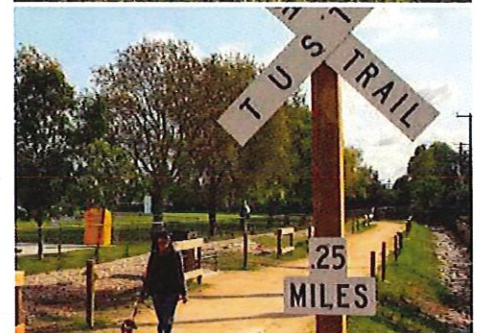



# CREATIVE, ALL-INCLUSIVE & MULTI-GENERATIONAL PLAYGROUNDS

David Volz Design creates fantastic, wonder-filled, memorable play lots. Our firm has been widely recognized for delivering outstanding public park play environments that have garnered praise and accolades from local communities.

- Our whale fossil interpretive play space in Laguna Hills has been featured online blogs, local and regional newspapers and national magazines.
- The wagon train and pioneer play environment in Pioneer Park, Tustin, won several regional and state-wide awards, and was selected for a recognition by the National Recreation and Park Association.
- Our Stanton Train Park, Central Park, is featured in the CPRS District Ten Hall of Fame.
- Admiral Kidd Park, an award-winning play space, features kid size replicas of the four boats named for the Admiral. This Long Beach park was a featured stop on the state park operations annual tour of premiere park facilities.

Our play space design philosophy is built on the perspective of a kids-eye-view. Adventure, surprise, familiar and challenging settings, and themes, memorable spaces. Kids may not know the proper name of the park, but they know that there is a special play lot at airplane park, rocketship park, baseball coach park, train park, and tree house park. The goal is to create an immersive environment that will engage guests and create lasting memories.

We recognized the importance of providing for multi-generational intermingling, on the play lot, as caregivers overseeing the play space and for adults a calm, shaded comfortable surveillance spot to enjoy the space at the park. Our play area design reputation has lead to collaborations with all-access advocates and organizations. We have designed several park play environments as the lead landscape architect for Shane's Inspiration.

This work and design workshops with emotionally and physically challenged stakeholder advocates has informed our design perspective on inclusive, accessible, and caregiver insights that influences our play lot design. One of DVD's most recent Shane's Inspiration play lots is located in El Cariso Park, an LA County Park. At this park the interactive multi-story "equipment" is the center piece of an elaborate all access play environment. Access for all is provided within the terraced natural slope of the existing park terrain. There is plenty of seating for caregivers, play pieces that encourage multi-generational, multi-fun seeker collaborative play opportunities. This is a special park, well worth a trip to this Sylmar Community Park.

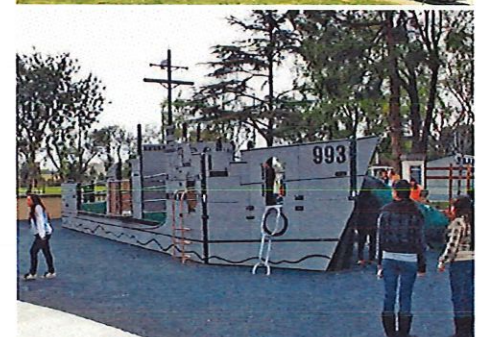
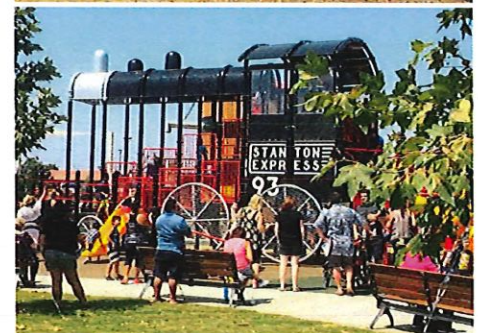
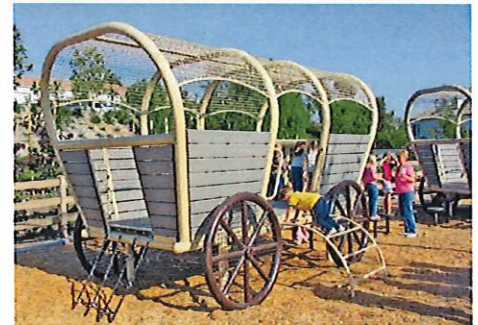



# SUSTAINABILITY & LOW IMPACT DESIGN

David Volz Design is committed to delivering public landscapes that are sustainable and beautiful. We embrace the principles of design that encourage stewardship of our resources, respect for the environment and creative sustainable practices. Through our affiliation with LEED's, we identify and quantify the sustainability of our designs. Our team has extensive experience with Public Works Agencies delivering storm water management practices that mimic natural hydrological cycles. We implement integrated management practices into every project.

Low Impact Design development (LID) is an alternative site design strategy that uses natural and engineered infiltration and storage to control storm water where it is generated. Projects under LID's design are uniquely site specific in their effort to reduce runoff and volume, reduce pollutants and fertilizers, and maintain pre-development surface temperatures. All of which are problematic for conventional storm water management. Key goals include reducing downstream flooding, erosion, and scour from natural waterways. Benefits of LID practices include cost saving over expensive infrastructure. Utilizing bio-swales and sunken lawns allow for the discernment and infiltration of runoff. Bio-swales offer opportunities for biodiversity utilizing native plant material that can remedy the degradation of native habitats. Additionally, LID aesthetics can enhance and beautify the built environment and landscapes by use of pervious pavers and alternative natural paving materials.

A beautiful and sustainable landscape starts with a clear understanding of the client's requirements, the site and environs and a creative approach to the design process. Water efficiencies, energy use reductions, waste reduction, recycled content and localized material's sourcing can all be quantified and are an integral part of our design. Resource conservation through the use and specification of recycled and reused materials and identification of locally sourced goods are important sustainability issues. Water resources are conserved through our thoughtful low water use planting schemes, precise irrigation layout and control systems, as well as, stormwater capture, cleaning and reuse. For pollution prevention, stormwater recycling plans are embraced and integral to our designs. On-site water detention, bio filtration, permeable pavement, and many other measures are creatively incorporated into the landscapes we design.

David Volz Design is dedicated to the opportunity and challenge of creating unique spaces and special places that draw inspiration from the environs and the community. David Volz Design believes the very definition of sustainability speaks of environments that are well used and enjoyed, and maintainable over time. We at DVD believe that the ultimate measure of sustainability of any public space has to be high use and enjoyment over the long term.

## Low Impact Design Benefits

- Reduce runoff/reduce flooding
- Reduce pollutants & fertilizer
- Reduce sediment runoff & scour
- Improved infiltration ground water recharge
- Cost savings over conventional design
- Biodiversity in the urban habitat
- Streamlined design functionality
- Aesthetics

## Low Impact Design IMPs Non-Structural:

- Reduced impervious areas
- Disconnect from conventional storm water systems
- Reduce disturbed areas of development
- Minimize grading/reduce construction impacts
- Preserve natural drainage and vegetation

## Structural:

- Bioretention including vegetated swales and bio-swales
- Permeable pavements
- Green roofs
- Cisterns / Recycling

Storm Water Retention & Cleaning

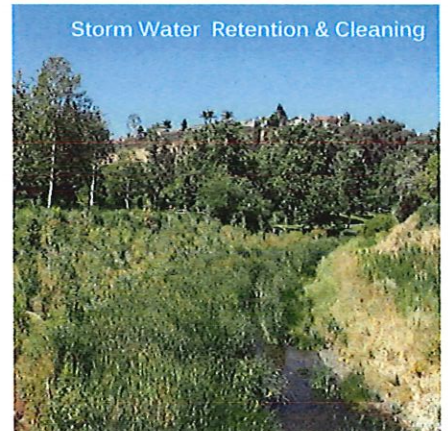



# COMMUNITY OUTREACH

For any community inspired design program, DVD envisions a robust community engagement process. Our initial community meeting will be a participatory community brainstorming session focused on gathering ideas for developing a park master plan. Our preparation for this input will include site reviews and analysis of the plans and documents related to this park site. We will gather "seed" ideas from city staff and from our own site reviews. Our team will assist in the preparation of notices and graphics to get the word out - to invite the community to help design their park.

We will begin the initial workshop with an on site tour of the park to clearly identify the setting. To foster the "brainstorming" session, our team will introduce "seed" ideas that will encourage thoughtful responses and open the discussion for brainstorming and continued idea generation. We will look to the community for ideas about possible improvements, including ideas for enhancement, family recreation and complimentary opportunities to develop the design of an outstanding park plan.

The DVD team will take the ideas and inspirations received from the community at the initial design charrette meeting and refine the ideas and proposed elements into initial concept plans. These conceptual layouts will be presented to city staff in an idea consolidation meeting. The best ideas and themes will then be refined into conceptual plans for the community to consider. The second community workshop will be a bit more formal. The refined initial concept plans will be presented, and the ideas reviewed. We will look for agreement from the participants on the elements which will become a part of the draft master plan. Comments and input will be received to refine the park's vision and program and to obtain consensus for the improvement elements for the park. Following, a draft master plan and draft design report will be prepared. This plan will then be presented to the public and the Commission or Council for review and comment. Upon the city leader's direction a final master plan will be prepared.

The Master Plan, which will be the focus of our planning efforts, will be the culmination of the community's ideas being honed into a final graphic representation of the best development strategy for this park. A report will also be prepared outlining the input process and describing the program and development elements. Also, a preliminary construction budget will be a part of this project report.

The community workshops that we facilitate are the best medium for finding out what the citizenry desires. Allowing the community to stand in a place of ownership aids in a smooth planning process. In the long term, this ownership translates into projects that are sustained by the community.





# GRAPHICS & RENDERINGS

**WHAT IF A VISUALIZATION OF AN IDEA COULD BRING CLARITY TO THE DESIGN INTENT? COULD ALLOW FOR ENLIGHTENED CONSIDERATION AND UNDERSTANDING?**

The David Volz Design studio has a robust graphic design component, and skilled professionals adept at delivering graphics and images, including immersive 3-dimensional fly throughs that communicate our design ideas before moving ahead with the project's engineering.

Communication is the key to understanding. The photo-realistic renderings, computer-generated 3D models, and images of the project style, detailing, form, and function provide a clear understanding of the project concepts. Our creative and innovative designs are beautifully rendered for review and consideration of civic leaders, our collaborative partners, and the general public. Our visualizations have resulted in great feedback and design considerations, great "Now I Get It" moments, and enthusiastic approvals of concepts, ideas, and projects.

The DVD team has proven capabilities for the graphic presentation of the ideas and the layout for review of the park's conceptual layout. We will prepare artist renderings, 3D fly through videos and photo realistic pictures to describe the many elements we plan to include in this development. We will ready all our renderings for social media posting and for use in city communications.

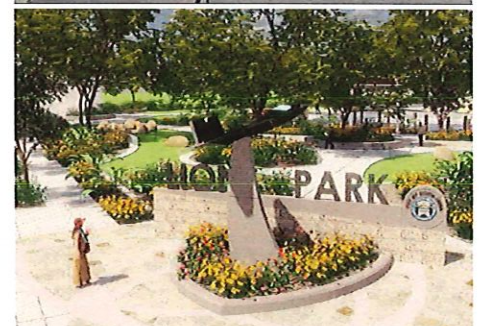
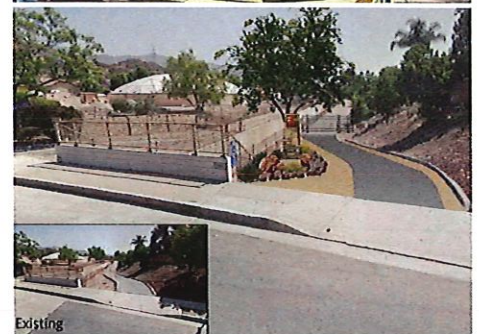



# TYPICAL SCOPE OF SERVICES

David Volz Design regularly provides a full scope of services for the development of public facilities, parks and green spaces. The services usually include public outreach, concept development, presentations and reviews by appointed and elected officials, and complete construction document plan sets. Acting as an extension of the city's staff, Mr. Volz and the DVD professionals, have become a valuable resource for innovation and creativity, as well as support in the development of design standards, technical specifications, budget estimates, construction methods and administration, claims and change order reviews, quality control, and product performance evaluation. Our design professionals will take a proactive role by clearly defining the project program as the initial project task. We will establish milestones for deliverables and set precise schedules for meetings and reviews. We will provide recommendations based upon experience and expertise for the betterment of any project assigned to DVD. The following is a typical scope of service, but does not necessarily apply to all projects.

## PHASE ONE: PROJECT INITIALIZATION

### Task One - Project Start-up

- 1.01 Initial kickoff meeting with city project staff
  - a. Review project criteria and program objectives
  - b. Review procedures and design schedule
  - c. Assign calendar dates to each milestone
- 1.02 Data collection
  - a. Prepare site survey
  - b. Collect utility information
  - c. Catalogue available documents and plans
- 1.03 Perform field investigations
  - a. Prepare photo survey of site
  - b. Annotate maps from the site review

### Task Two - Geotechnical Report

- 2.01 Geotechnical soils report and recommendations

### Task Three - Site Survey and Water Quality Initial Studies

- 3.01 Site topographic survey
- 3.02 Initial hydrology study

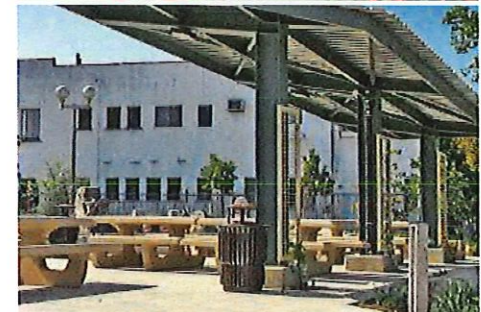
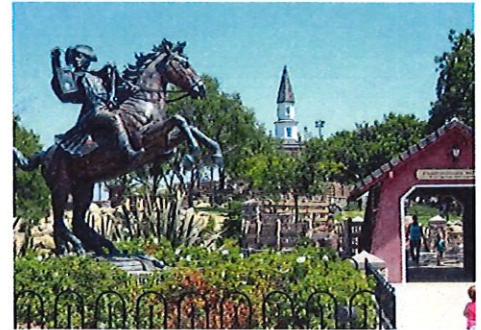



3.03 Initial SWPPP/WQMP Plans

**PHASE ONE: DELIVERABLES + MEETINGS**

Topographic survey of site  
Design development plans  
SWPPP / WQMP and site Hydrology Study  
City staff reviews as needed  
Meetings with city staff

**PHASE TWO: COMMUNITY ENGAGEMENT**

**Task 1 – Initialize Project and Community Workshop**

- 1.01 Background Research
  - a. Collect available data and maps
  - b. Meet with city project personnel
  - c. Review Preliminary project program
  - d. Review plans and documents of the site
  - e. Review initial opportunities
    - Identify opportunities and constraints
    - Identify surrounding uses and connections
- 1.02 Prepare base map for planning purposes
- 1.03 Meeting with city staff to review work to date
- 1.04 Initial community review and workshop
  - a. Meet with the community on site
    - Conduct site walk
    - Discuss opportunities and objectives
    - Review limitations and challenges
    - Review program opportunities
    - Facilitate design charrette with community participants
    - Gather initial ideas and direction
- 1.05 Document input received
  - a. Prepare summary of input from community
  - b. Annotate maps with community insights

**Task 2 – Preliminary Concept Plans**

- 2.01 Review input received with city staff
  - a. Identify opportunities and program for potential park facilities.
- 2.02 Prepare preliminary concept plan(s)
  - a. Develop designs for park improvements
  - b. Develop concepts and alternatives
  - c. Refine and consolidate ideas
  - d. Prepare initial concept plan map
  - e. Prepare preliminary concept packet review meeting

**Task 3 – Cost Benefit Analysis and Presentation**

- 3.01 Cost benefit analysis
  - a. Prepare analysis of construction cost for each concept plan
  - b. Provide comparison of each concept offering and comparative costs
- 3.02 Present concept plans
  - a. Review background and challenges
  - b. Present initial concept and alternatives
  - c. Gather input from commission
  - d. Seek consensus on collective vision
- 3.03 Document input
  - a. Document input and comments
  - b. Consolidate comments into summary letter report
  - c. Review work to date with city staff

**Task 4 – Final Concept Plans and Reports**

- 4.01 Prepare final master plan
  - a. Review schematic layouts with city staff, obtain direction to prepare draft master plan
  - b. Prepare draft master plan map
  - c. Prepare draft project letter report
  - d. Prepare presentation for Commission/Council
- 4.02 Presentation to Commission/Council

## PHASE TWO: DELIVERABLES + MEETINGS

Community workshop on site  
Initial program identification  
Initial idea sketches (by community members)  
Summary of comments and input  
Meetings with city staff  
Project planning map  
Preliminary concept plans  
Parks Facility Program  
Concept plan presentation  
Initial plans  
Summary of comments and inputs  
Presentation to Commission/Council  
Summary of input and process  
Turn over electronic files of plans

## PHASE THREE: DESIGN DEVELOPMENT

### Task 1 - Design Development

- 1.01 Concept plan development (two alternative plans)
  - a. Prepare graphic plans for proposed features
  - b. Identify locations and alternatives for boundaries, amenities and fences
  - c. Provide alternatives for plant materials and constructions
    - Fences, gates and pathways
    - ADA access
    - Seating and site furnishings
    - Landscape concept
    - Materials board
  - d. Provide play and exercise equipment
  - e. Provide exhibits and plan view concepts
    - Plan view concepts
    - Photo simulations

### Task 2 - Site Plan

- 2.01 Provide site layout plan
- 2.02 Reviews as required with city staff
- 2.03 Provide final site plan colored rendering

### Task 3 - Community Reviews, Park Design Modification Application

- 3.01 Assist in processing park design modification application
- 3.02 Present project concept plans at up to two community services commission meetings
- 3.03 Update plans as required
- 3.04 Provide approved park design modification plans in high-resolution format following commission approval

### Task 4 - Preliminary Engineering

- 4.01 Grading and drainage plan
- 4.02 On site hydrology
- 4.03 WQMP
- 4.04 Utilities

### Task 5 - Opinion of Probable Construction Cost Projection

- 5.01 Breakdown of cost by unit and quantities

### Task 6 - CEQA Document and Environmental Studies

- 6.01 Prepare required California Environmental Quality Act Documentation (mitigated negative declaration anticipation)
- 6.02 Prepare Water Quality Studies as required
- 6.03 Prepare supplemental studies if needed
- 6.04 Prepare additional technical studies, if needed. i.e. traffic, biology, etc.

### Task 7 - City Staff Meetings

- 7.01 Four meetings with city staff anticipated.



**PHASE THREE: DELIVERABLES + MEETINGS**

Site layout plans and exhibits  
Materials selection  
Hydrology study  
Updated rendering  
Park Design Modification Plan  
CEQA document  
Staff meetings  
Commission/Council meeting

**PHASE FOUR: CONSTRUCTION DOCUMENT DEVELOPMENT**

**Task 1 - Construction Documents Development**

- 1.01 Schedule verification
- 1.02 Program review and verification
- 1.03 Prepare base maps
- 1.04 Prepare construction drawings
  - a. Final engineering report
  - b. Site construction plan and details
  - c. Irrigation plan and details
  - d. Final landscape plan and details
  - e. Final cost projection
  - f. Construction document
- 1.05 Prepare technical specifications
- 1.06 Prepare construction cost budgets
- 1.07 Submittal/review at 60% documents

**Task 2 - Final Construction Documents**

- 2.01 City project team review of work-to-date
- 2.02 Internal quality control review
- 2.03 Revise documents
- 2.04 Turnover of original plans and specifications

**PHASE FOUR: DELIVERABLES + MEETINGS**

Construction plans  
Construction technical specifications  
Construction budget estimate

City staff services as needed  
Staff meetings

**PHASE FIVE: BIDDING AND CONSTRUCTION ASSISTANCE**

**Task 1 - Bidding Assistance**

- 1.01 Provide answers to pertinent pre-bid questions
- 1.02 Assist the city in evaluation of bids

**Task 2 - Construction Assistance**

- 2.01 Attend pre-construction meeting
- 2.02 Respond to project Requests for Information (RFI's)
- 2.03 Attend pre-construction meeting
- 2.04 Participate in construction progress meetings and prepare meeting summary notes
- 2.05 As-built plan preparation (contractor annotation)

**PHASE FIVE: DELIVERABLES + MEETINGS**

Bidding assistance  
RFI responses, instructions  
Meeting summaries  
As-built plan preparation  
City staff support services

# QUALITY CONTROL

DVD has an established quality control and assurance program that we undertake for all our design services, and for this project. The Principal-in-Charge will be responsible for implementation of these Quality Control measures. The primary elements include:

- Verification that required deliverables and documents noted in the Scope of Work are provided.
- A Peer Review will be conducted by our senior professional staff to solicit critical comments and verify correctness.
- Retention of documents with highlighted markings and red-line comments, and verification that required revisions are incorporated into the updated documents.
- Continual assessment and tracking of project schedule and budget against baseline data.
- A complete construction review for constructability and biddability of the complete PS&E package will be assigned to experienced professionals on staff prior to final submittal to our client.

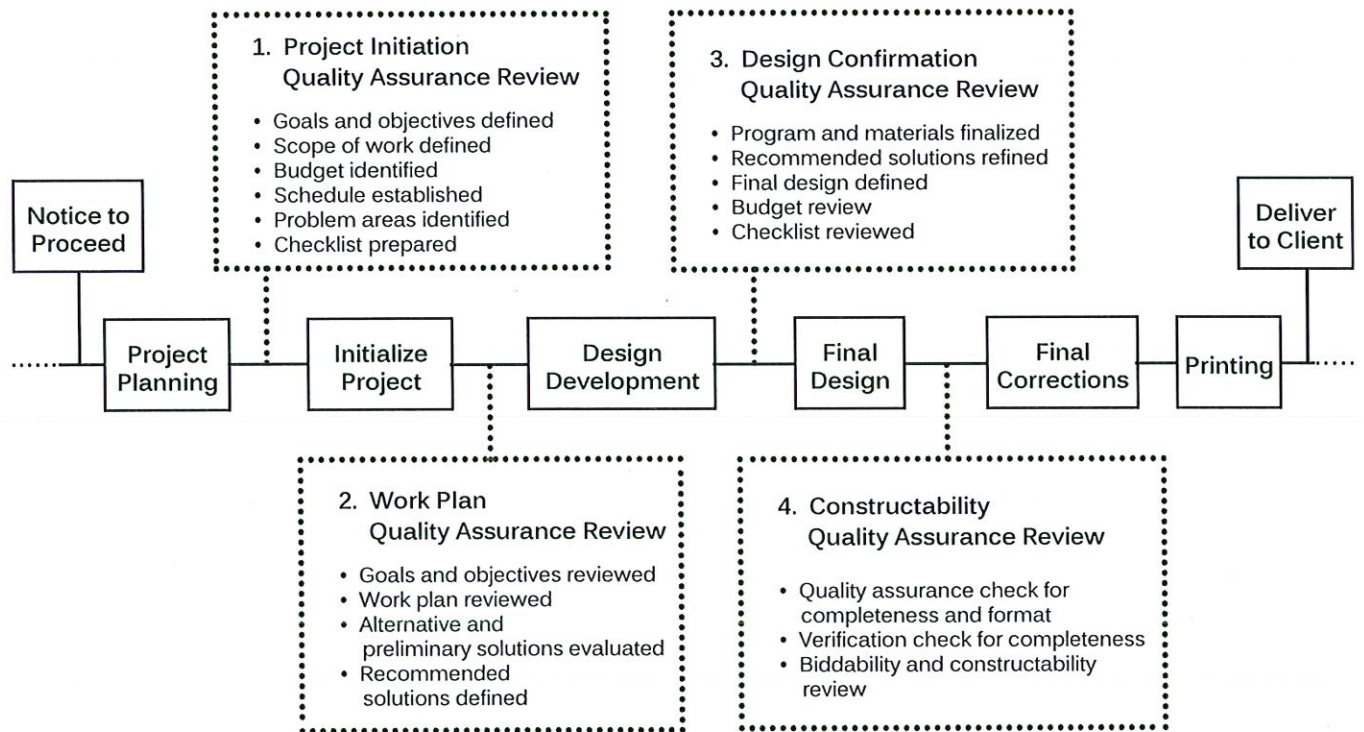

## WHY CHOOSE DAVID VOLZ DESIGN?

Creative  
Designers of  
Public Spaces

Cost Controls  
and Quality of  
Design with Rich  
Detailing

Online Public  
Outreach Expertise  
Community  
Inspired Park  
Design

Award Winning  
Park and Sports  
Field Design

Experience  
in Delivery of  
Projects



# APPENDIX



## SMALL BUSINESS

To verify most current certification status go to: <https://www.caleprocure.ca.gov>



## Office of Small Business &amp; DVBE Services

Certification ID: 25194

Legal Business Name:

David Volz Design Landscape Architects, Inc.

Doing Business As (DBA) Name 1:

David Volz Design

Doing Business As (DBA) Name 2:

Email Address:

astafford@dvolzdesign.com

Business Web Page:

Business Phone Number:

714/641-1300

Business Fax Number:

Address:

151 Kalmus Drive

M-8

Costa Mesa

CA 92626

Business Types:

Service

Certification Type	Status	From	To
SB(Micro)	Approved	10/15/2024	10/31/2026
SB-PW	Approved	10/15/2024	10/31/2026



## Contractor Information

**Legal Entity Name**  
DAVID VOLZ DESIGN LANDSCAPE ARCHITECTS, INC.

**Legal Entity Type**  
Corporation

**Status**  
Active

**Registration Number**  
1000031128

**Registration effective date**  
07/06/23

**Registration expiration date**  
06/30/26

**Mailing Address**  
151 KALMUS DRIVE, M-8 COSTA MESA 92626 CA U...

**Physical Address**  
151 KALMUS DRIVE, M-8 COSTA MESA 92626 CA U...

**Email Address**  
jgraham@dvolzdesign.com

**Trade Name/DBA**  
DAVID VOLZ DESIGN

**License Number (s)**  
Other:LA 2375  
Other:LA 3883  
Other:LA 4657

## Registration History

Effective Date	Expiration Date
07/03/18	06/30/19
06/01/17	06/30/18
07/06/16	06/30/17
10/21/15	06/30/16
03/04/20	06/30/20
10/27/20	06/30/21
07/01/21	06/30/22
07/01/22	06/30/23
07/06/23	06/30/26

## Legal Entity Information

Corporation Entity Number:	43248202
Federal Employment Identification Number:	330835124
President Name:	David Volz
Vice President Name:	
Treasurer Name:	
Secretary Name:	
CEO Name:	

Agency for Service:

**Agent of Service Name:** Jamie Graham

**Agent of Service Mailing Address:** 151 Kalmus Drive, M8 Costa Mesa 9262

LEED



GREEN BUILDING CERTIFICATION INSTITUTE

HEREBY CERTIFIES THAT

David Volz

HAS ACHIEVED THE DESIGNATION OF

LEED® ACCREDITED PROFESSIONAL

BY DEMONSTRATING THE KNOWLEDGE OF GREEN BUILDING PRACTICE  
REQUIRED FOR SUCCESSFUL IMPLEMENTATION OF THE LEADERSHIP IN ENERGY  
AND ENVIRONMENTAL DESIGN (LEED®) GREEN BUILDING RATING SYSTEM™.



*Rubén L. Flores*  
Chairman

March 28, 2008  
Date Issued

*S. Richard Fedrizzi*  
S. Richard Fedrizzi, President and CEO

Printed on 50% bamboo fibers / 50% post-consumer fibers with vegetable based inks.

QSD/P

CERTIFICATE OF TRAINING  
CALIFORNIA CONSTRUCTION GENERAL PERMIT

QUALIFIED SWPPP DEVELOPER (QSD)  
AND  
QUALIFIED SWPPP PRACTITIONER (QSP)

David Volz

Jul 20, 2021 - Jul 22, 2023

Certificate # 01176



California Stormwater Quality Association and  
California Construction General Permit Training Team



# LETTER OF RECOMMENDATIONS



COMMUNITY SERVICES DEPARTMENT  
JIM BOX, DIRECTOR

February 6, 2023

RE: Recommendation in Support of David Volz Design Landscape Architects, Inc.

To Whom It May Concern:

David Volz Design has provided high-quality design and consulting services to the City of Buena Park for many years. They have provided park planning, leadership at public outreach meetings, creative park design, developed construction documents, and construction period services on several park projects.

Two notable projects the City of Buena Park is exceptionally proud of is the Rick Gomez Park and most recently, the Whitaker School Park. The projects include a high level of design and a team of sub-consultants under David Volz Designs' contract. David Volz Design team welcomed community input at outreach gatherings to design creative, interactive play areas and inviting, green spaces.

David Volz Design has always provided the City of Buena Park with high-quality professional service for these projects and many others. I highly recommend David Volz Design to your agency.

Sincerely,

Jim Box  
Director of Community Services  
City of Buena Park  
(714) 562-3850  
JBox@BuenaPark.com

**"David Volz Design has always provided the City of Buena Park with high-quality professional services for these projects and many others."**

650 Peach Street | P.O. Box 509 | Buena



**CITY of CYPRESS**

5275 Orange Avenue, Cypress, California 90630  
Phone 714-229-6700 www.cypressca.org

February 7, 2023

RE: Recommendation in Support of David Volz Design Landscape Architects

To Whom It May Concern:

The City of Cypress has collaborated with David Volz Design on several important park development and landscape projects. The recently completed city-wide Median Restoration Project, an APWA award-winning project, restored the landscaped medians and parkways throughout the City with new drought-tolerant landscaping and drip-irrigation systems, providing for a cohesive design aesthetic throughout the city, while also conserving water in light of the recent droughts. DVD and their team provided exceptional service throughout the project and prepared high quality construction documents.

I would highly recommend to any agency the firm of David Volz Design. My contact information is listed below. Please contact me for further comments in support of this firm.

Sincerely,

Nick Mangkalakini, P.E.  
City Engineer  
nmangkal@cypressca.org

**"DVD and their team provided exceptional service throughout the project and prepared high quality construction documents."**



CITY OF GARDEN GROVE

Steve Jones  
Mayor  
George S. Brietlgam  
Mayor Pro Tem - District 1  
John R. O'Neill  
Council Member - District 2  
Cindy Ngoc Tran  
Council Member - District 3  
Joe DoVinh  
Council Member - District 4  
Stephanie Klopfenstein  
Council Member - District 5  
Kim Bernice Nguyen  
Council Member - District 6

February 2, 2023

RE: Recommendation in Support of David Volz Design Landscape Architects, Inc.

To Whom It May Concern:

David Volz Design has provided high quality design and consulting services to the City of Garden Grove for many years. They have provided park planning, provided leadership at public outreach meetings, provided creative park design, developed construction documents and provided construction period services on several park projects.

One notable project is the Woodbury Park Revitalization Project, which includes a high level of design and a team of sub-consultants under David Volz Designs' contract. This project is a Prop 68 grant award that will allow a complete renovation, of an under used park, to be brought back to life for an underserved community. DVD has done an outstanding job of meshing the needs of the community with the design request of the Parks and Rec Commission and staff.

DVD has always provided the City of Garden Grove with high quality professional service for these projects and many others. I highly recommend David Volz Design to your agency.

Sincerely,

John Montanez  
Community Services Director  
(714) 741-5214  
johnmo@ggcity.org

**"... a high level of design and a team of sub-consultants under David Volz Designs' contract."**



OFFICE OF THE CITY MANAGER

405 E. Broadway Avenue  
Danville, CA 94504  
P: (925) 950-6800  
F: (925) 941-4246  
lucian@ci.danville.ca.gov

August 21, 2018

Re: Recommendation in Support of David Volz Design Landscape Architects, Inc.

To Whom It May Concern:

The City of Danville has commissioned David Volz Design to provide services on several park design projects. These services have included community-based design process, presentations to commissions and council and creative solutions that have addressed many community needs. Our recently completed Roosevelt Paved is an outstanding DVD designed pedestrian pathway. The paseo has received accolades from the community and nearby elementary school served by the pathway.

Should additional information be required, please call me at the city number. I recommend David Volz Design to any agency looking for creative and professional landscape architectural services.

Sincerely,

Luis Polan  
City Manager  
lpolan@ci.danville.ca.gov

**"I recommend David Volz Design to any agency looking for creative and professional landscape architectural services."**

**DVID**





14717 BURIN AVENUE • LAWDALE, CALIFORNIA 90260 • (310) 973-3200 • FAX (310)

September 4, 2019

RE: Recommendation In Support of David Volz Design Landscape Architects, Inc.

To Whom It May Concern:

The City of Lawndale has collaborated with David Volz Design on two important park development projects in the city, including the recently completed Hogan Park renovation and expansion project, which included expansion of an existing park, street closure, utility relocation and provision of play areas for children aged 5 to 12 years old.

In addition, David Volz Design also collaborated with the City of Lawndale on Charles B. Hopper Park, a new one acre park designed and built on a former California Department of Transportation property within the City of Lawndale.

DVD's team welcomed community input at a number of outreach gatherings to design creative and interactive play areas and inviting green spaces for both projects.

I would highly recommend David Volz Design to any agency. My contact information is listed below. Please contact me for further comments in support of this firm.

Sincerely,

Mike Estes  
Director of Community Services  
City of Lawndale  
(310) 973-3272  
mestes@lawndalecity.org

"DVD's team welcomed community input at a number of outreach gatherings to design creative and interactive play areas and inviting green spaces for both projects."



February 9, 2023

RE: Recommendation In Support of David Volz Design Landscape Architects, Inc.

To Whom It May Concern:

The City of Norwalk has collaborated with David Volz Design on several important park development projects. The recently completed concept design for Hermosillo Park was submitted to the State of California for a Proposition 68 grant, and the City has been awarded \$8.5 million to build a new community center, park amenities, parking lot, lighting and landscaping. DVD and their team were instrumental in the success of securing the grant for this project. The design was creative and utilized the entire park site to provide a variety of areas for sports, leisure and community gatherings.

I would highly recommend to any agency the firm of David Volz Design. My contact information is listed below. Please contact me for further comments in support of this firm.

Sincerely,

Christine Roberto  
Public Services Manager  
croberto@norwalkca.gov  
(562) 929-5708

"DVD and their team were instrumental in the success of securing the grant for this project."

## LETTER OF RECOMMENDATIONS



City of South Gate

Parks & Recreation Department

WWW.CITYOFSOUTHGATE.ORG

Parks Make Life Better!

Steve Costley  
Director of Parks & Recreation

February 1, 2023

RE: Recommendation In Support of David Volz Design Landscape Architects, Inc.

To Whom It May Concern:

David Volz and his team at David Volz Design have provided superior service to the City of South Gate on a variety of projects to improve our parks over the last twelve years. From Master Planning and Community Outreach to whole park renovations, providing creative, sustainable and usable designs that enhance our community and excite our park goers, David Volz Design has consistently met all expectations.

Please feel free to contact me if you have any specific questions or would like additional information. We have had nothing but the best experiences with DVD and would enthusiastically recommend them to anyone looking for a top-quality landscape design firm for your public project.

Sincerely,

Steve Costley,  
Director of Parks & Recreation  
323-563-5494  
scostley@sogate.org

"From Master Planning and Community Outreach to providing creative, sustainable and usable designs that enhance our community and excite our park goers, David Volz Design has consistently met all expectations."



September 17, 2019

RE: Recommendation In Support of David Volz Design, Landscape Architects, Inc.

To Whom It May Concern:

The City of Paramount collaborated with David Volz Design on several important park development projects, including recently completed conceptual park design documents for three of our parks, as well as a conceptual design for proposed park amenities utilizing Southern California Edison (SCE)'s right of way land.

The DVD's team welcomed community input at outreach gatherings to design creative, interactive play areas, and inviting green spaces.

DVD has always provided the City of Paramount with high quality professional service and I would highly recommend David Volz Design to any agency. My contact information is listed below. Please contact me for further comments in support of this firm at 562-220-2100.

CITY OF PARAMOUNT

Adriana Figueroa  
Public Works Director

"DVD has always provided the City of Paramount with high quality professional service and I would highly recommend David Volz Design to any agency."

DVD





August 26, 2019

David J. Shawyer  
Mayor

Rigoberto A. Ramirez  
Mayor Pro Tem

Carel Warren  
Council Member

Gary Taylor  
Council Member

Hong Ahye Van  
Council Member

Jared Hildenbrand  
City Manager

RE: Recommendation in Support of David Volz Design Landscape Architects, Inc.

To Whom It May Concern:

The City of Stanton has commissioned David Volz Design to provide services on several park design projects. These services have included community-based design process, presentations to commissions and council and creative solutions that have addressed many community needs. Stanton Central Park is an outstanding DVD designed park. The park has received accolades from the community and design awards from APWA and California Park and Recreation Society. DVD also designed Harry M. Dotson Park which also received design awards from APWA.

Should additional information be required, please call me at the city number. I recommend David Volz Design to any agency looking for creative and professional landscape architectural services.

Sincerely,

Allan Rigg  
Director of Public Works  
(714) 370-0222 ext. 203



CITY OF SANTON  
Parks and Recreation Department

210 WEST 20TH AVENUE  
SANTON, CALIFORNIA 94031-1114  
TELEPHONE: (415) 522-7100  
FAX: (415) 522-7401

"We selected David Volz Design because they have created many award winning unique park designs for other public agencies."

August 2, 2017

To whom it may Concern,

The City of San Mateo is currently working with David Volz Design to provide preliminary design documents for our Borel Park site. They have developed two very creative and innovative design concepts for our newest neighborhood park. We selected David Volz Design because they have created many award winning unique park designs for other public agencies. Most of their park and public agency projects are very well thought out and incorporate history, culture, and art to support a strong theme. All of the components of the design such as site furnishings, paving materials, and the plant selection all work together to support the design concept. David Volz Design does a great job creating attractive and functional public spaces with high recreation value.

Having worked with David Volz Design on several projects at different agencies, I have always found them easy to work with professional and the public appreciates the skills and commitment. I strongly recommend David Volz Design to any public agency seeking creative and professional landscape architectural services.

Greg Meek  
Park Planning Administrator  
(650) 522-7544  
gmeek@cityofsanmateo.org

## LETTER OF RECOMMENDATIONS

"Stanton Central park is an outstanding DVD designed park. The park has received accolades from the community and design awards from APWA and California Park and Recreation Society. DVD also designed Harry M. Dotson Park which also received awards from APWA."

MAYOR  
Vicente Sarmiento  
MAYOR PRO TEM  
Phil Bacerra  
COUNCILMEMBERS  
Jonathan Ryan Hernandez  
Jessie Lopez  
Nafida Mendoza  
David Penabazoa  
Thai Viet Phan



CITY MANAGER  
Kristina Ridge  
CITY ATTORNEY  
Sonia R. Carvalho  
CLERK OF THE COUNCIL

### CITY OF SANTA ANA

PUBLIC WORKS AGENCY  
20 Civic Center Plaza • P.O. Box 1668  
Santa Ana, California 92702  
[www.santa-ana.org](http://www.santa-ana.org)

February 3, 2023

RE: Recommendation of David Volz Design Landscape Architects, Inc.

To Whom It May Concern:

David Volz Design has provided high quality design and consulting services to the City of Santa Ana for many years. They have provided park planning, provided leadership at public outreach meetings, provided creative park design, developed construction documents and provided construction period services on several park projects.

Most notably is the recent Santiago Park Gas House Area Development project, of which David and his team have been a part of from the very beginning. They provided concept design, led community outreach efforts, developed contract documents and are now providing construction support. The project will be completed this spring and is an award winner. We are very excited and are appreciative of the great working relationship we had together, and the expertise they brought to the table.

DVD has always provided the City of Santa Ana with high quality professional service for these projects and many others. I highly recommend David Volz Design to your agency.

Sincerely,

Suzi Furjanic  
Associate Park Planner  
[sfurjanic@santa-ana.org](mailto:sfurjanic@santa-ana.org)

#### SANTA ANA CITY COUNCIL

Mayor Vicente Sarmiento <a href="mailto:vsarmiento@santa-ana.org">vsarmiento@santa-ana.org</a>	Mayor Pro Tem Phil Bacerra <a href="mailto:pbacerra@santa-ana.org">pbacerra@santa-ana.org</a>	Council Member Thai Viet Phan <a href="mailto:thai.viet.phan@santa-ana.org">thai.viet.phan@santa-ana.org</a>	Council Member Nafida Mendoza <a href="mailto:nafida.mendoza@santa-ana.org">nafida.mendoza@santa-ana.org</a>	Council Member Jonathan Ryan Hernandez <a href="mailto:jrhernandez@santa-ana.org">jrhernandez@santa-ana.org</a>	Council Member David Penabazoa <a href="mailto:dpenabazoa@santa-ana.org">dpenabazoa@santa-ana.org</a>
--	---	--	--	---	---

"DVD has always provided the City of Santa Ana with high quality professional services for these project and many others."

DVD

## EXHIBIT "B"

### Payment Schedule (Hourly Payment)

#### A. Hourly Rate

CONSULTANT'S fees for such services shall be based upon the following hourly rate and cost schedule:

SEE ATTACHED EXHIBIT B

#### B. Travel Charges for time during travel are not reimbursable.

#### C. Billing

1. All billing shall be done monthly in fifteen (15) minute increments and matched to an appropriate breakdown of the time that was taken to perform that work and who performed it.
2. Each month's bill should include a total to date. That total should provide, at a glance, the total fees and costs incurred to date for the project.
3. A copy of memoranda, letters, reports, calculations and other documentation prepared by CONSULTANT may be required to be submitted to CITY to demonstrate progress toward completion of tasks. In the event CITY rejects or has comments on any such product, CITY shall identify specific requirements for satisfactory completion.
4. CONSULTANT shall submit to CITY an invoice for each monthly payment due. Such invoice shall:
  - A) Reference this Agreement;
  - B) Describe the services performed;
  - C) Show the total amount of the payment due;
  - D) Include a certification by a principal member of CONSULTANT's firm that the work has been performed in accordance with the provisions of this Agreement; and
  - E) For all payments include an estimate of the percentage of work completed.

Upon submission of any such invoice, if CITY is satisfied that CONSULTANT is making satisfactory progress toward completion of tasks in accordance with this Agreement, CITY shall approve the invoice, in which event payment shall be made within thirty (30) days of receipt of the invoice by CITY. Such approval shall not be unreasonably withheld. If CITY does not approve an invoice, CITY shall notify CONSULTANT in writing of the reasons for non-approval and the schedule of performance set forth in **Exhibit "A"** may at the option of CITY be suspended until the parties agree that past performance by CONSULTANT is in, or has been brought into compliance, or until this Agreement has expired or is terminated as provided herein.



5. Any billings for extra work or additional services authorized in advance and in writing by CITY shall be invoiced separately to CITY. Such invoice shall contain all of the information required above, and in addition shall list the hours expended and hourly rate charged for such time. Such invoices shall be approved by CITY if the work performed is in accordance with the extra work or additional services requested, and if CITY is satisfied that the statement of hours worked and costs incurred is accurate. Such approval shall not be unreasonably withheld. Any dispute between the parties concerning payment of such an invoice shall be treated as separate and apart from the ongoing performance of the remainder of this Agreement.

# EXHIBIT B

## FEE PROPOSAL

### HOURLY RATES SCHEDULE

Principals	\$220/hr
Director of Design	\$200/hr
Senior Landscape Architects	\$175/hr
Director of GIS	\$165/hr
Licensed Professional	\$155/hr
Building Designer	\$150/hr
Project Manager	\$140/hr
Project Designer/ CADD Technicians	\$120/hr
Administration	\$110/hr

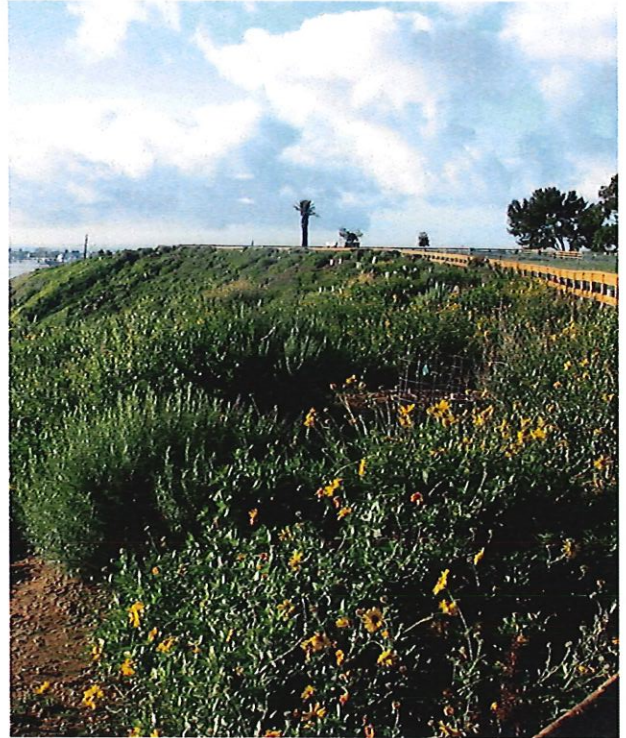

#### REIMBURSABLES

Printing, copying, and sub-consultant expenses will be billed at cost plus fifteen percent.

#### REIMBURSABLES - IN HOUSE PRINTING

Project Name: \_\_\_\_\_

Client: \_\_\_\_\_

Date	Number of Sheets										
	Bond (B/W)		Bond (Color)		Letter		11x17		Photo (Color)		
	24x36	30x42	24x36	30x42	B/W	Color	B/W	Color	24x36	24x60	30x42
Description											
Description											
ADMIN USE ONLY											
Total Sheets											
x Unit Price	\$ 4.50	\$ 6.00	\$ 10.00	\$ 15.00	\$ 0.15	\$ 1.50	\$ 0.55	\$ 2.75	\$ 15.00	\$ 18.50	\$ 22.00
Total											
Subtotal =	15% M/U =				Total to be billed: \$						





## CERTIFICATE OF LIABILITY INSURANCE

DATE (MM/DD/YYYY)

06/16/2025

THIS CERTIFICATE IS ISSUED AS A MATTER OF INFORMATION ONLY AND CONFERS NO RIGHTS UPON THE CERTIFICATE HOLDER. THIS CERTIFICATE DOES NOT AFFIRMATIVELY OR NEGATIVELY AMEND, EXTEND OR ALTER THE COVERAGE AFFORDED BY THE POLICIES BELOW. THIS CERTIFICATE OF INSURANCE DOES NOT CONSTITUTE A CONTRACT BETWEEN THE ISSUING INSURER(S), AUTHORIZED REPRESENTATIVE OR PRODUCER, AND THE CERTIFICATE HOLDER.

IMPORTANT: If the certificate holder is an ADDITIONAL INSURED, the policy(ies) must have ADDITIONAL INSURED provisions or be endorsed. If SUBROGATION IS WAIVED, subject to the terms and conditions of the policy, certain policies may require an endorsement. A statement on this certificate does not confer rights to the certificate holder in lieu of such endorsement(s).

PRODUCER Cornerstone Specialty Insurance Services, Inc. 14252 Culver Drive, A299  Irvine CA 92604	CONTACT NAME: Tina Cowie PHONE (A/C, No, Ext): (714) 731-7700 FAX (A/C, No): (714) 731-7750 E-MAIL ADDRESS: tina@cornerstonespecialty.com
INSURED DAVID VOLZ DESIGN LANDSCAPE ARCHITECTURE, INC.  151 Kalmus Drive, Ste. M-8 Costa Mesa CA 92626	INSURER(S) AFFORDING COVERAGE INSURER A: RLI Insurance Company NAIC # 13056 INSURER B: Travelers Casualty & Surety Co. of America 31194 INSURER C: INSURER D: INSURER E: INSURER F:

## COVERAGES

CERTIFICATE NUMBER: 25/26 COVERAGES

REVISION NUMBER:

THIS IS TO CERTIFY THAT THE POLICIES OF INSURANCE LISTED BELOW HAVE BEEN ISSUED TO THE INSURED NAMED ABOVE FOR THE POLICY PERIOD INDICATED. NOTWITHSTANDING ANY REQUIREMENT, TERM OR CONDITION OF ANY CONTRACT OR OTHER DOCUMENT WITH RESPECT TO WHICH THIS CERTIFICATE MAY BE ISSUED OR MAY PERTAIN, THE INSURANCE AFFORDED BY THE POLICIES DESCRIBED HEREIN IS SUBJECT TO ALL THE TERMS, EXCLUSIONS AND CONDITIONS OF SUCH POLICIES. LIMITS SHOWN MAY HAVE BEEN REDUCED BY PAID CLAIMS.

INSR LTR	TYPE OF INSURANCE	ADD'L INSD	SUBR VWR	POLICY NUMBER	POLICY EFF (MM/DD/YYYY)	POLICY EXP (MM/DD/YYYY)	LIMITS
A	<input checked="" type="checkbox"/> COMMERCIAL GENERAL LIABILITY <input type="checkbox"/> CLAIMS-MADE <input checked="" type="checkbox"/> OCCUR <input type="checkbox"/> ADD'L INSURED/P & NC <input checked="" type="checkbox"/> BLANKET WVR OF SUBRO GEN'L AGGREGATE LIMIT APPLIES PER: <input type="checkbox"/> POLICY <input checked="" type="checkbox"/> PRO-JECT <input type="checkbox"/> LOC OTHER:			PSB0001408	03/14/2025	03/14/2026	EACH OCCURRENCE \$ 2,000,000 DAMAGE TO RENTED PREMISES (Ea occurrence) \$ 1,000,000 MED EXP (Any one person) \$ 10,000 PERSONAL & ADV INJURY \$ INCLUDED GENERAL AGGREGATE \$ 4,000,000 PRODUCTS - COM/OP AGG \$ 4,000,000
A	AUTOMOBILE LIABILITY <input type="checkbox"/> ANY AUTO <input type="checkbox"/> OWNED AUTOS ONLY <input type="checkbox"/> SCHEDULED AUTOS <input checked="" type="checkbox"/> HIRED AUTOS ONLY <input checked="" type="checkbox"/> NON-OWNED AUTOS ONLY			PSB0001408	03/14/2025	03/14/2026	COMBINED SINGLE LIMIT (Ea accident) \$ 2,000,000 BODILY INJURY (Per person) \$ BODILY INJURY (Per accident) \$ PROPERTY DAMAGE (Per accident) \$
	UMBRELLA LIAB <input type="checkbox"/> OCCUR EXCESS LIAB <input type="checkbox"/> CLAIMS-MADE DED <input type="checkbox"/> RETENTION \$						EACH OCCURRENCE \$ AGGREGATE \$
A	WORKERS COMPENSATION AND EMPLOYERS' LIABILITY ANY PROPRIETOR/PARTNER/EXECUTIVE OFFICER/MEMBER EXCLUDED? (Mandatory in NH) If yes, describe under DESCRIPTION OF OPERATIONS below	Y/N Y	N/A	PSW0001346	03/14/2025	03/14/2026	<input checked="" type="checkbox"/> PER STATUTE <input type="checkbox"/> OTH-ER E.L. EACH ACCIDENT \$ 1,000,000 E.L. DISEASE - EA EMPLOYEE \$ 1,000,000 E.L. DISEASE - POLICY LIMIT \$ 1,000,000
B	Professional Liability Claims Made			108013639	03/14/2025	03/14/2026	Each Claim \$2,000,000 Annual Aggregate \$2,000,000

DESCRIPTION OF OPERATIONS / LOCATIONS / VEHICLES (ACORD 101, Additional Remarks Schedule, may be attached if more space is required)

City of Huntington Beach, its officers, elected or appointed officials, employees, agents and volunteers are Additional Insured for General Liability but only if required by written contract with the Named Insured prior to an occurrence and as per attached endorsement. Coverage is provided on a non-admitted basis. Conditions, \*30 days notice of cancellation, except for 10 days notice for non-payment of premium. For Professional Liability coverage, the aggregate limit is the total insurance available for all covered claims reported within the policy period.

By:

MICHAEL J. VIGLIOTTA

CITY ATTORNEY

CITY OF HUNTINGTON BEACH

## CERTIFICATE HOLDER

## CANCELLATION

City of Huntington Beach 2000 Main St.  Huntington Beach CA 92648	SHOULD ANY OF THE ABOVE DESCRIBED POLICIES BE CANCELLED BEFORE THE EXPIRATION DATE THEREOF, NOTICE WILL BE DELIVERED IN ACCORDANCE WITH THE POLICY PROVISIONS.  AUTHORIZED REPRESENTATIVE 
--	---

© 1988-2015 ACORD CORPORATION. All rights reserved.

THIS ENDORSEMENT CHANGES THE POLICY. PLEASE READ IT CAREFULLY.

## **RLIPack® FOR PROFESSIONALS BLANKET ADDITIONAL INSURED ENDORSEMENT**

This endorsement modifies insurance provided under the following:

### **BUSINESSOWNERS COVERAGE FORM - SECTION II – LIABILITY**

1. **C. WHO IS AN INSURED** is amended to include as an additional insured any person or organization that you agree in a contract or agreement requiring insurance to include as an additional insured on this policy, but only with respect to liability for "bodily injury", "property damage" or "personal and advertising injury" caused in whole or in part by you or those acting on your behalf:

- a. In the performance of your ongoing operations;
- b. In connection with premises owned by or rented to you; or
- c. In connection with "your work" and included within the "product-completed operations hazard".

2. The insurance provided to the additional insured by this endorsement is limited as follows:

- a. This insurance does not apply on any basis to any person or organization for which coverage as an additional insured specifically is added by another endorsement to this policy.
- b. This insurance does not apply to the rendering of or failure to render any "professional services".
- c. This endorsement does not increase any of the limits of insurance stated in D. Liability And Medical Expenses Limits of Insurance.

3. The following is added to **SECTION III H.2. Other Insurance – COMMON POLICY CONDITIONS (BUT APPLICABLE ONLY TO SECTION II – LIABILITY)**

However, if you specifically agree in a contract or agreement that the insurance provided to an

additional insured under this policy must apply on a primary basis, or a primary and non-contributory basis, this insurance is primary to other insurance that is available to such additional insured which covers such additional insured as a named insured, and we will not share with that other insurance, provided that:

- a. The "bodily injury" or "property damage" for which coverage is sought occurs after you have entered into that contract or agreement; or
- b. The "personal and advertising injury" for which coverage is sought arises out of an offense committed after you have entered into that contract or agreement.

4. The following is added to **SECTION III K. 2. Transfer of Rights of Recovery Against Others to Us – COMMON POLICY CONDITIONS (BUT APPLICABLE TO ONLY TO SECTION II – LIABILITY)**

We waive any rights of recovery we may have against any person or organization because of payments we make for "bodily injury", "property damage" or "personal and advertising injury" arising out of "your work" performed by you, or on your behalf, under a contract or agreement with that person or organization. We waive these rights only where you have agreed to do so as part of a contract or agreement with such person or organization entered into by you before the "bodily injury" or "property damage" occurs, or the "personal and advertising injury" offense is committed.

ALL OTHER TERMS AND CONDITIONS OF THIS POLICY REMAIN UNCHANGED.



## WAIVER OF OUR RIGHT TO RECOVER FROM OTHERS ENDORSEMENT-CALIFORNIA

We have the right to recover our payments from anyone liable for an injury covered by this policy. We will not enforce our right against the person or organization named in the Schedule. (This agreement applies only to the extent that you perform work under a written contract that requires you to obtain this agreement from us.)

You must maintain payroll records accurately segregating the remuneration of your employees while engaged in the work described in the Schedule.

The additional premium for this endorsement shall be \_\_\_\_\_% of the California workers' compensation premium otherwise due on such remuneration.

## Schedule

**Person or Organization**

All persons or organizations that are party to a contract that requires you to obtain this agreement, provided you executed the contract before a loss

**Job Description**

Job performed for any person or organization that you have agreed with in a written contract to provide this agreement.

This endorsement changes the policy to which it is attached and is effective on the date issued unless otherwise stated.

(The information below is required only when this endorsement is issued subsequent to preparation of the policy.)

Endorsement Effective 03-14-2025

Policy No. PSW0001346

Endorsement No. 1

Insured David Volz Design Landscape Architects, Inc.  
Insurance Company RLI Insurance Company